

<u>REAL PROPERTY</u>										
Greater Vancouver		Rural (except V.L.A.)			V.L.A. (except Mission Village)		V.L.A. Mission Village		Total	
Sale Price	5% thereof & 12.50	Sale Price	10% thereof	Charges 12.50 & Comm.	Sale Price	Total Award 80% of all Sale Prices		Sale Price	Total Award 125% of all Sale Prices:	
						% of Total	Amount		% of Total	Amount
					221.00		176.53			176.53
<u>PERSONAL PROPERTY</u>										
Motor Vehicles			Boats and Boat Gear							
Sale Price	25% thereof	Sale Price	Nelson Bros. 23.5% of Sale Price	Other Sales 28.5% of Sale Price	Equipment charges paid to purchasers in error. Repay to owners	Amount of Claims for Boat Gear Declared & Recorded Now Missing	45% of amount in next preceding column			
<u>NETS</u>										
Total award for Nets plus Sale Price		Total Claim for Nets Sold, Declared Not Found and Recorded Now Missing			Percentage Total Award to Total Claim		Claim for Nets Sold Declared Not Found, & Recorded Now Missing		Apply % ratio to Claim	Deduct Custodian Sale Price
<u>MISCELLANEOUS CHATTELS</u>										
Claim for goods Sold By Auction	Sale Price of Goods Sold By Auction	Rebates of charges 30% of Sale Price	Ratio in % of Sale Price to Claim	Claim for goods Declared Not Found, Recorded Now Missing, & Sold Not Paid	Applica-tion of % ratio to amount in next preceding column	Sale Price of goods Sold by Tender	12% of Sale Price			
			46%	359.45	165.34	2.50		.30		165.64
TOTAL RECOMMENDATION										342.17

CASE NO: 621.

JAPANESE PROPERTY CLAIMS COMMISSION

Lethbridge, Alberta,
August 27th, 1948.

IN THE MATTER OF THE CLAIM OF
TAKEO KIMURA.

PROCEEDINGS AT HEARING.

Original.

IN THE MATTER OF THE "INQUIRIES ACT"
PART 1, REVISED STATUTES OF CANADA 1927, CHAPTER 99.

JAPANESE PROPERTY CLAIMS COMMISSION

B E F O R E

(HIS HONOUR JUDGE L.H. STACK, SUB-COMMISSIONER).

10

Lethbridge, Alberta,
 August 27th, 1948.

IN THE MATTER OF THE CLAIM OF
TAKEO KIMURA.

PROCEEDINGS AT HEARING.

20 APPEARANCES:

G.E.A. RICE, Esq., K.C.,	appearing for the Dominion Government.
L.S. TURCOTTE, Esq.,	appearing for the Claimant.
—	
MIS LILLIE THOMAS,	Secretary.
D.J. HANDFORD, Esq.,	Official Interpreter.
S.R. HOWARD, Esq.,	Official Reporter.

30

T. Kimura,
In Chief.

THE SECRETARY: Case No. 621, Takeo Kimura.

TAKEO KIMURA, the claimant herein,
being first duly sworn, testified
through the Interpreter as
follows:

DIRECT EXAMINATION BY MR. TURCOTTE:

Q Mr. Kimura, you are making a claim for loss arising out of the sale of your farm property, or your small acreage with buildings on it, by the Custodian?

10 A Yes.

Q And I am showing you a statement setting out the description of your property, and the buildings and of the value that you placed on them?

A Yes.

Q Is that statement correct to the best of your information and memory?

A Yes.

MR. TURCOTTE: I will tender that, your Honour, as
20 Exhibit 1.

(STATEMENT MARKED EXHIBIT NO. 1).

MR. TURCOTTE: Q: When did you buy this property, Mr. Kimura? You were evacuated in 1942?

A Yes.

Q How long did you have it before that?

A In 1940.

Q In 1940?

A: Yes.

Q How much did you pay for it? Whom did you buy it from?

A: I bought it

30 in conjunction with a Mr. Cameron, Earl Cameron.

T. Kimura,
In Chief.

- Q Earl Cameron? A: Yes.
- Q How much did you pay?
- A \$30.00 a lot, four lots.
- Q That would be \$120.00?
- A Yes.
- Q And was there anything on the property?
- A There was nothing, just bush.
- Q Just bush? A: Yes.
- Q And what did you do between 1940 and 1942 on
10 the property?
- A I cleared it and built a house on it.
- Q You built a house? A: Yes.
- Q Did you build anything else on it?
- A Yes, a woodshed, and a chicken house and a washroom.
- Q I see. What about water?
- A Yes, I dug a well.
- Q Dug a well? A: Yes.
- Q I see. And now this house that you built, how many
rooms did it have?
- 20 A Four rooms.
- Q Four rooms? A: Yes.
- Q I notice in my form that I filed, I say that the
house had four rooms as shown in sketch, and I
haven't put on any sketch. I have it here, but I
haven't put it on the exhibit filed.
- A I have a photograph of the house when it was just
completed, almost completed, but the road is not
built, and I had~~x~~ only just moved in there.
- Q This is a photograph of the house that you built?
- 30 A Yes.

T. Kimura,
In Chief.

MR. TURCOTTE: I present that, your Honour, as an exhibit.

(PHOTOGRAPH MARKED EXHIBIT NO. 2).

MR. TURCOTTE: Q: Now were there any doors inside of the house? A: Yes, there were two doors.

Q Now you say that there were four rooms? Were they proper rooms with partitions up to the ceiling? A: Yes.

10 Q The only reason I am asking you that is, Mr. Kimura, that on the appraisal by the, it looks like the Soldiers Settlement or Veterans Land Act, by a Mr. Barnet, he says that only one room was partitioned off for occupation; that is, he says there was only one room in the house cut off from the rest of the house.

A All four rooms were partitioned off.

Q Now there is another thing that Mr. Barnet, who made this appraisal for the Commission, says
20 that this house was five years old and the hen-house and shed were five years old.

A No, I bought the land in 1940 and built on it afterwards so that it couldn't be.

Q It couldn't be five years old?

AA No, it couldn't be five years old.

Q Now did you receive any offers of purchase for this property before you left the Coast?

A Yes, before I had completed building the house, I was offered \$700.00.

30 Q For the property? A: Yes.

T. Kimura,
In Chief.

Q Have you any personal knowledge or of your own knowledge of some land being sold in that neighbourhood about that time between 1940 and 1942? A: Just across from my brother, a half acre was sold about that time for \$250.00.

Q A half acre? A: Yes, half acre lots.

Q And how large a place did you have?

10 A A little less than one acre because there was a road through it.

Q I see. Now this photograph, Exhibit 2, did you do any work to the outside of the house after the picture was taken?

A Yes, the ends of the boards were all trimmed and tarpaper was fixed on the outside.

Q Tarpaper? A: Yes.

Q Well what did you intend to do? Was there anything else to go on the outside before you finished the house? 20

A Yes, it was my intention to build a porch and also build siding over the tarpaper.

Q That is, you intended to finish it with siding, is that right? A: Yes.

Q I mean, that looks to me as if it is just the first board on the outside; is that right?

A Yes, the house wasn't quite complete.

Q What were you going to do with this property? What were you going to use it for besides living in? Were you going to make your living off it in 30

T. Kimura,
In Chief.

any way or what?

A Yes, it was my intention to start a chicken farm to make my living out of it.

Q Now do you remember what the house cost you up to the time that you were evacuated?

A About \$800.00.

Q About \$800.00? A: Yes.

Q Now you are also claiming for the loss of some chattels, that is the household goods and your kitchenware?

10

MR. RICE: Excuse me, I think his wife is claiming that.

MR. TURCOTTE: Well he has signed the form.

MR. RICE: And she signed the declaration.

MR. TURCOTTE: Well I will ask that she be added as a claimant then.

THE SUB-COMMISSIONER: All right.

MR. TURCOTTE: Q: I am showing you a statement of your chattels (indicating).

20 A Yes.

Q Is that correct to the best of your memory and belief? A: Yes.

MR. TURCOTTE: I put that in as Exhibit 3, your Honour.
(STATEMENT MARKED EXHIBIT NO. 3).

MR. TURCOTTE: And I will ask my learned friend to file the analysis of personal property claim. There is a little mix-up in this matter of the chattels between this claimant and Shigeichi Shigehiro.

30

(ANALYSIS MARKED EXHIBIT NO. 4).

T. Kimura,
In Chief.

MR. TURCOTTE: Q Now in this claim you are asking for payment for two dressers and you are asking for \$70.00? A: Yes.

Q Did you buy those dressers?

A No, those were made.

Q Who made them? A: I did.

Q How do you arrive at the claim for \$70.00?

A I used good wood and had to order it and pay the freight, so that it is the cost of the material plus the freight charges, but it does not include my own labour.

Q Well are you telling us then that the material in these two dressers cost \$70.00?

A The material and freight charges.

Q I see. When did you build these dressers?

A About a year before I built the house.

Q About a year before you built the house?

A Yes.

Q Well you built the house in 1941, so that would be in 1940, is that right?

A About that time.

Q Now you are claiming \$75.00 for beds, two double beds. How did you arrive at that figure?

MR. RICE: You don't say they are double.

MR. TURCOTTE: You show them as double in your analysis.

MR. RICE: In your claim, though.

A That is the amount that I paid for them plus the freight charges.

MR. TURCOTTE: Q: I see. Well, were they both boughten beds? Did you buy both of them, or did

T. Kimura,
In Chief.

you make some of them?

A One was purchased and one was home made.

Q One was made? A: Yes.

Q Now you have got a claim for silverware,
\$9.50. What does that refer to?

A Knives, forks and spoons.

Q That does not refer to silver trophy cups?

A That is my brother-in-law's, Shigerhiro.

Q But I mean your claim has nothing to do with silver
10 trophy cups? A: No.

Q Now then you are also claiming for toys, \$15.65?

A Yes.

Q And there is a notation on the analysis filed by
the Custodian that they were shipped. Were those
shipped to you?

A No, I didn't receive them.

Q Well did your wife receive them?

A No.

Q Well now did she get the stove?

20 A Yes.

Q The kitchen table? A: No.

Q The baby buggy? A: No.

Q The sewing machine? A: Yes.

Q She got the sewing machine?

A Yes.

Q The shrines, two shrines?

MR. RICE: Buddhist shrines.

A No.

MR. TURCOTTE: Q: Two sleighs?

30 A No.

T. Kimura,
In Chief.

Q And a child's go-cart?

A I didn't receive anything except the stove and the sewing machine.

Q What about the box of carpenter's tools?

A No.

Q Now you are claiming \$26.90 for pots and pans, \$52.00 for dishes, and \$35.00 for kitchen utensils, also \$4.50 for a toaster. How did you arrive at those figures? That is, the pots, pans, dishes, toaster and kitchen utensils?

10

A I think these were the prices for which they were purchased and which my wife made out at the time I went to camp.

Q The prices your wife made out at the time that you went to the camp?

A Yes.

Q Is that the time of e vacation?

A Yes.

Q How old were all these articles?

20 A My wife returned to Japan a year before we entered the house and they were bought since she returned from Japan.

Q She returned? A: She returned to Japan one year before we moved into the house.

Q All right; when did she come back?

A In 1939.

Q She came back in 1939? A: Yes.

Q And all of these articles were bought after that?

A Yes.

30 Q I see. All right. mIt is noted, your Honour,

T. Kimura,
In Chief.

on the analysis of personal property claim that whatever chattels were left were destroyed by fire early in 1944, so that apparently there is no salvage here with the exception of \$10.00.

THE SUB-COMMISSIONER: Yes.

MR. TURCOTTE: That is all.

MR. RICE: I am submitting, your Honour, that the real estate was sold for its fair market value.

10 I am submitting that the chattels sold and disposed of by the Custodian were sold for their fair market value.

I am submitting that other articles claimed for by the claimant were shipped or returned to the claimant and that articles that the claimant is claiming for of which there is no record of at any time, the Custodian is not responsible for, and I further say that any articles that the Custodian may be responsible for the claim for the same is exorbitant.

20 I wish to submit as an exhibit, your Honour, a farm appraisal report respecting the land.

(APPRAISAL REPORT MARKED EXHIBIT NO. 5).

MR. RICE: I further wish to submit a real property memorandum and a real property summary respecting the assessment, valuation and sale.

(DOCUMENTS MARKED EXHIBIT NO. 6).

THE SUB-COMMISSIONER: A real property memorandum and a summary?

MR. RICE: Yes, your Honour.

T. Kimura,
Cross-Exam.

CROSS-EXAMINATION BY MR. RICE:

- Q You had not cleared the stumps off this property before you left, had you?
- A Some of them in front of the house.
- Q Just a very small portion was cleared, was it not?
- A Yes, enough for the garden.
- Q Pardon? A: Enough for the garden only.
- Q Enough for the garden only?
- 10 A Yes.
- Q In this house that you built did you use second-hand lumber to build it?
- A No, it was new.
- Q What about the out buildings? Were they second-hand lumber? A: It was new, rough lumber.
- Q New, rough lumber?
- A Yes.
- Q Were any of the out buildings purchased and moved onto the place? A: No, they were all made from lumber.
- 20 Q All built by yourself there?
- A They were all built for me. I didn't turn it over myself.
- Q Built for you with new lumber?
- A Yes.
- Q Were they painted? A: No.
- Q Who did you pay \$250.00 to for labour?
- A To the people that did the work, the carpenter,
- 30 I don't know his name.

- Q The people that did the building?
- A Yes.
- Q Is \$250.00 all you paid out for labour?
- A As far as I remember, yes.
- Q Have you got a record of it? Was it exactly \$250.00, or are you guessing?
- A No, I have nothing written down.
- Q Then you are guessing at the amount that you paid?
- A No, I paid it in small amounts.
- 10 Q How do you know it is \$250.00 if you have nothing written down?
- A I paid it in small amounts from my earnings so the amount is approximate.
- Q The amount is approximate?
- A Yes.
- Q I said before that you were just guessing at the amount; is that not correct?
- A Well that is the amount I think that I paid.
- Q It has taken five minutes or more to get the answer. The garden work you did yourself, did you not; the part that you cleared for the garden?
- 20 A Yes, I did that myself.
- Q So this statement here that you have for clearing bush, you paid nothing?
- A I employed outside help to fell the trees.
- Q How much did you pay for that?
- A I don't remember.
- Q You don't remember? A: No.
- Q No idea what it was?
- 30 A No, I don't remember.

T. Kimura,
Cross-Exam.

- Q You turned your chattels over to Mr. Sloan to look after, did you not, or your wife's chattels, at least?
- A: No, I didn't turn them over to him. Did the Custodian?
- Q I have a statement here of chattels on the foot of which it says, "The above listed articles have been left in my care by the owner and I will be responsible for their safekeeping", and it is signed "J.B. Sloan". Do you know anything about that?
- 10 The statement is dated, or is it dated; yes, it is dated August 8th, 1942. Can't he answer that or won't he?
- A What is the question?
- Q I asked him if he knows anything about it.
- A Pardon?
- Q I asked him if he knows anything about that, that Sloan signed the statement that he was taking care of the chattels for him?
- A No, I don't know anything about it. The Custodian
- 20 did it.
- Q You don't know anything about it. I see. Who shipped your sewing machine to you?
- A I applied to the Security Commission and they applied to the Custodian.
- Q Who shipped the kitchen range to you?
- A That was shipped to me from the Custodian through the Security Commission.
- Q Well the baby carriage, who shipped that?
- A I don't know anything about that. Possibly my
- 30 youngest sister.

T. Kimura,
Cross-Exam.

MR. TURCOTTE: The answer is that his youngest sister shipped it to him?

A No, that was a mistake. What I meant was that the baby buggy was possibly my sister's. I never owned one.

MR. RICE: Q: The baby buggy wasn't yours?

A No.

Q You filed no claim for it, anyhow.

MR. TURCOTTE: What is the argument about then?

10 MR. RICE: Q: You say that two sleighs were not shipped to you? A: No, I didn't ask for them.

Q Why is it that you have not claimed for them?

A I think it is in the claim, isn't it?

Q If it is, I don't see it. Just what is your claim? Is it \$127.90?

MR. TURCOTTE: No, the claim is \$384.40.

MR. RICE: Well it was filed for \$384.45.

MR. TURCOTTE: Yes, that is it.

20 A I haven't listed all the articles there.

MR. TURCOTTE: All the articles are not listed in the personal chattels form.

MR. RICE: Well what about the money that they got? Was that taken off?

MR. TURCOTTE: Perhaps you could ask him whether he got any money or if you have any statement that he had any money.

MR. RICE: We have our own records on that. We filed the analysis of what property was sold, and we are standing by it.

30

T. Kimura,
Cross-Exam.

Q Now these dressers, you say that you made them yourself?

A: Yes.

Q And you bought the material?

A Yes.

Q What kind of wood was it?

A Yellow cedar.

Q Yellow cedar?

A: Yes.

Q And where did you buy the wood?

A Brownsville Lumber Company.

10 Q How much did you pay for freight?

A It was brought by truck and cost about \$3.50 or somewhere around there.

Q Have you got a record of what you paid for the lumber and what you paid for freight?

A No, they didn't give me a receipt.

Q And you are just guessing at the amount, are you?

A Yes, I purchased it and I paid out the money but I have no receipts.

Q And you are guessing at the amount?

20 A You can say that I am guessing.

Q Well that would bring that yellow cedar at \$66.50 a thousand according to you.

MR. TURCOTTE: Did he say there was a thousand feet in there?

MR. RICE: No, I am wrong in that. The lumber would cost \$66.50.

A This amount does not only include the lumber; it includes the other material, nails and everything else.

30 Q And what else?

A: Varnish and

paint.

Q A paint brush, I suppose?

A Drawers and hardware.

Q Do you know how much you paid for the hardware, or was that all a guess, and how much you paid for the varnish and the paint?

A I haven't any accurate recollection of all the details.

10 Q I guess not. When did you turn the dressers over to your wife?

MR. TURCOTTE: Well, your Honour, the wife filed claim.

MR. RICE: It is all right. He said that he built them. I am asking him when he turned them over to her. They are her dressers. Let us find out about them.

MR. TURCOTTE: Oh, we are wasting time about it.

MR. RICE: I don't think we are wasting time over it.

MR. TURCOTTE: It is either hers or his.

20 MR. RICE: He filed a claim for them, and I am asking him when he filed the claim.

MR. TURCOTTE: Oh, well.

A We were living together there. I don't understand the question.

MR. RICE: I am asking you the question when you turned these dressers over to your wife, or did you turn them over to her?

A No, we were using them together. I did not turn them over to her.

30 Q I see. That is all right. Now how much did you

T. Kimura,
Cross-Exam.

pay for the bed that you bought?

A About \$45.00, over \$40.00.

Q What kind of a bed was it?

A Four feet by six feet.

Q Steel bed? A: Yes.

Q What kind? Steel? A: Coil
spring and round tubing.

Q And the one that you built, was that built out of
yellow cedar?

10 A Yes, it was partly yellow cedar, partly fir.

Q Was a toy train ever shipped to you?

A No, I didn't request it to be sent and I didn't
receive it.

MR. RICE: I am going to request, your Honour, that
this statement of Mr. Sloan's be marked for
identification. It is dated August 8th, 1942, and
it contains an inventory. I had better have the
inventory identified by the witness, I guess.

20 Q Will you refer to the inventory and ask him if it
is an inventory of his goods and chattels or the
goods and chattels of his wife?

MR. TURCOTTE: Will you just translate each item in
the inventory to him so that he will know what he
is saying.

A There was a keg with about 40 pounds of nails that
is not included here, and about 20 pounds of
shingle nails, also about 200 feet of V-joint for
repair work.

30 MR. RICE: Q: With those exceptions, that is the list
of his chattels or the chattels of his wife?

T. Kimura,
Cross-Exam.

A Yes.

MR. RICE: I would like that marked, your Honour. I think it should go in as an exhibit. He has identified the list.

THE SUB-COMMISSIONER: Exhibit "A".

MR. RICE: I think it should go in as an exhibit. It is a list of the chattels, your Honour.

THE SUB-COMMISSIONER: Have you any objection to having it marked as an exhibit, Mr. Turcotte?

10 MR. TURCOTTE: The only thing is he is not admitting Sloan is his agent, so I think it should go in just for identification.

THE SUB-COMMISSIONER: Mark it Exhibit "A" for identification.

MR. TURCOTTE: There are a lot of notations on here that certain things were shipped.

MR. RICE: Yes, there is that about it.

(INVENTORY MARKED EXHIBIT "A" FOR IDENTIFICATION).

MR. RICE: Q: Did you or your wife ever receive letters
20 from the Custodian's office asking you about a list of chattels?

A Yes, I received a letter saying that the Custodian was to take out insurance and to please sign and return some documents.

Q And you never answered his letter?

A No.

Q And the Custodian apparently wrote your wife on
the 14th of August, the 14th of October, and the
30 20th of November, respecting a list of your

T. Kimura,
Cross-Exam.
Re-Direct Exam.

chattels. Did you ever reply to that letter, or did your wife ever reply to any of those letters? Those letters were all in the year 1942.

THE INTERPRETER: What date were those letters?

BY THE REPORTER: "14th of August, 14th of October, and the 20th of November".

A About that time I was away working and my wife doesn't read English, so that I don't know what happened.

10 Q I see. That is all.

RE-DIRECT EXAMINATION BY MR. TURCOTTE:

Q Mr. Kimura, how many beds did you have?

A Three.

Q Why have you only claimed for two?

A One was old so that I did not claim it.

Q Well this bed that you made, did it have springs and mattresses?

20 A: Yes, it had steel springs. I made the frame of wood and the steel springs were rested on the frame.

Q Well did you buy those?

A Yes.

Q I mean, actually all you did was made the frame of the bed and buy the springs?

A Yes.

Q And did you have a mattress on it?

A Yes.

MR. TURCOTTE: I think I will file this letter received from the Custodian setting out the list of chattels.

30

T. Kimura,
Re-Direct Exam.

THE SUB-COMMISSIONER: Exhibit 7.

MR. RICE: What date?

MR. TURCOTTE: The 14th of August, 1942, the first
letter.

MR. RICE: Oh yes.

(LETTER & INVENTORY MARKED EXHIBIT NO. 7).

MR. TURCOTTE: Q: Now, Mr. Kimura, you gave me some
information which I have put down here, and which
you said was correct, and in reference to the cost
10 of the dwelling you say that the dwelling cost you
\$800.00, and that you paid \$450.00 for labour
in building the dwelling. Now, Mr. Rice asked
you whether \$250.00 was all that you had paid for
labour on the dwelling.

THE SUB-COMMISSIONER: Was he not referring to the
labour in regard to clearing the land?

MR. TURCOTTE: Well I think you took that, your Honour.

THE SUB-COMMISSIONER: Yes, I did.

MR. TURCOTTE: But that is not the way that he framed
20 his question. He said the whole thing, and so
I want to clear that up.

MR. RICE: He never paid \$450.00 for building a shack
like that, your Honour.

A At the time my wife was paying small amounts and
this \$450.00 includes transportation and handling
of the lumber; everything is included in here.

MR. TURCOTTE: Q: I noted that on here and is that
correct? A: Yes.

Q Now when you were talking about \$250.00 to Mr.
30 Rice, you said that was all you had paid in labour

for building the house. Now what I want to know is which is correct; what you are telling us now or what you told Mr. Rice?

THE SUB-COMMISSIONER: Is his wife here?

MR. TURCOTTE: Q: Is your wife here, Mr. Kimura?

A No, not here.

MR. RICE: She doesn't speak English, he says.

THE SUB-COMMISSIONER: Mr. Interpreter, get him to answer the question and finish it.

10 MR. TURCOTTE: Q: Now is that right, or is what you told Mr. Rice right? That is all I want to know.

MR. RICE: It was pretty clear what he told me.

A If you include all the labour, it is \$450.00, and that is correct.

MR. TURCOTTE: Q: All the labour? What do you mean by all the labour? All I am doing is talking about the house.

THE SUB-COMMISSIONER: Now, Mr. Interpreter, we cannot stay here all day getting an answer to one
20 question. Let him answer that.

A I misheard the question from Mr. Rice. I thought that he was speaking of the felling of the trees.

MR. TURCOTTE: Q: The felling of the trees?

A Yes.

THE SUB-COMMISSIONER: Well that is what I understood from him in answer to the question originally.

MR. TURCOTTE: That is fine.

THE SUB-COMMISSIONER: Is that all?

MR. RICE: Just a minute. I would like to get it
30 clear, too.

T. Kimura,
Re-Cross-Exam.

RE-CROSS EXAMINATION BY MR. RICE:

Q You have already said that \$450.00 would include everything that you paid out for labour?

A Yes, for labour.

Q And you have no record whatever of it?

THE SUB-COMMISSIONER: He has already said he hadn't any record of it.

MR. RICE: He doesn't know what he is talking about.

10 MR. TURCOTTE: That is all, thank you, Mr. Kimura.

(Witness aside)

(PROCEEDINGS ADJOURNED SINE DIE)

I hereby certify the foregoing to be a true and accurate transcript of the proceedings herein.

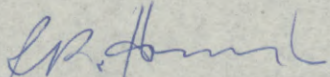
"S.R. HOWARD"
Official Reporter.

I hereby certify that the foregoing transcript purports to be an accurate record of the evidence adduced before me.

20

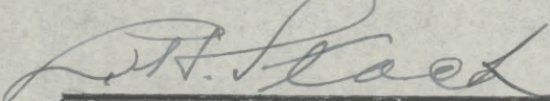
SUB-COMMISSIONER.

30

Case No. 621

IN THE MATTER OF a Commission to Investigate Claims of Japanese Canadians for Property Losses.

TO: The Commissioner,
Office of the Custodian,
Royal Bank Bldg.,
Vancouver, B.C.

NOV 20 1947
ACKNOWLEDGED

File No. 6916

[Signature]

[Signature]

Pursuant to the notice issued on the 26th day of September, 1947, I submit the following claim:

(1) NAME KIMURA (Print) Surname Given Name TAKEO (RCMP) Reg. No. 08076

(2) Pre-Evacuation Address P. O. South Westminster, B. C.

(3) Present Address P. O. Box 181, Coaldale, Alberta.

(4) REAL ESTATE

(a) Street Address (if any) _____
City or Municipality Surrey Province B. C.

(b) Legal description (lot number, block number, section number, etc.) Lots 5, 6, 11, 12 of
Lots 17 to 20 of Section 21, Block 5, North Range 2, West Map 2780

(c) Type of Real Property (cross out words which do not apply):

- (i) ~~Farm~~
- (ii) ~~Residence~~ Type of business _____
- (iii) ~~Business~~
- (iv) ~~Any other type of property (describe)~~

(d) What was your interest in the property (e.g., sole owner, life tenant, joint tenant, owner of one half or one third interest, leasehold, etc.)..... sole owner

(e) Fair market value at date of sale (estimate this to the best of your ability):

(i) Land	- - - - -	\$	<u>375.00</u>
(ii) Buildings	- - - - -	\$	<u>911.00</u>
(iii) If business, put value on business as going concern (including land and buildings, tenancies, chattels, fixtures, stock-in-trade, goodwill and accounts receivable)	- - - - -	\$	_____
(iv) Total value (if you cannot give separate values for lands and buildings just fill in total value)	- - - - -	\$	<u>1286.00</u>
(v) Amount at which Custodian sold property and credited your account	- - - - -	\$	<u>230.00</u>
(f) Loss (This figure is arrived at by deducting item (v) from item (iv)	- - - - -	\$	<u>1056.00</u>

(5) PERSONAL PROPERTY

(a) Place or places at which property was left by the claimant at date of evacuation _____

(b) Type of premises in which property left (e.g., house, warehouse, garage, shed, church basement, etc.)
in house
_____ house

(c) How stored or packed at time of evacuation
left loose in house

(over)

(d) In whose care was property left at date of evacuation by the claimant. (This question refers to the terms of reference which exclude claims where the property was lost, destroyed or stolen while under the custody, control or management of any person other than the Custodian appointed by the owner of the property. It involves some definite arrangement whereby you appointed someone to take care of the property and such person accepted the responsibility of so doing. Unless such an arrangement was made the question should be answered "in no one's care")

"in no one's care"

(e) Itemized description of personal property which is the subject of the claim:

- 1. see supplement attached Estimated Value \$ _____
- 2. _____ Estimated Value \$ _____
- 3. _____ Estimated Value \$ _____
- 4. _____ Estimated Value \$ _____
- 5. _____ Estimated Value \$ _____
- 6. _____ Estimated Value \$ _____
- 7. _____ Estimated Value \$ _____
- 8. _____ Estimated Value \$ _____
- 9. _____ Estimated Value \$ _____
- 10. _____ Estimated Value \$ _____

TOTAL CLAIM FOR PROPERTY LOSS \$ 384.45

N.B.—If you cannot list all the items here prepare a separate list with values set out opposite each item and attach it to the form. The item "personal property" includes shares, bonds, mortgages, loans, notes and all other forms of property not included in real estate.

(f) Total claim including real and personal property (this figure can be arrived at by adding items 4(f) and 5(e) - - - - - \$ 1440.45

- (6) (a) Place at which claimant prefers to be heard. (Vancouver, Kamloops, Nelson, Lethbridge, Moose Jaw, Winnipeg, Toronto or Montreal.)
- (b) Do you require the services of an interpreter at the hearing? Yes or no Yes

Lethbridge

N.B.—This Declaration must be sworn before a Commissioner, Notary Public or other person entitled to take declarations. All lawyers are qualified to do so.

DOMINION OF CANADA)
of)
TO WIT:)

I, Takao Kimura of the District
of Coaldale in the Province of Alberta

DO SOLEMNLY DECLARE THAT:

The information set out in the form above is true and correct to the best of my knowledge, information and belief and I make this solemn declaration conscientiously believing it to be true, and knowing that it is of the same force and effect as if made under oath, and by virtue of "The Canada Evidence Act".

DECLARED before me at the Village)
of Coaldale)
in the Province of Alberta)
this 17th day of November)
A.D. 1947.)

Takao Kimura
A Commissioner &c.

N.B.— THIS FORM FULLY COMPLETED AND SWORN BEFORE A COMMISSIONER SHOULD BE MAILED BY REGISTERED MAIL TO THE COMMISSIONER, c/o THE OFFICE OF THE CUSTODIAN, ROYAL BANK BLDG., VANCOUVER, B.C., BEFORE NOVEMBER 30th, 1947. IF YOU CANNOT MAIL IT BEFORE THIS DATE SET OUT BELOW REASONS FOR THE DELAY.

My Commission expires on December 31st 1947

S U P P L E M E N T

Takeo Kimura

C H A T T E L S

2	dressers		\$	70.00
2	tables			11.00
2	double beds			75.00
	clock			4.50
	pots and pans			26.90
	dishes			52.00
	toaster			4.50
	kitchen utensils			35.00
	cabinet			12.00
	carpenter tools			19.65
	lumber and nails			7.00
	picture frames			3.50
	toys			15.65
	saw			20.75
4½	cords of wood			17.50
	silverware			9.50
				<u> </u>
	TOTAL ESTIMATED VALUE OF CHATTELS		\$	<u>384.45</u>

TAKEO KIMURA

(Claimant's Name)

**REAL ESTATE
(Farm Land)**

08076

Reg. No.

LAND	Acres	Date of Purchase	From Whom	Cost Price	Cleared or cultivated at date of Purchase	Improvements at date of Purchase	Estimated value at Date of Sale
Uncleared Cultivated not planted Cultivated and not in crop List Crops	1	1940	M.D. Surrey and Earl Cameron	\$120.00	Uncleared	Nil	\$120.00

Strawberries 52 plants
Vegetables 1/8 acre

Total

IMPROVEMENTS SINCE PURCHASE OTHER THAN BUILDINGS (e.g. cultivation, plants, trees or special equipment)

Description	When Made	Cost						
Cleared - Cut trees - brush	1940	Don't remember cost but paid for all labor done					\$250.00	
Strawberries	1941	\$5.20						
BUILDINGS								
Type	Size	Finish	Date Built	Cost Material	Paid for Labour	Value of Own Labour	Allowance for Depreciation	Estimated Value
Dwelling	18x24		1940	\$350.00	\$450.00			\$800.00
Chicken House	10x14		1941	10.00	15.00			25.00
Wood shed	10x20		1941	15.00	15.00			30.00
Out house	4x8		1941	5.00	5.00			10.00
Bath House	8x10		1941	15.00	20.00			35.00
Well	6x14				75.00			75.00
								\$1345.00

My house had four rooms as shown in sketch. There were doors in two inside doorways.

EXHIBIT No. 621-1
DATE August 27/48
FILED BY R. S. Lurcotte

Comments re Appraiser's report not covered by above information:

Offered \$700.00 for property and house in 1941. Similar areas next to this sold for \$500.00 for land only. Lived there 1 yr. 9 months. Moved in Labour Day 1940. House was new.

T. Kimura
Signature

REAL ESTATE
(Farm Land)

(Amount: \$2000)

LAND	Location	Date of Purchase	From Whom	Cost	Improvements	Assessment	Value of Land
1		1940	M. J. BERRY				\$100.00

621

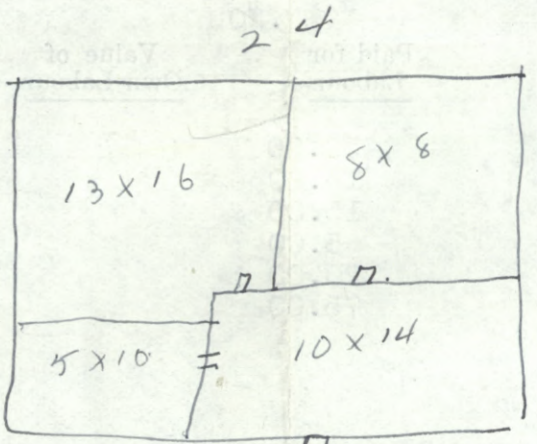

BUILDINGS	Type	Area	Cost	Year Built
1	Small Inc.	1000		1940
2	Chicken House	1000		1940
3	Food shed	1000		1940
4	Out house	1000		1940
5	Bath House	1000		1940
6	Well	1000		1940



\$100.00
\$200.00
\$300.00
\$400.00
\$500.00
\$600.00
\$700.00
\$800.00
\$900.00
\$1000.00
\$1100.00
\$1200.00
\$1300.00
\$1400.00
\$1500.00
\$1600.00
\$1700.00
\$1800.00
\$1900.00
\$2000.00

EXHIBIT NO. _____
DATE _____
BY _____



EXHIBIT No 621-2.
DATE August 27/48
FILED BY L. S. Turcotte

Kimura Takeo
(Claimant's Name)

PERSONAL CHATTELS

08076
Reg. No.

<u>Description of Major Items (and particularly of goods lost, stolen or destroyed)</u>	<u>Approximate Date Purchase</u>	<u>New or Used When Purchased</u>	<u>Price Paid</u>	<u>Condition when Evacuated</u>	<u>Estimated value at Date of Evacuation</u>
Dressers	1940	Self built	Cost \$70.00 (Material only)	Good	\$70.00
Beds	1941	one self built one bought		good	75.00
Clock	1942	New (2 mos. old)	\$4.50	new	4.50
Cabinet	1939	Self built	12.00 (Material only)	good	12.00
Toy train	1941	New		good (15.00
2 sleighs	1941	New		good)	
dishes, toaster, kitchen ware and silverware		New		good	127.90

Description of Storage of Goods:

Gave key to Custodian of the house and left everything in house. Later Custodian sent me sewing machine and kitchen range.

EXHIBIT No. 621-3
DATE August 27/48
FILED BY R. S. Lucette

General Statement as to Chattels not Described above:

Apparently an inventory of the chattels in our house was made on August 8th, 1942. Some of these chattels belonged to Shigeichi Shigehiro and we have made no claim for these. According to the Custodian file, a tenant Mr. Sloan says he shipped many articles to us. We did not receive them. Sloan says that he shipped two silver trophy cups to us. But file 4077 of Shizue Shigehiro shows these articles were shipped to Shigehiro.

Additional Comments, if any:

T. Kimura

Signature

ANALYSIS OF PERSONAL PROPERTY CLAIM

NAME Takeo KIMURA
Chito (Mrs. Takeo) KIMURA

6916)
 FILE No. 3849
 08076)
 REG. No. 08077

EXHIBIT No. _____

DATE	INVENTORY	DETAILS OF CLAIM	SALES		SOLD WITH REAL PROP.	DECL. NOT FOUND
			AUCTION	TENDER &c		
DECLARATION <u>Apr. 29/42</u> EVACUATION <u>Feb. 24/42</u>	TAKEN BY _____ DATE _____					
Mr. Takeo KIMURA stated the following in his J. P. Declaration Form under Personal Property owned: "Registered by wife"		2 dressers 70.00 2 tables 11.00 2 double beds 75.00 clock 4.50 pots and pans 26.90 dishes 52.00 toaster 4.50 kitchen utensils 35.00 cabinet 12.00 carpenter tools 19.65 lumber and nails 7.00 picture frames 3.50 toys 15.65 saw 20.75 4 1/2 cords of wood 17.50 silverware 9.50				
Chito (Mrs. Takeo) KIMURA declared the following chattels in her J.P. declaration form dated April 15/42. (Evacuated May 9/42)				F 2.50		
Will be left in declarant's home at Ferguson Rd., New Westminster, B.C.		TOTAL CLAIM 384.45			\$2.50	
1 Singer Sewing Machine Bureau Tables Double beds Stove Clock etc. and miscellaneous articles.		<u>Also Sold:</u> 1 Sideboard 5 Kitchen chairs		F 2.50 F 5.00 \$10.00		
Lumber in wood shed - at Ferguson Rd., New Westminster, B.C.		<u>RECAP:</u> Goods valued by Claimant at \$ 12.00 sold by tender etc., for \$2.50. Goods valued by Claimant at 3.50 - no record at any time. Goods valued by Claimant at 40.80 were shipped to Mrs. Kimura. Goods valued by Claimant at <u>328.15</u> were destroyed by Fire. <u>TOTAL CLAIM- \$384.45</u>				We w enclosing return on with Insur No Custodian A q effects, Mr. E.J.
						The follo shipped t 1 cooking 2 Sleighs 1 carton 1 child's 2 Shrines 1 Tricycl 1 toy aut 1 carton 1 kitchen 1 box too 1 Baby B 1 Carton 1 Sewing

6916)
 E No 3849)
 08076)
 G. No. 08077)

EXHIBIT No.

//

CASE No.
 VENUE Lethbridge, ALBERTA.

SALES		SOLD WITH REAL PROP.	DECL. NOT FOUND	NO RECORD AT ANYTIME	ABANDONED	NO ACCOUNT, THEFT &c	XXXXX UNSOLD SHIPPED	DESTROYED BY FIRE.	REMARKS
AUCTION	TENDER &c								
	F 2.50						(1) x	x x x x x x x	1 Table shipped - see below.
				x			x		1 box carpenter's tools shipped - see below.
							x		Toys shipped - see below.
								x x x	Silver trophy cups shipped - see below.
	<u>\$2.50</u>						<u>\$40.80</u>	<u>\$328.15</u>	
	F 2.50								
	F 5.00								
	<u>\$10.00</u>								

etc., for \$2.50.
 any time.
 Mrs. Kimura.
 by Fire.

We wrote Mrs. Takeo KIMURA on August 14, September 14, October 14, and November 20, 1942, enclosing 2 copies of the inventory taken of her chattels, requesting that she sign same and return one copy to us. We also requested her to advise us if she wished her chattels covered with insurance. No reply to our letters was received.

No Fire Insurance was declared by the above-named Japanese and none was placed by the Custodian. Buildings not worth insuring.

A quantity of effects were shipped to Mrs. Kimura (see list below) and the balance of her effects, which were left in the 3 roomed house, were moved into an adjoining shed by the tenant, Mr. E.J. Tisdale. This shed and contents were burned to the ground early in 1944.

- The following goods were shipped to Mrs. KIMURA:
- 1 cooking range (Good cheer)
 - 2 Sleighs
 - 1 carton containing toys
 - 1 child's go-cart
 - 2 Shrines
 - 1 Tricycle
 - 1 toy automobile
 - 1 carton containing toy train & tracks
 - 1 kitchen table
 - 1 box tools (carpenters)
 - 1 Baby Buggy
 - 1 Carton Baby's toys
 - 1 Sewing machine

- The following goods, which were left at the house of Mrs. Takeo KIMURA were shipped to their owner, Mrs. Shigeichi SHIGEMIRO, Registration No. 08085, File No. 4077.
- 1 Boys bicycle
 - 2 Silver trophy cups
 - Fishing rod.

EXHIBIT No. 621-4
 DATE August 27/48
 FILED BY R. Luettke

MEMORANDUM

File Nos. 3849 ✓
6916

June 1st, 1945.

TO: The File
FROM: Mr. W. J. Iverson

RE: Chito (Mrs. Takeo) KIMURA
Takeo KIMURA

The sewing machine and kitchen range belonging to the subject Japanese were shipped to him and the balance of his effects, which were left in the three room shack, were moved into an adjoining shed by the tenant, Mrs. E. J. Tisdale in March 1944. This shed was burned to the ground early in 1944 and the contents burned with it, therefore no further recovery of chattels can be made. There may have been a few more effects shipped to Mr. KIMURA, but this is not clear on the files, and we are writing Mr. Sloan, the original tenant, for particulars.

WJI:LBM

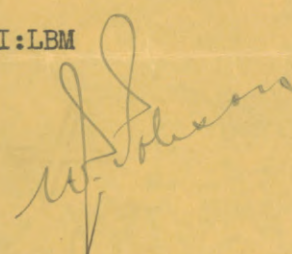

Farm Appraisal Report

COPY

File No. J.L. 414

Land Description Lots 5, 6, 11 & 12 of Lots 17 to 20, Sec. 21, Flk. 5N, R. 2W, Map 2380.

Containing 0.834 Acres

Owner's Name Takeo KIMURA Post Office Address R.R. #4, New Westminster, B.C.

Nearest Rail Point South Westminster Distance $\frac{3}{4}$ mile

Market Town New Westminster Distance $2\frac{1}{2}$ "

Church (give denomination) Anglican $\frac{1}{2}$ mile - all others Distance $2\frac{1}{2}$ "

Nearest School South Westminster Distance $\frac{1}{2}$ "

State how property was identified: L.R.O. Sketch, map & corner post of neighbour land.

Roads: State whether property has access to main road, the kind of road and its condition.

Footpath only to partly opened street (100 yards) Then one block to Ferguson Road - work now going on, on said street.

Is this district a good one? Industrially, yes - agriculturally, no.

Employment opportunity Is in industrial area, and surrounded by homes of both retired parties, and others in industrial employment.

Predominating Nationality and religion: British - none predominating

Describe Fencing and its condition: None Value \$

Water supply: Well near house - stated to be never failing Value \$ incl. in lot.

BUILDINGS ON FARM

6916

BUILDINGS	DIMENSIONS	MATERIAL	HEIGHT	ROOF	AGE	Foundation	REPAIR	VALUATION
HOUSE	16 x 24	Lumber	8'	Shgls.	5?	Posts	Unfin-ished	\$ 150.00
Henhouse	9 x 12	"	7'	Sp.ced.	5	"	new	25.00
Shed	10 x 20	"	7'	Boards	5	"	poor	15.00
BARN	X							
BARN	X							
BARN	X							
GRANARY	X							
	X							
	X							
	X							
	X							

EXH BIT 671-5
DATE August 27/48
FILED BY [Signature]

(No electric lighting - none near as yet)

Total present day value \$ 190.00

Total Value Buildings add to farm \$ 150.00

Is dwelling habitable without repairs? Yes If not what is your approximate estimate of cost to make it habitable? Only one room partitioned off for occupation. Building is shiplap and paper lathed on, one ply. Requires siding and completion of inside finishing. \$

Describe the basement and chimneys: None - roof jack in use, no chimney.

No. rooms downstairs? Space for three rooms; just one partitioned off now. Upstairs? How finished

Are buildings painted? No Condition of paint

Distance from nearest bush near buildings.

Note: Particular care must be taken when examining and reporting on foundations, sills and roofs.

ACRES	LEVEL, UNDULATING, ROLLING OR HILLY	SOIL (State Depth)	SUB- SOIL	KIND AND QUALITY OF CROP	VALUE PER ACRE	TOTAL	
	This is not a farm acreage. Land value is on the basis of a home, as are those of immediate neighbours to the east, north and west. Value as such					-	\$ 75.00
Area which can be cultivated without cost other than for breaking.							
	LEVEL, UNDULATING, ROLLING OR HILLY	SOIL (State Depth)	SUB- SOIL		VALUE PER ACRE		
Area which can be cultivated after a reasonable amount of clearing timber, stones, drainage, etc.							
	LEVEL, UNDULATING, ROLLING OR HILLY	SOIL (State Depth)	SUB- SOIL	NATURE OF RECLAMATION NECESSARY	RECLAMATION COST PER ACRE	VALUE PER ACRE	
Area Unsuitable for Cultivation.							
	CHARACTER OF LAND E. G. HILLY, SWAMPY, ROCKY.		NATURE OF TIMBER IF ANY AND WHETHER MARKETABLE		VALUE OF LAND PER ACRE		

Total value of Land \$ 75.00

Total added by buildings to value of farm \$ 150.00

Total fruit trees add to value of farm (for use in orchard districts only) \$

Total value of farm \$ 225.00

Describe condition of farm commenting on tillage, length of time unoccupied or partly occupied:

Garden only; now under care of J.E.Sloan who, though not occupying the house, has it rented at \$3.00 per month. Uses the henhouse and well. Claims to have option to buy on behalf of his son, now overseas, but would not state duration of option nor at what figure.

State most suitable type of agriculture for farm bearing in mind the district's limitations, if any.

Industrial employee's home only.

Noxious weeds: None

Give approximate detail and amount of all annual taxes and names of Taxing Authorities:

Municipal and school - \$4.50
Surrey Municipality,
Cloverdale, B.C.

Date: 2nd July, 1942.

Place: New Westminster, B.C.

I certify that the above report is based on a personal examination of the whole farm made on the 30 day of July 1942.

Inspector's Signature

"B.C.WORMWORTH"

Note: (Use Form 43 (Sheet 2) in connection with this form.)

Diagram of Property

Takao Kimura

lots 5-6-11402 of lot 17 to 20. Sec 21.

Blk 5th - Rge 2. W. Map. 2380 - 0.834 ac.

Footpath up to street: (not opened) 2 ch

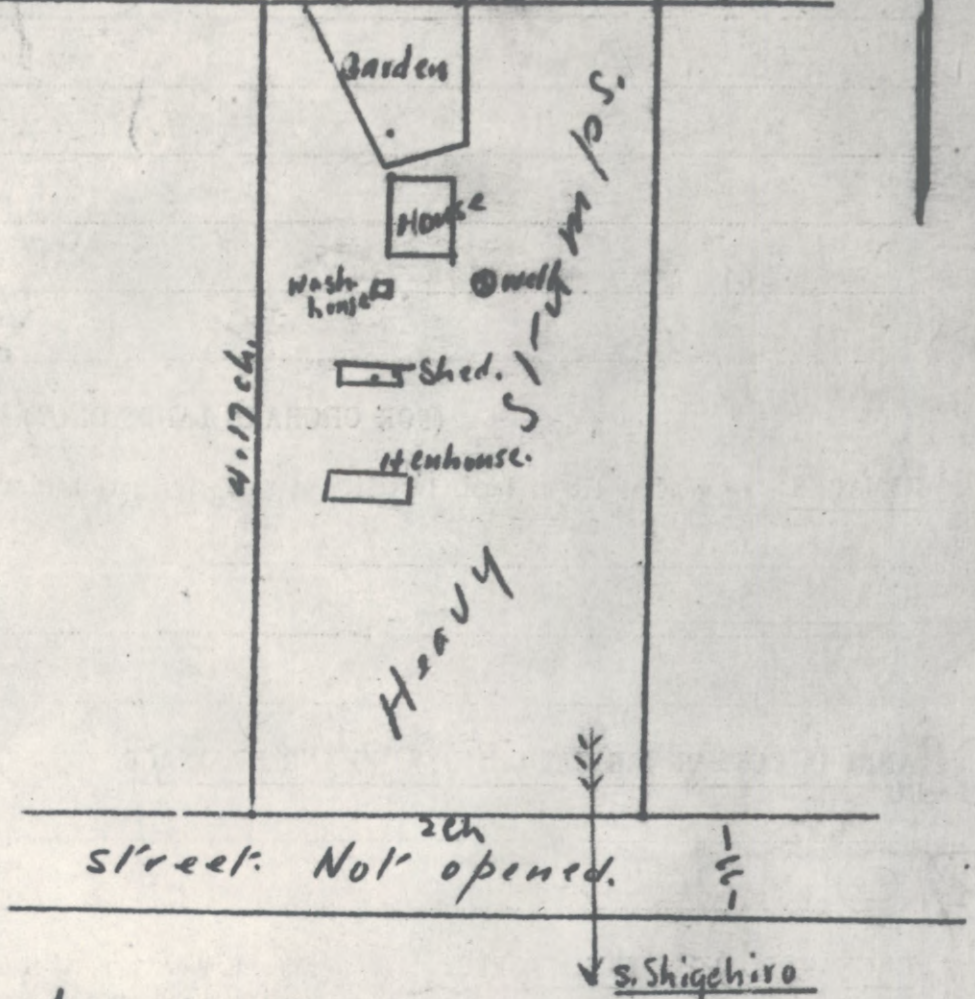

Scale 1 chain to inch

Following careful review of this appraisal report, it is my opinion that the present value is \$ 225.00

Date 3rd July 1942.

"I.T. BARNET"
District Superintendent.

File No. 6916

June 15, 1948.

REAL PROPERTY MEMORANDUM

Re: (Mr.) Takeo KIMURA
Registration No. 08076

Veterans' Land Act transaction.

One Real Property only included, being:

Lots 5, 6, 11 and 12 of Lots 17 to 20 of Section 21,
Block 5 North Range 2 West, Map 2380, Municipality
of Surrey in the District of New Westminster.

Assessment (1943)

Taxes: \$4.50

Land..... \$100.00
Improvements... ..
TOTAL \$100.00

Soldier Settlement Board Valuation:

Land..... \$ 75.00
Buildings..... 150.00
TOTAL \$225.00

Claimant's Valuation:

Land..... \$375.00
Buildings..... 911.00
TOTAL \$1286.00

EXHIBIT No. 621-6
DATE August 27/48
FILED BY Grace

Sold to Director, Veterans' Land Act for \$221.00.

Relative documents attached to Claim File.

WJJ/HMS

[Handwritten Signature]
.....

REAL PROPERTY SUMMARY

Copy for File 3849.

JAPANESE NAME: Takeo KIMURA Reg. No. 08076 File No. 6916.

CATALOGUE NO: Sold by Special Arrangement, The Director, The Veterans' Land Act.
BC/436-P. First Offer.

PROPERTY ADDRESS: Ferguson, R.R. No. 4, Surrey, New Westminster, B.C.

LEGAL DESCRIPTION: Lots 5, 6, 11 and 12 of Lots 17 to 20 of Section 21, Block 5 North,
Range 2 West, Map 2380, Municipality of Surrey, D. N. W.

TITLE: Registered in the name of Takeo KIMURA.

ENCUMBRANCES: None registered. No indication of any unregistered charges.
Vesting Order filed No. 25103, dated 10th December, 1942.

ASSESSED VALUE: Land - \$100.00 Taxes - \$4.50.

CLASSIFICATION: Takeo KIMURA was a Sawmill Worker. This property was used as a home
and not as a commercial Fruit or Vegetable Farm.
The Custodian's representative reported May 14th, 1942, that this
property had an area of 1 acre, no crops.
1 - 1 storey 4 room dwelling, 1 woodshed, 2 small chicken houses.
This property undeveloped mostly covered by shrub. Buildings not
worth very much as the Municipality did not include them in their
Assessment Roll.

HISTORY OF
ADMINISTRATION: The property was leased by the Custodian on January 1st, 1943, to
John Brown Sloan. Term - 1 year from 1st January, 1943 to 31st
December, 1943. Consideration \$36.00, payable \$3.00 monthly on 1st
day each month commencing 1st January, 1943. No Taxes.
Buildings included. Space reserved for storing chattels.
Lease handed to The Director, The Veterans' Land Act, August 2nd, 1943.

SOLD: To The Director, The Veterans' Land Act for \$221.00 as at 1st January,
1943.
Approval of Advisory Committee - 1st June, 1943.
Funds released to the credit of Takeo KIMURA as at May 9th, 1944,
against which were charges for Registration Fees - \$3.00, Legal Fees -
\$15.00, leaving a net credit of \$203.00 from said transactions.
In view of the rents up to August 31st, 1943, having been collected by
the Custodian, a cheque for \$24.00 was issued to The Director, The
Veterans' Land Act, November 17th, 1943, covering same.
Certificate of Title No. 169557-E in the name of The Director, The
Veterans' Land Act.

The above summary is certified to be in accordance
with information on file.
March 19th, 1946.

August 8, 1942.

INVENTORY OF CHATTELS BELONGING

TO

KIMURA, Chito (Mrs. Takeo) # 08077. ¹⁵³⁴
Which are now in the care of J.B. Sloan, No # Ferguson Rd.
($\frac{1}{2}$ mile east of Sandell Rd.)
New Westminster, B.C.

EXHIBIT No. 621- A. for
Identification
DATE Aug 27/42
FILED BY G. A. Rice

In house.

- | | |
|--|--|
| Buck saw. | Few kitch. utensils & dishes. |
| 3 Shovels. | Kitchen cabinet. - <u>Sold</u> |
| 1 Pick. | Electric toaster. |
| 2 Axes. (short handle.) | Ctn. (cont. toy train ^{shipped} & tracks) |
| Double bitted axes. | 5gal. Stone crock. |
| Ironing board. | 2-2gal. " " |
| 2 Sleighs. - <u>Shipped</u> | Mattock. |
| Clothes line & 2 pulleys. | Wheelbarrow. |
| Ctn. (cont. toys) - <u>Shipped</u> | Kitchen range. (Good Cheer) ^{shipped} |
| Childs go-cart. (collapsible) - <u>Shipped</u> | 2 " tables. ^{shipped} |
| 2 Shrines. - <u>Shipped</u> | High chair. |
| 2 Tricycles. - ^{property of Superior Shovel Co 6918} <u>Shipped</u> | 5 Kitchen chairs. - <u>Sold</u> |
| 1 Toy automobile. - <u>Shipped</u> | 2 Coal oil lamps. |
| Singer Sewing Machine. - <u>Shipped</u> | Wall clock. |
| Sideboard. - <u>Sold</u> | 3 Beds. (2 steel & 1 wooden) |
| Heater. (old) | Tool box. (locked) <u>Shipped</u> |
| 2 Chest of drawers. | 2 Cross cut saws. |
| Ctn. (cont. 2 lge. silver trophy cups) - ^{property of Superior Shovel Co 6918} <u>Shipped</u> | |

The above listed articles have been left in my care by the owner, and I will be responsible for their safe keeping.

Witness - J. Morrison. ^{6/6}
See letter & list of effects shipped

Signed. J. B. Sloan

CANADA
DEPARTMENT OF THE SECRETARY OF STATE
OFFICE OF THE CUSTODIAN
JAPANESE EVACUATION SECTION

PHONE PACIFIC 6131

PLEASE REFER TO

FILE NO. 3849

506 ROYAL BANK BLDG.,
HASTINGS AND GRANVILLE
VANCOUVER, B.C.

August 14, 1942

Mrs. Takeo KIMURA, #08077
c/o Neff Fisher
Hillsprings, Alta.

Dear Madam:

re: Chattels

Our inspector called at your home on Ferguson Rd., New Westminster, and has prepared an inventory of your chattels which we enclose herewith in duplicate. Please sign and return one copy to us as soon as possible.

Yours truly,

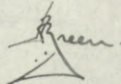

H. F. Green
Manager, Protection Dep't.

EXHIBIT No. 621-7
DATE Aug. 27/42
FILED BY R. S. Turcotte

WGB
WGB:MD
Enclosure

P.S. If you wish to cover your chattels with Insurance kindly let us know the total value and we will then advise you how much the Insurance will cost.

File #3849

August 14, 1942

NAME: KIMURA, Chito

REG. NO: 08077

INVENTORY OF CHATTELS AT FERGUSON RD., NEW WESTMINSTER, B. C.

(Now in the care of J. B. Sloan, R.R.#4, New Westminster, B.C.)

IN HOUSE

1 buck saw	1.25	few kitchen utensils and dishes	52.00
3 shovels	3.00	kitchen cabinet	12.00
1 pick	1.75	electric toaster	4.50
2 axes (short handle)	2.50	ctn. (cont. toy train and tracks)	15.65
double bitted axes		5-gal stone crock	
1 ironing board	1.50	2-2 gal. stone crocks	
2 sleighs	7.90	mattock	
clothes line and 2 pulleys		wheelbarrow	
ctn. (cont. toys)		o kitchen range (good cheer)	
childs go-cart(collapsible)		2 kitchen tables	
2 shrines		high chair	
2 tricycles		5 kitchen chairs	
1 toy automobile		2 coal oil lamps	
1 Singer sewing machine		wall clock	
sideboard		3 beds (2 steel and 1 wooden)	
1 heater (old)	2.00	tool box (locked)	
2 chest of drawers		2 cross cut saws	
etn. (cont. 2 lge. silver trophy cups)			

EXHIBIT No. _____
DATE _____
FILLED BY _____

This represents all my chattels remaining in the protected area of British Columbia.

Please sign and return one copy to the Custodian.

75/10 Confirmed:

DATE: _____ SIGNED: _____

File #3849

August 14, 1942

NAME: KIMURA, Chito

REG. NO: 08077

INVENTORY OF CHATTELS AT FERGUSON RD., NEW WESTMINSTER, B. C.

(Now in the care of J. B. Sloan, R.R.#4, New Westminster, B.C.)

IN HOUSE

1 buck saw	few kitchen utensils and dishes
3 shovels	kitchen cabinet
1 pick	electric toaster
2 axes (short handle)	ctn. (cont. toy train and tracks)
double bitted axes	5-gal stone crock
1 ironing board	2-2 gal. stone crocks
2 sleighs	mattock
clothes line and 2 pulleys	wheelbarrow
ctn. (cont. toys)	kitchen range (good cheer)
childs go-cart(collapsible)	2 kitchen tables
2 shrines	high chair
2 tricycles	5 kitchen chairs
1 toy automobile	2 coal oil lamps
1 Singer sewing machine	wall clock
sideboard	3 beds (2 steel and 1 wooden)
1 heater (old)	tool box (locked)
2 chest of drawers	2 cross cut saws
ctn. (cont. 2 lge. silver trophy cups)	

This represents all my chattels remaining in the protected area of British Columbia.

Please sign and return one copy to the Custodian.

 Confirmed:

DATE: _____ SIGNED: _____