

<u>REAL PROPERTY</u>										
Greater Vancouver		Rural (except V.L.A.)			V.L.A. (except Mission Village)		V.L.A. Mission Village		Total	
Sale Price	5% thereof & 12.50	Sale Price	10% thereof	Charges 12.50 & Comm.	Sale Price	Total Award 80% of all Sale Prices		Sale Price	Total Award 125% of all Sale Prices:	
						% of Total	Amount		% of Total	Amount
					678.00		1155.06			1155.06
<u>PERSONAL PROPERTY</u>										
Motor Vehicles			Boats and Boat Gear							
Sale Price	25% thereof	Sale Price	Nelson Bros. 23.5% of Sale Price	Other Sales 28.5% of Sale Price	Equipment charges paid to purchasers in error. Repay to owners	Amount of Claims for Boat Gear Declared & Recorded Now Missing	45% of amount in next preceding column			
650.00	162.50									162.50
<u>NETS</u>										
Total award for Nets plus Sale Price		Total Claim for Nets Sold, Declared Not Found and Recorded Now Missing			Percentage Total Award to Total Claim		Claim for Nets Sold Declared Not Found, & Recorded Now Missing		Apply % ratio to Claim	Deduct Custodian Sale Price
<u>MISCELLANEOUS CHATELS</u>										
Claim for goods Sold By Auction	Sale Price of Goods Sold By Auction	Rebates of charges 30% of Sale Price	Ratio in % of Sale Price to Claim	Claim for goods Declared Not Found, Recorded Now Missing, & Sold Not Paid	Applica-tion of % ratio to amount in next preceding column	Sale Price of goods Sold by Tender	12% of Sale Price			
370.00	129.50	38.85	35%	506.50	177.27	7.50		.90	217.02	
TOTAL RECOMMENDATION									1534.58	

CASE NO: 1363.

JAPANESE PROPERTY CLAIMS COMMISSION

Montreal, P.Q.,

June 7th, 1948.

IN THE MATTER OF THE CLAIM OF

SUKEGORO YASUI.

PROCEEDINGS AT HEARING.

Original.

IN THE MATTER OF THE "INQUIRIES ACT"
PART 1, REVISED STATUTES OF CANADA 1927, CHAPTER 99.

JAPANESE PROPERTY CLAIMS COMMISSION

B E F O R E
 (THE HONOURABLE MR. JUSTICE H.I. BIRD, COMMISSIONER).

10

Montreal, P.Q.,
 June 7th, 1948.

IN THE MATTER OF THE CLAIM OF
SUKEGORO YASUI.

PROCEEDINGS AT HEARING.

20 APPEARANCES:

J.W.G. HUNTER, Esq., appearing for the
 Dominion Government.

ROGER OUIMET, Esq, K.C., appearing for the
 claimant.

A. WATSON, Esq., Secretary.
 D.J.HANDFORD, Esq., Official Interpreter.
 A.G. VEITCH, Esq., K.C., Official Reporter.

30

S. Yasui,
In Chief.
Discussion.

THE SECRETARY: There are two claims in this matter, my lord.

THE COMMISSIONER: One is for \$4,927.00 and the other is for \$2,975.00.

What is the situation here?

THE SECRETARY: In the Yasui matter, my lord.

THE COMMISSIONER: The Secretary directs my attention to the fact that two claims have been filed, one of which is for \$19,000.00 odd for chattels, apparently.

10 MR. OUIMET: That one was amended by the second one.

MR. HUNTER: That is for loss of revenue, etc.

THE COMMISSIONER: I take it you desire to substitute for the claim sworn November 18th, the one sworn on February 25th, 1948. Is that correct?

MR. OUIMET: Yes, my lord.

THE COMMISSIONER: We can take it that the claim filed on November 18th is abandoned and the other substituted for it.

MR. OUIMET: And the one on February 25 will have to be
20 amended.

THE COMMISSIONER: You say it will have to be amended.

MR. OUIMET: Yes, my lord.

THE COMMISSIONER: Very good. What are your amendments?

MR. OUIMET: Real property, the land and buildings, an amount to a total of \$5,660.00 instead of \$5,605.00, an increase of \$55.00, less amount at which Custodian sold property \$678.00, leaving a net balance of \$4,982.00 instead of \$4,927.00; that is, for personal property the claim No. 6 in paragraph (e) crops from
30 the farm is out, the sum of \$875.00, being thereby

S. Yasui,
Discussion.
In Chief.

deducted.

The total amount for personal chattels being \$2,100.00 from which must be subtracted an amount of \$674.90, the amount at which chattels were sold by Custodian, leaving a net balance of \$1,425.10; so the total claim for real estate and personal chattels is \$6,407.10 instead of \$7,902.00.

10

SUKEGORO YASUI, the claimant herein, being first duly sworn, testified through the Interpreter as follows:

DIRECT EXAMINATION BY MR. OUIMET:

Q You are the claimant in this matter?

A Yes.

Q Would you take communication of real estate claim for a balance of \$4,982.00, identify your signature and the claim and file the same as Exhibit 1?

A Yes.

(PARTICULARS OF REAL ESTATE, FARM LAND, MARKED EXHIBIT NO. 1).

20 Q Would you take communication of personal chattels claim bearing your signature in the sum of \$1,425.10, identify your signature, the claim and the inventory attached thereto, and file same as Exhibit 2?

A Yes.

(PARTICULARS OF PERSONAL CHATTELS, INVENTORY OF PERSONAL CHATTELS, MARKED EXHIBIT NO. 2).

Q Now, I understand that your son, Hardingx Yasui, is familiar with the English language and that you would like him to testify on your behalf?

A Yes.

30 MR. OUIMET: Are there any questions you would like to put

S. Yasui,
Discussion.
H. Yasui,
In Chief.

to this witness, Mr. Hunter?

MR. HUNTER: None.

MR. OUIMET: I would ask my friend to tender the S.S.B. appraisal as Exhibit 3.

MR. HUNTER: I tender the S.S.B. report as Exhibit 3.

(S.S.B. REPORT MARKED EXHIBIT NO. 3).

(Witness aside)

HARDING YASUI, a witness called on behalf of the claimant herein, being first duly sworn, testified as follows:

10

DIRECT EXAMINATION BY MR. OUIMET:

Q Mr. Yasui, I take it that you are familiar with your father's claim? A: Yes.

Q Do you corroborate the claim as already filed as Exhibits 1 and 2? A: Yes.

Q Will you take communication of a letter addressed to your father as of August 8th, 1942, signed by Mr. Richardson, manager of the Farm Department, Department of the Secretary of State, and file this letter as Exhibit 3?

20

In this letter it is said:

"We have already advised you that we sold the berry crop on your farm for \$300.00 to Mrs. A.S. Bell.

"Now that the crop is picked and a full accounting of the proceeds has been filed with us, it appears that \$300.00 was too much to have charged. A more equitable price, in our opinion, would be \$150.00, as this is what the crop would have realized on a 50% net basis.

30=

H. Yasui,
In Chief.

"Mrs. Bell has taken the very best care of both the land and all your chattels, and wishes to continue to have Mrs. Bell continue as tenant and, after taking all the facts into consideration, we suggest that you agree to our making a refund to Mrs. Bell of \$150.00."

THE COMMISSIONER: What is the purpose in filing it?

MR. OUIMET: It is because I want to show the claimant did not consent to this refund.

10 THE COMMISSIONER: Have I jurisdiction to entertain a claim of that description?

MR. OUIMET: Well, it might not be part and parcel of the original claim in itself but it seems to me that in order to establish a proper atmosphere surrounding this particular claim, we should be permitted to show that the claimant was prevailed upon even to reduce the amount he was supposed to receive, the original amount of \$300.00, having been reduced to \$150.00.

20 THE COMMISSIONER: The claimant's father asked for the reduction?

MR. OUIMET: He did not.

Q Do you know whether your father answered the communication asking for the reduction of \$150.00?

A No, he did not answer.

Q Why not? A: It was not a fair amount.

Q A fair amount? A: Yes.

Q That reduction of \$150.00?

A Yes.

(LETTER, CUSTODIAN TO CLAIMANT, AUG. 8, 1942, MARKED EXHIBIT NO. 4).

H. Yasui,
In Chief.

MR. OUIMET: Will my friend tender the R.C.M.P. report as to seizure No. 16 of a 1938 Studebaker sedan, as Exhibit 5?

MR. HUNTER: I tender the R.C.M.P. vehicle receipt as Exhibit 5.

(R.C.M.P. RECEIPT MARKED EXHIBIT NO. 5).

MR. OUIMET: Q: Would you take communication of a picture taken on May 7th, 1943, and say whether or not you can identify the property represented by that picture?

A: Yes.

10

Q What property is that?
own.

A: That is our

Q Your own property?

A: Yes.

Q Does it appear as you left it, or are there any differences?
differences.

A: There are

Q After filing this photograph as Exhibit 6, let me ask you:

(PHOTOGRAPH, CLAIMANT'S PREMISES, MARKED
EXHIBIT NO. 6).^m

20

Would you tell his Lordship what are the differences you see?

A Well, there is a fence on the front of the building.

MR. HUNTER: I cannot hear you.

MR. OUIMET: Q: Would you speak louder?

A A sort of fence on the front of the building.

Q What is that?

A: A fence.

Q Would you speak louder?

A: Yes.

THE COMMISSIONER: Q: A fence?

A: Yes.

MR. OUIMET: Q: And then?

30 MR. HUNTER: What was the difference?

H. Yasui,
In Chief.

THE COMMISSIONER: He says there is a fence in front of
the building which was not there before.

THE WITNESS: No. I do not see a fence here, but there
was one. The picture is not very clear on the side---

MR. OUIMET: Q: On the left hand side?

A Corner there is berries and it appears to me there
are a lot of weeds.

10 Q Would you say on the whole that the property was in
a different position when you left it from what it
appears on that photograph?

A Yes.

Q Was it in a better or worse condition?

A It looks to me as if it has more weeds. It appears
to me not to have been taken care of.

Q Does it appear to you as having been taken care of
the way your family have taken care of it before you
left? A: No. It has not been taken
care of.

20 Q As regards the exhibit report of the R.C.M.P., what
do you have to say about the condition of the
Studebaker sedan before you left and at the time you
were evacuated?

A At the time of evacuation it was in very good con-
dition.

Q Had it been repaired recently?

A Yes.

Q Where? A: Royal City Motors.

Q What kind of repairs had been undergone there?

A General check-up.

30 THE COMMISSIONER: Q: A general overhaul?

H. Yasui,
In Chief.

A Yes, a general overhaul.

MR. OUIMET: Q: For about how much?

A \$20.00.

Q Have you a receipt? A: Yes, sir.

Q You have a receipt? A: Yes. That receipt I paid on the day of departure.

Q So, you are tendering as Exhibit No. 7 a receipt from Royal City Motors Limited, dated New Westminster, British Columbia, March 9, 1942, for the sum of \$20.00, in payment of your account. If this receipt related to the amount of the payment of the overhaul you just mentioned?

A Yes.

Q More or less of a general check-up?

A Yes.

(RECEIPT, ROYAL CITY MOTORS LTD., MARCH 9, 1942, MARKED EXHIBIT NO. 7).

Q What kind of upholstery was there in that sedan, to the best of your knowledge?

20 A In what condition it was?

Q Yes. A: It was in good condition.

Q About the sale of the car, do you have any information to tender as to the sale for \$650.00 to your next door neighbour?

A A friend had 'phoned me that my car was sold to the next door neighbour.

Q Did you acquiesce in the sale of that car? Did you give your consent? A: No.

Q Did you protest the sale of the car?

A They sold it of their own accord.

30 Q Pardon? A: They sold it of their own

H. Yasui,
In Chief.
Discussion.

accord.

Q Of their own accord?

A: Yes.

Q I see.

That is all; your witness.

MR. HUNTER: It is submitted, my lord, that the real property was sold for its fair market value.

It is submitted that the vehicle was sold for its fair market value.

10 It is submitted that chattels sold were sold for their fair market values.

It is submitted that claims made for chattels not sold are exorbitant.

I would tender the analysis of personal property claim as Exhibit 8.

(ANALYSIS OF PERSONAL PROPERTY CLAIM MARKED EXHIBIT NO. 8).

In response to the advertisement for the vehicle an offer was received on July 24 from Bowell, McDonald Motorcar Limited for \$250.00. This was rejected.

20

A tender was received from I.T. Whitbeck for \$380.00. This was rejected.

An offer was received from Leo F. Morris for \$500.00. This was rejected.

An offer of July 25, 1942 was received from D.D. Laberto for \$300.00. This was rejected.

An offer of July 24, 1942, was received from C.D. McQueen for \$500.00. This was rejected.

30 An offer of July 22, 1942, from M. Mackay for

H. Yasui,
Discussion.

\$500.00. This was rejected.

An offer was received from Charles R. Yates for \$375.00. This was rejected.

An offer was received from Southard Motor Company Limited for \$358.00. This was rejected.

An offer was received from Ray B. Ellis of Ellis Motors for \$341.00. This was rejected.

An offer was received of July 24, 1942, from William Carson for \$300.00. This was rejected.

10

An offer was received of \$650.00 from Paul Kuekichi . This was accepted. It was sold to him as of the 14th September, 1942. The original appraised value was \$750.00.

20

I have not had time to make a proper analysis of the personal property claim, as your Lordship will have seen that this is the first detailed claim we have had. The analysis as filed is based upon the inventory as taken and consequently I am not in a position to dispute my learned friend's statement that the Custodian received \$674.90, although it would appear clear to me that more was received. As your Lordship will have seen there was \$650.00 alone received on the vehicle and it would appear to me that considerably more than \$674.90 was received.

THE COMMISSIONER: Yes. I will show the analysis, Exhibit 8, as being apparently incomplete and further information is to be furnished when available in Vancouver?

MR. HUNTER: Yes, my lord. It will have to be furnished.

30

MR. OUIMET: Are you tendering it as an exhibit?

H. Yasui,
Discussion.

MR. HUNTER: It has been put in.

MR. OUIMET: Very well.

THE COMMISSIONER: It is now filed as Exhibit 3.

MR. HUNTER: Possibly at this time I should file the certificate of abandonment of many chattels, although I have not had time to see how many of them refer to items which are claimed. There are some things which are abandoned, considered of no value and abandoned, for which no claim is made. It will give counsel for the claimant an opportunity to know of our position, anyway.

10

I file the certificate of abandonment by W.J. Iverson, dated October 6th, 1945, showing that a considerable number of items were considered of no value and abandoned.

(ABANDONMENT LIST, W.J. IVERSON, OCT. 6, 1945,
MARKED EXHIBIT NO. 9).
m

THE COMMISSIONER: Was there any tenancy of these premises which provided for use of the chattels?

20 MR. HUNTER: I am not sure, my lord. I will check that.

THE COMMISSIONER: Q: Did you or your father rent the premises before you left? A: No.

Q So that when you left the premises, they were vacant?

A Yes, they were vacant. We boarded them up and we handed the key over to the person authorized to act for the Custodian at the station at the time we departed.

MR. HUNTER: According to the real property summary, it says the Custodian leased this land on December 10, 1942, to Mary Bell, --- no; I am wrong; I should have said to Nancy Bell. The lease provided for the

30

H. Yasui,
Discussion.

use of certain chattels and also for storage of other property of the owner. I presume the lease would have been handed over to the Director of the Veterans Land Act at the time of sale.

I wonder if I might have Exhibit 6, the photograph, my lord.

THE COMMISSIONER:: Yes.

CROSS-EXAMINATION BY MR. HUNTER:

10 Q Mr. Yasui, when you identified this photograph you said, "This was our property", if I remember rightly. Did you mean that this was your home ?

A That was our home. That is the north-east corner. Our lot starts there. This photograph shows the north-east corner, the house and the part around the house.

Q And the part to the left which looks like a woodshed, what is that? A: That is part of the house.

20 Q What is inside that, that little lean-to part?

A At the time of evacuation I think mostly the egg candler, egg scale, what we did with eggs, the things were stored in that corner of the building.

Q And where was the entrance to the home -- at the far end of the building?

A No; on the west end.

Q Where is that? A: That is the west.

Q Is the entrance shown on this photograph?

D A No, it is not.

H. Yasui,
 Cross-Exam.
 Re-Direct Exam.

Q The photograph does not show west, east, north or south?
 A: No. This is taken towards the north. The door will be on the west, on the left hand side.

Q That is around on the other side at the far side of the lean-to?
 A: Yes.

MR. HUNTER: That is all, my lord.

RE-DIRECT EXAMINATION BY MR. OUIMET:

10 Q Is there anything else you wish to add?
 A How about the auction sales sheets, I have received, you know the pink slips in respect of the auction sales.
 Q You wish to make a statement concerning pink slips with respect to auction sales?
 A Yes.
 Q Would you make that statement to the Commissioner on behalf of your father?
 A From the list I received from the Custodian I have
 20 not received the pink slips.

MR. HUNTER: I presume he means yellow slips. There are no pink slips of which I know.

THE WITNESS: In the letters it is stated the sale was made but I have not received the slips.

MR. HUNTER: They can be filed if the witness desires it. They are here.

THE COMMISSIONER: Well then they will be available for his inspection here if he wishes to look at them.

MR. HUNTER: The auction sheets; is that what you mean?

30 THE WITNESS: Yes.

H. Yasui,
Discussion.
Re-Direct Exam.

MR. HUNTER: They are here, my lord.

THE COMMISSIONER: I have just ~~been~~ examining the articles abandoned shown on the analysis, Exhibit 8, and find that all of the articles there shown as abandoned are covered in the certificate which has been filed as Exhibit 9.

MR. HUNTER: I am sorry, I did not get that.

10 THE COMMISSIONER: Exhibit 8, the Custodian's analysis, shows a considerable number of articles as having been abandoned. Exhibit 9 is the certificate in regard to abandonment and it includes all of the articles shown in the abandonment column on Exhibit 8.

MR. HUNTER: That would be so, my lord. There are items claimed for there which are not shown on the inventory.

THE COMMISSIONER: I understand. That is all, Mr. ^hHunter?

MR. HUNTER: Yes, my lord.

THE COMMISSIONER: Is there any further re-examination?

20 MR. OUIMET: There probably would be but the witness is looking at the bundle of yellow sheets concerning auction sale.

THE COMMISSIONER: I do not know there is any evidence he can give in regard to the contents of the auction slips.

MR. OUIMET: Q: What did you wish to say about those slips? A: Looking over them I do not see the strawberry boxes mentioned. They were new, purchased the year before.

30 Q Is there anything else you see not mentioned?

H. Yasui,
Re-Direct Exam.

A 350 strawberry crates at the time of evacuation,
300 jam crates.

THE COMMISSIONER: There is no declaration I can see in
Exhibit 8. Were the jam crates, or strawberry boxes
declared by you or your father?

A I think they are mentioned.

MR. HUNTER: They are not, my lord.

THE COMMISSIONER: They are not declared according to
Exhibit 8.

10 MR. OUIMET: Q: What his Lordship is asking you is
whether or not those were declared at the time you
were evacuated either by you or someone else on
behalf of your father. There would be a J.P. form?

MR. HUNTER: Yes.

MR. OUIMET: Have you a copy of it? I do not like filing
the original.

MR. HUNTER: File the original. I have not a copy of it.

MR. OUIMET: Q: Would you look at the J.P. form signed by
your father, dated April 15, 1942, and file it as
20 Exhibit 10? A: Yes.

(J.P. FORM MARKED EXHIBIT NO. 10).

Q You notice that no detail is given?

A No.

Q Is it to your knowledge whether or not the strawberry
crates and other items were mentioned to the Custodian?

MR. HUNTER: What is the answer to that?

MR. OUIMET: He has not answered.

THE WITNESS: We mentioned all the articles which were
supposed to be left at the time.

30 Q Did you mention that verbally because there appears

H. Yasui,
Re-Direct Exam.

to have been no list furnished to the Custodian?

A We did not go into everything in detail -- you know what I mean, every article. That was left in the barn, all locked up.

Q Would you look at Exhibit 9, re abandoned articles considered of no value, take communication of it and give your comments to his Lordship?

THE COMMISSIONER: Q: Have you anything to say about that document? A: Yes.

10 It says "no value". It is stated in this list. I would say there is.

Q You would say there was value in all of those articles? A: Yes.

MR. OUIMET: Q: Is there anything else you wish to say?

A That will be all.

Q That will be all? Thank you.

THE COMMISSIONER: All right; thank you, Mr. Yasui.

(Witness aside)

(PROCEEDINGS ADJOURNED SINE DIE)

20

I hereby certify the foregoing to be a true and accurate transcript of the proceedings herein.

A.G. Veitch
"A.G. VEITCH, C.S.R."

OFFICIAL REPORTER.

30

Case 1363

MAR - 1 1948

3889

IN THE MATTER OF a Commission to Investigate Claims of Japanese Canadians for Property Losses.

TO: The Commissioner,
Office of the Custodian,
Royal Bank Bldg.,
Vancouver, B.C.

Amended Claims

54

Pursuant to the notice issued on the 26th day of September, 1947, I submit the following claim:

(1) NAME YASUI, Sukegoro. (RCMP) Reg. No. 12567.
(Print) Surname Given Name

(2) Pre-Evacuation Address 385 Roebuck Rd., R. R. # 4. NEW WESTMINSTER, B. C.

(3) Present Address 921 Cathedral Street, MONTREAL, P. Q.

(4) REAL ESTATE

(a) Street Address (if any) _____
City or Municipality, Province

(b) Legal description (lot number, block number, section number, etc.) in the Province of
British Columbia and District of NEW WESTMINSTER and more particularly
described as Lot One (1) in the South West Quarter of Section Thirty-
two (32) of Township (2) as shown upon a plan of subdivision of the
South half of said Section 32, the north west, south east and south
west quarters of section Twenty-nine (29) and the north half of section
Twenty of said Township.

(c) Type of Real Property (cross out words which do not apply):

- (i) ~~Farm~~ FARM.
- (ii) ~~Residence~~ Type of business Small fruits and Poultry.
- (iii) ~~Business~~
- (iv) ~~Any other type of property~~ (describe) _____

(d) What was your interest in the property (e.g., sole owner, life tenant, joint tenant, owner of one half or one third interest, leasehold, etc.) Sole Owner.

(e) Fair market value at date of sale (estimate this to the best of your ability):

- (i) Land - - - - - \$ 2,105.00
- (ii) Buildings - - - - - \$ 3,555.00
- (iii) If business, put value on business as going concern (including land and buildings, tenancies, chattels, fixtures, stock-in-trade, goodwill and accounts receivable) - - - - - \$ _____

amends

(iv) Total value (if you cannot give separate values for lands and buildings just fill in total value) - - - - - \$ 5,660.00

(v) Amount at which Custodian sold property and credited your account - - \$ 678.00

(f) Loss (This figure is arrived at by deducting item (v) from item (iv) - - - \$ 4,982.00

4982-

(5) PERSONAL PROPERTY

(a) Place or places at which property was left by the claimant at date of evacuation 20 Acres. as
described above. 4 (b).

(b) Type of premises in which property left (e.g., house, warehouse, garage, shed, church basement, etc.)
House. Chicken houses Garage, Barn Well shed Bathhouse Brooderhouse,
Packing houses.

(c) How stored or packed at time of evacuation Everything packed and stored in
the premises.

(d) In whose care was property left at date of evacuation by the claimant. (This question refers to the terms of reference which exclude claims where the property was lost, destroyed or stolen while under the custody, control or management of any person other than the Custodian appointed by the owner of the property. It involves some definite arrangement whereby you appointed someone to take care of the property and such person accepted the responsibility of so doing. Unless such an arrangement was made the question should be answered "in no one's care")

TAKEN OVER BY THE CUSTODIAN.

(e) Itemized description of personal property which is the subject of the claim:

- | | | | |
|-----|--|--------------------|--------------------------------|
| 1. | <u>Studebaker Sedan, Gone 24000 miles fully equipped</u> | Estimated Value \$ | <u>1,200.00</u> |
| 2. | <u>Sprayer, scales, cutter, stump puller,</u> | Estimated Value \$ | |
| 3. | <u>Shovels, hoes, rakes forks, all equipments</u> | Estimated Value \$ | <u>750.00</u> |
| 4. | <u>Furnitures, Glassware, Chinaware, kitchen</u> | Estimated Value \$ | |
| 5. | <u>utensils, Stoves hot plates etc.,</u> | Estimated Value \$ | <u>150.00</u> |
| 6. | <u>Crops from the farm.</u> | Estimated Value \$ | <u>275.00 - 21.00 = 254.00</u> |
| 7. | | Estimated Value \$ | |
| 8. | | Estimated Value \$ | |
| 9. | | Estimated Value \$ | |
| 10. | | Estimated Value \$ | |

TOTAL CLAIM FOR PROPERTY LOSS \$ 2,975.00 ¹⁴²⁶

N.B.—If you cannot list all the items here prepare a separate list with values set out opposite each item and attach it to the form. The item "personal property" includes shares, bonds, mortgages, loans, notes and all other forms of property not included in real estate.

(f) Total claim including real and personal property (this figure can be arrived at by adding items 4(f) and 5(e) - - - - - \$4,927.00 plus \$2,975.00 - - \$ 7,902.00

- (6) (a) Place at which claimant prefers to be heard. (Vancouver, Kamloops, Nelson, Lethbridge, Moose Jaw, Winnipeg, Toronto or Montreal.) MONTREAL, P. Q.
- (b) Do you require the services of an interpreter at the hearing? Yes or no No.
Harding Yasui. will be interpreter

N.B.—This Declaration must be sworn before a Commissioner, Notary Public or other person entitled to take declarations. All lawyers are qualified to do so.

DOMINION OF CANADA } I, Sukegoro Yasui
of)
TO WIT:)
I, Sukegoro Yasui of the city of Montreal
of Montreal in the Province of Quebec
DO SOLEMNLY DECLARE THAT: District of Montreal

The information set out in the form above is true and correct to the best of my knowledge, information and belief and I make this solemn declaration conscientiously believing it to be true, and knowing that it is of the same force and effect as if made under oath, and by virtue of "The Canada Evidence Act".

DECLARED before me at the city of Montreal)
of Montreal)
in the District of Montreal)
this 25th day of January)
A.D. 1948) S. Yasui
) Commissioner
) A Commissioner &c.

N.B.— THIS FORM FULLY COMPLETED AND SWORN BEFORE A COMMISSIONER SHOULD BE MAILED BY REGISTERED MAIL TO THE COMMISSIONER, c/o THE OFFICE OF THE CUSTODIAN, ROYAL BANK BLDG., VANCOUVER, B.C. BEFORE NOVEMBER 30th, 1947. IF YOU CANNOT MAIL IT BEFORE THIS DATE SET OUT BELOW REASONS FOR THE DELAY.

MAR - 1 1948

921 Cathedral St.
Montreal, P.Q.
Feb., 25th, 1948.

The Commissioner,
Office of the Custodian.
Royal Bank Building.
Vancouver, B. C.

Dear Sir.

I have been told by the Co-operative Committee,
to revise the claim. So this is the revised
claim.

Thank you very much,

Yours very truly,

Sukegore Yasui.

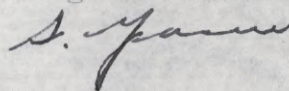

IN THE MATTER OF a Commission to Investigate Claims of Japanese Canadians for Property Losses.

TO: The Commissioner,
Office of the Custodian,
Royal Bank Bldg.,
Vancouver, B.C.

ACKNOWLEDGED

File 3889

Montréal
abandoned. Peter
claim 25 - July 48
H.H.

Pursuant to the notice issued on the 26th day of September, 1947, I submit the following claim:

(1) NAME YASUI, Sukegoro. (RCMP) Reg. No. 12567.
(Print) Surname Given Name

(2) Pre-Evacuation Address 385 Roebuck Rd., R.R. # 4. NEW WESTMINSTER, B. C.

(3) Present Address 921 Cathedral Street. Montreal, P.Q.

(4) REAL ESTATE

(a) Street Address (if any) _____
City or Municipality, Province

(b) Legal description (lot number, block number, section number, etc.) in the Province of _____
British Columbia and District of New Westminster and more particularly
described as Lot One (1) in the South West Quarter of Section Thirty-
two (32) of Township (2) as shown upon a plan of subdivision of the
South half of said Section 32, the north west, south east and south
west quarters of section Twenty-nine (29) and the north half of section
Twenty of said Township.

(c) Type of Real Property (cross out words which do not apply):

- (i) ~~Farm~~ FARM.
- (ii) ~~Residence~~ _____ Type of business _____
- (iii) ~~Business~~ _____
- (iv) ~~Any other type of property (describe)~~ _____

(d) What was your interest in the property (e.g., sole owner, life tenant, joint tenant, owner of one half or one third interest, leasehold, etc.) Sole owner.

(e) Fair market value at date of sale (estimate this to the best of your ability):

- (i) Land - - - - - \$ 2,105.00
- (ii) Buildings - - - - - \$ 3,500.00
- (iii) If business, put value on business as going concern (including land and buildings, tenancies, chattels, fixtures, stock-in-trade, goodwill and accounts receivable) - - - - - \$ -

(iv) Total value (if you cannot give separate values for lands and buildings just fill in total value) - - - - - \$ 5,605.00

(v) Amount at which Custodian sold property and credited your account - - \$ 678.00

(f) Loss (This figure is arrived at by deducting item (v) from item (iv) - - - \$ 4,927.00

(5) PERSONAL PROPERTY

(a) Place or places at which property was left by the claimant at date of evacuation Farm, 20 Acres.
as described above. 4 (b).

(b) Type of premises in which property left (e.g., house, warehouse, garage, shed, church basement, etc.)
House, Chicken houses, Garage, Barn, Well shed, Bath house, Brooder
house, Packing Houses.

(c) How stored or packed at time of evacuation Everything pack and stored in the
Premises.

(d) In whose care was property left at date of evacuation by the claimant. (This question refers to the terms of reference which exclude claims where the property was lost, destroyed or stolen while under the custody, control or management of any person other than the Custodian appointed by the owner of the property. It involves some definite arrangement whereby you appointed someone to take care of the property and such person accepted the responsibility of so doing. Unless such an arrangement was made the question should be answered "in no one's care")

Taken over by the Custodian.

(e) Itemized description of personal property which is the subject of the claim:

1. Studebaker Sedan. Gone 24,000 miles fully equipped. Estimated Value \$ 1,200.00
2. Sprayer, scales, cutter, stump puller, Estimated Value \$ _____
3. shovels, hoes, rakes, forks, all equipments Estimated Value \$ 750.00
4. Furniture, Glassware, fixtures etc. Estimated Value \$ 150.00
5. Stoves, hot plates, etc., Estimated Value \$ _____
6. Crops on the farm, yearly. Estimated Value \$ 875.00
7. Loss of Revenue 1942-46--3 persons-4 persons till 1945. Estimated Value \$ _____
8. Moving to East. Fares. Read attached sheet Estimated Value \$ 258.28
9. Other expenses due to evacuation. Estimated Value \$ 93.50
10. Insurance policies. From 6- to 10 information read the sheet attached to this copies. Estimated Value \$ 3,000.00

TOTAL CLAIM FOR PROPERTY LOSS \$19,931.78

N.B.—If you cannot list all the items here prepare a separate list with values set out opposite each item and attach it to the form. The item "personal property" includes shares, bonds, mortgages, loans, notes and all other forms of property not included in real estate.

(1) (f) Total claim including real and personal property (this figure can be arrived at by adding items 4(f) and 5(e) - - - - - \$5,605.00 Plus \$19,926.78 MINUS \$678.00 = \$25,531.78

(6) (a) Place at which claimant prefers to be heard. (Vancouver, Kamloops, Nelson, Lethbridge, Moose Jaw, Winnipeg, Toronto or Montreal.) MONTREAL, P. Q.

(b) Do you require the services of an interpreter at the hearing? Yes or no. No.

Harding Yasui. Will be interpreter.

N.B.—This Declaration must be sworn before a Commissioner, Notary Public or other person entitled to take declarations. All lawyers are qualified to do so.

DOMINION OF CANADA)
of)
TO WIT:)

I, Subigoro Yasui of the city of Montreal in the Province of Quebec

DO SOLEMNLY DECLARE THAT:
The information set out in the form above is true and correct to the best of my knowledge, information and belief and I make this solemn declaration conscientiously believing it to be true, and knowing that it is of the same force and effect as if made under oath, and by virtue of "The Canada Evidence Act".

DECLARED before me at the city of Montreal)
of Montreal) x S. J. [Signature]
in the Province of Quebec)
this 18th day of November)
A.D. 1947. [Signature]) A Commissioner &c.

N.B.— THIS FORM FULLY COMPLETED AND SWORN BEFORE A COMMISSIONER SHOULD BE MAILED BY REGISTERED MAIL TO THE COMMISSIONER, c/o THE OFFICE OF THE CUSTODIAN, ROYAL BANK BLDG., VANCOUVER, B.C. BEFORE NOVEMBER 30th, 1947. IF YOU CANNOT MAIL IT BEFORE THIS DATE SET OUT BELOW REASONS FOR THE DELAY.

(1) Credit amount is not accounted for the Sale of Property by the Custodian, cause the \$678 was not received direct. See the attached sheet for amount received etc. The statement Sheet # 2.

TO; THE COMMISSIONER,
Office of the Custodian,
Royal Bank Bldg.,
Vancouver, B. C.

YASUI, SUKEGORO.

Reg. 12567.

Present Address. 921 Cathedral Street, MONTREAL, P. Q.

FARM PROPERTY.

TYPE OF FARM. 20A. Small fruits and Poultry.

LAND AND BUILDINGS IMPROVEMENTS,.....\$5,605.00

(a). Personal.

Automobile, sprayer, scale, cutter, equipments.....\$1,950.00

Furniture, fixtures, around house.....\$ 150.00

(b). Crops.....\$875.00

Also loss in Revenue, due to evacuation, 1942:

to 1946.... \$ 3,000.00 yearly (3 persons).....\$13,600.00

FEES PAID.

Paid my families way from Lethbridge, Alberta, to Kingston, Ontario. Due to not able to make sufficient on the beets we had to make head way east to all be employed.

This can be directly attributed to evacuation.

Leth. Alta to Kingston, Ont. ticket and freight.....\$258.28

Other business due to evacuation.....\$ 9350

Personal Loss due to Cancellations, Abandonment of

Insurance Policies, 3 Policies.....\$3,000.00

(c). AMOUNT Recieved from the Custodian as relief.....\$1042.00

Comment on the amount recieved from the Custodian.

We were unable to make our living on the beets, as our record shows in Alberta. We were forced to recieve the money from the Custodian. The relief manager will not grant us any sum of money as long as we had credit in the office at Vancouver. We got relief for 2 months and they took it away from the credit at the Vancouver office. That is the way we had to get help to cover our expenses, cause unable to make enough on the beets. That is were the payment from the Custodian comes in. Needing help, unable to get relief from the B.C. Security Commission at Lethbrfidge, Alberta.

THE FIGURES HAVE BEEN CLEARLY RE-COPIED ON THE NEXT SHEET.

SHEET NUMBER 2.

TO; THE COMMISSIONER,
Office of the Custodian,
Royal Bank Bldg.,
Vancouver, B. C.

YASUI, SUKEGORO.

Reg. 12567.

Present Address. 921 Cathedral Street, MONTREAL, P. Q.

LAND AND BUILDINGS IMPROVEMENTS.....	\$ 5,605.00
(a) Automobile, sprayer, etc.,	\$ 1,950.00
Furniture, fixtures, etc.,	\$ 150.00
(b) Crops, from farm.	\$ 875.00
Loss of Revenue 1942-46.	\$ 13,600.00
Train ticket and freight; (Leth., Alta., to Kingston. Travelling necessity.	\$ 258.28
Other expense due to evacuation.....	\$ 93.50
Cancellations, Abandonment of Insurance Policies, 3 policies.....	\$ 3,000.00
<hr/>	
TOTAL.....	\$ 25,531.78

Amount received from the office of the Custodian. \$ 1,042.00

BALANCE.....	<hr/>
Net.....	\$ 24,489.78.

YASUI, Sukegoro (Mr.)
(Claimant's Name)

REAL ESTATE
(Farm Land)

12567

Reg. No.

LAND	Acres	Date of Purchase	From Whom	Cost Price	Cleared or Uncleared or cultivated at date of Purchase	Improvements at date of Purchase	Estimated value at Date of Sale
Uncleared	<u>13.3</u>						
Cultivated not planted							
Cultivated and not in crop							
List Crops							
Strawberries	3.5	July 4, 1931	Mr. John Matheson	\$1105.	2 acres cleared 17.3 " uncleared <u>19.3</u>	Woodshed	\$2105
Black Currants	1						
Asparagus)							
Spuds & corn)	.5						
Buildings	<u>1</u>						
Total	19.3						

IMPROVEMENTS SINCE PURCHASE OTHER THAN BUILDINGS (e.g. cultivation, plants, trees or special equipment)

Description	When Made	Cost
Cleared about 4 acres	1931-1942	\$1600.
Ditches 800'	"	120.
Well	1932	200.
Bridge	1931	250.
Berry & Currant plant	1932	100.

BUILDINGS			Date Built	Cost Material	Paid for Labour	Value of Own Labour	Allowance for Depreciation	Estimated Value
Type	Size	Finish						
House	24 x 34	Frame	1933	\$1200.	\$250.	\$150.		\$850.
Garage	18 x 20	"	1938	325.	20.	70.		250.
Brooder house	16 x 22	"	1939	225.	35.	15.		200.
Chicken house	22 x 160	"	1936 to 39	2500.	575.	50.		2250.
Bath house	8 x 10	"	1934	50.	15.	10.		40.
Packing house	10 x 14	Post	1933-34	50.	15.	5.		35.
Barn	16 x 36	Frame	1933	100.	65.	20.		100.
Well shed	9 x 9	"	1934	50.	10.	5.		<u>30.</u>
								\$3755.

Comments re Appraiser's report not covered by above information:

Assessed Value 1942

Land	\$ 950.
Improvements	<u>1075.</u>
	\$2025.

EXHIBIT No. 1363-1
DATE 7 June 1948
FILED BY R. Quinn

Summary

Estimated Value	Land	\$2105.
	Buildings	<u>3755.</u>
		\$5860.
Original Claim Form		\$5660.
Sold by Custodian		<u>678.</u>
Claim		\$4982.

[Signature]
Signature

Mr. Sukegoro YASUI

INVENTORY OF PERSONAL CHATTELS

	<u>Estimated Value</u>
1938 State Commander Deluxe Studebaker Sedan	\$1200.00
Stump puller (calbes & pulleys, etc.)	105.00
Hudson Liquid Sprayer - pressure tank type	40.00
Cultivator - horse	25.00
Grass cutter - chicken feed	25.00
350 Strawberry crates	89.00
300 jam crates	50.00
150 picking trays	10.00
2 coal brooder stoves	25.00
Machine tools - pipe threader, cutter, etc.)	240.00
Garden tools - farm tools)	
Kitchen utensils - chinaware sets, etc.	(150.00
- pots, pans, utensils, etc.	(
Stoves - range & heater	75.00
Electric hot plates	20.00
2 china cabinets	40.00
dresser and cabinet	60.00
Scale	15.50
Wood and straw bales	11.50
Nails (new), pipes, electric wires, small articles)	150.00
too numerous to mention in detail.)	
	<hr/>
	\$ 2331.00
	<hr/> <hr/>

YASUI, Sukegoro (Mr.)
(Claimant's Name)

PERSONAL CHATTELS

12567

Reg. No.

Description of Major Items (and particularly of goods lost, stolen or destroyed)	Approximate Date Purchase	New or Used When Purchased	Price Paid	Condition when Evacuated	Estimated value at Date of Evacuation
1938 State Commander Deluxe Studebaker Sedan	1938	New	\$1800.	Excellent	\$1200
Stump puller (cables & pulleys, etc.)	1937	New assembled self	150.	"	105
Hudson liquid sprayer (pressure tank type)	1938	New	45.	"	40
Cultivator (horse)	1937	"	30.	"	25
Grass Cutter (chicken feed)	1939	"	35.	"	25
350 strawberry crates	1941	"	89.	"	89
300 jam crates	1938-1940	"	60.	Good	50
2 coal brooder stoves	1936-1939	"	45.	"	25
Tools machine (pipe threader, cutter)	1937-1940	New & used	115.)	"	240
" garden (farm tools)	" "	"	175.)	"	"
Kitchen - chinaware sets, etc.	1931-1937	New	100.	"	(150
" - pots, pans, etc.	" "	"	150.	"	(
Stoves - ranges, heater	1932-1933	New (heater)	105.	"	75.
Electric hot plates	1940	New	26.	"	20
2 china cabinets	1930-1936	"	80.	"	40
Dresser & cabinet	1930-1931	"	100.	"	60
Scale	1934	"	20.	Excellent	15.50

The claimant is claiming on the attached inventory valued at \$2331.00.

Description of Storage of Goods:

The personal chattels were left on the premises at the date of evacuation. All buildings were locked and boarded securely. The main keys to the buildings were handed to the authorized person acting on behalf of the Custodian in the C.P.R. Station, Westminster Station, at the time of departure.

General Statement as to Chattels not Described above:

Additional Comments, if any:

There are many items such as egg scales, egg candler, fire extinguisher, etc.
Hardware purchase made at Westminster includes electrical goods, wire looms, insulators, etc.

EXHIBIT No. 1363-2
DATE 7 June 1948
FILED BY R. Ormish

Summary

Estimated Value \$2331.

Original Claim \$2100.00
Sold by Custodian \$ 674.90

Claim \$1425.10

Signature S. Yasui

Farm Appraisal Report

File No. JL 484

Land Description Lot 1 of SW 1/4 Sec. 32, Tp. 2, Map 3270.

(385 Roebuck Road) Containing 19.3 Acres

Owner's Name YASUI, Sukegoro Post Office Address R.R. 4, New Westminster, B.C.

Nearest Rail Point Kennedy B.C.E.Rly. Distance 2 miles

Market Town New Westminster Distance 6 miles

Church (give denomination) Newton Presbyterian Distance 2 1/2 miles

Nearest School Queen Elizabeth and Simon Cunningham Distance 1 1/2 miles

State how property was identified: By survey post, map and roads.

Roads: State whether property has access to main road, the kind of road and its condition.

On Roebuck Road, 1/2 mile west of the King George Highway - gravel, good.

Is this district a good one? Not a good agricultural district but there are some good small farms in vicinity.

Employment opportunity Seasonal on berry farms. Industries located along the Fraser River about 6 miles distant.

Predominating Nationality and religion: British, Protestant.

Describe Fencing and its condition: Neighbour's fence, 4 p.w. - good - / on west end. Value \$

Water supply: Hand pump from well, 30' to water. Wells in district usually go dry after a hot summer. Value \$

BUILDINGS ON FARM

BUILDINGS	DIMENSIONS	MATERIAL	HEIGHT	ROOF	AGE	Foundation	REPAIR	VALUATION
HOUSE	12 x 34	frame	8'	shgl	15	cedar posts	poor	150.00
Leanto	12 x 34	"	7'	roof'g				
	x							
BARN	16 x 36	posts & shk.	8'	shk.	20	posts	"	-
Garage	18 x 20	frame	8'	shgl.	2	plks.	good	50.00
	x							
Shack	16 x 22	"	7'	"	5	"	fair	25.00
GRANARY	x							
Chicken hse.	22 x 150	"	7'	"	6-10	cedar posts	good	500.00
Bath hse.	8 x 10	"	7'	"	10	posts	fair	-
Packing shed	10 x 14	posts & shk.	7'	shk.	20	"	poor	-
	x							

Electricity in buildings.

Total present day value \$ 725.00

Total Value Buildings add to farm \$ 350.00

Is dwelling habitable without repairs? If not what is your approximate estimate of cost to make it

habitable? Habitable but not in good shape.

Describe the basement and chimneys: No basement, stove-pipe chimney.

No. rooms downstairs? 5 Upstairs? - How finished Part V-joint, part unfinished.

Are buildings painted? No. Condition of paint -

Distance from nearest bush 100 yards.

EXHIBIT No. 1363-3
DATE 7 June 1948
FILED BY [Signature]

Note: Particular care must be taken when examining and reporting on foundations, sills and roofs.

ACRES	LEVEL, UNDULATING, ROLLING OR HILLY	SOIL (State Depth)	SUB- SOIL	KIND AND QUALITY OF CROP	VALUE PER ACRE	TOTAL
3.25	level	sdv.loam 8"-12"	sand 24" then slightly hardpan	straws, black currants asparagus - poor	50.00	162.50
Area which can be cultivated without cost other than for breaking.						
	LEVEL, UNDULATING, ROLLING OR HILLY	SOIL (State Depth)	SUB- SOIL		VALUE PER ACRE	
Area which can be cultivated after a reasonable amount of clearing timber, stones, drainage, etc.						
	LEVEL, UNDULATING, ROLLING OR HILLY	SOIL (State Depth)	SUB- SOIL	NATURE OF RECLAMATION NECESSARY	RECLAMATION COST PER ACRE	VALUE PER ACRE
1.8	level	sdv.lm. 8"-24"	sand & slight hardpan	clearing of stumps & light second growth	75.00	20.00
14.25	part level ravine	"	"	clearing of bush & stumps, light second growth	100.00	10.00
Area Unsuitable for Cultivation.						
	CHARACTER OF LAND E. G. HILLY, SWAMPY, ROCKY.		NATURE OF TIMBER IF ANY AND WHETHER MARKETABLE		VALUE OF LAND PER ACRE	

Total value of Land \$ 341.00

Total added by buildings to value of farm \$ 350.00

Total fruit trees add to value of farm (for use in orchard districts only) \$

Total value of farm \$ 691.00

Describe condition of farm commenting on tillage, length of time unoccupied or partly occupied:

Farm in poor state of cultivation, very weedy, straws old and poor.
Property rented but unable to see tenant and learn terms of lease.

State most suitable type of agriculture for farm bearing in mind the district's limitations, if any.

Small fruits, poultry.

Noxious weeds: Thistles and numerous common weeds.

Give approximate detail and
amount of all annual taxes and
names of Taxing Authorities:Taxes \$48.84.
Surrey Municipality.

Date: July 7th, 1942.

Place: New Westminster, B.C.

I certify that the above report is based on a personal examination
of the whole farm made on the 3rd day of July, 1942.

Inspector's Signature

"R.W. BROWN"

Note: (Use Form 43 (Sheet 2) in connection with this form.)

Diagram of Property

SCALE 20' = 1"

LOT 1, 9 SW 1/4 Sec 22, T4P, R12W, MHP 3270 - 19.3 AC

N.

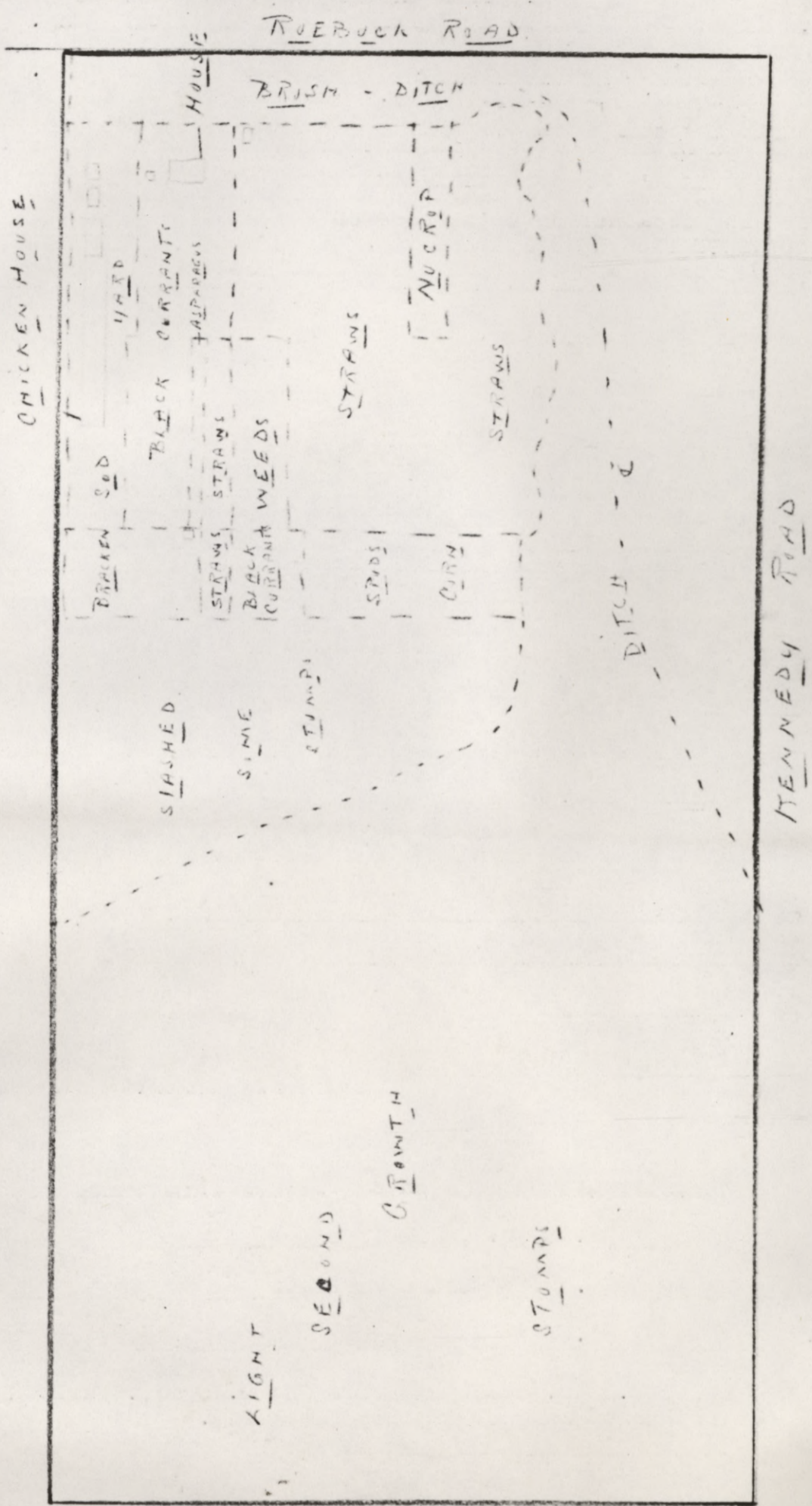

R.W. BROWN

Following careful review of this appraisal report, it is my opinion that the present value is \$ 800.00

Date 13th July, 19 42.

"I.T. BARNET" District Superintendent.

CANADA
DEPARTMENT OF THE SECRETARY OF STATE
OFFICE OF THE CUSTODIAN
JAPANESE EVACUATION SECTION

PHONE PACIFIC 6131

PLEASE REFER TO

FILE No. 3889

506 ROYAL BANK BLDG.,
HASTINGS AND GRANVILLE
VANCOUVER, B.C.

8th August, 1942.

Mr. Sukegoro Yasui,
P.O. Box #24,
Raymond, Alta.

Dear Sir:

We have already advised you that we sold the berry crop on your farm for \$300.00 to Mrs. A.S. Bell.

Now that the crop is picked and a full accounting of the proceeds has been filed with us, it appears that \$300.00 was too much to have charged. A more equitable price, in our opinion, would be \$150.00, as this is what the crop would have realized on a 50% net basis. Mrs. Bell has taken the very best care of both the land and all your chattels, and wishes to continue to have the lease on your farm. We are anxious to have Mrs. Bell continue as tenant and, after taking all the facts into consideration, we suggest that you agree to our making a refund to Mrs. Bell of \$150.00.

Kindly give this matter your prompt and full consideration, and let us know if you consent to a refund being made of the amount suggested.

Yours truly,

R. O. Richardson
Manager,
Farm Department.

RDR:GF

EXHIBIT No. 1363-4
DATE 7 June 1948
FILED BY R. D. D. D.

1363 - 5
EXHIBIT No. _____
DATE 7 June 1948
FILED BY J.W.G.Hunter

ROYAL CANADIAN MOUNTED POLICE
EXHIBIT REPORT

Seizure No.16

Detachment File No. _____ Detachment
Sub-Division File No. _____ Sub-division
Division File No. _____ Division
Headquarters File No. _____ Date 19

RE: YASUI, Sukegoro R.R.No.4 New Westminster, B.C.
On 19 , I

Came into possession of the following goods by:

LICENSE NO. _____
MAKE & MODEL (42) 51420 TIRE NUMBERS 5
SERIAL NO. 38 Studebaker Sedan
ENGINE NO 4106503
SPEEDOMETER READING 32643 20617
CONDITION

appears good condition

EXTRA EQUIPMENT Radio, heater, clock

DESCRIPTION & CONDITION
VERIFIED

"S. Yasui" "12567"
Signature of Owner
Japanese Registration No.

Handed over to representative of
Custodian whose signature in receipt thereof
appears hereunder:

"E.A.Cruise"
March 9/42

"A Price"
Signature of member submitting report

I hereby certify that the foregoing words are a true copy of the
original whereof they purport to be a copy.

August 4th 1948

J. Scaly
J.G.

RP 2

YASUI, Sukegoro
385 Roebuck Rd., Surrey, B. C.
Evac. File 3889



EXHIBIT No. 1363-6
DATE 7 June 1948
FILED BY R. Amine,

Picture Taken May 7, 1943

New Westminster, B. C., *March 9 1942*

RECEIVED from *S. J. Mason* the sum of

Twenty ^{*05*} DOLLARS \$

<i>20</i>	<i>05</i>
-----------	-----------

For *ap*

ROYAL CITY MOTORS LTD.,

THANK YOU

per *B. J.*

KINDLY
RETAIN
THIS
RECEIPT

EXHIBIT NO.

1363-7

DATE

7 June 1948

FILED BY

R. O. Munnick

61908

2112

11.39

20.05

31.44

ANALYSIS OF PERSONAL PROPERTY CLAIM

FILE No 3889

EXHIBIT No. _____

NAME Sukegoro YASUI

REG. No 12567

DATE	INVENTORY	DETAILS OF CLAIM	SALES		SOLD WITH REAL PROP.	DECL. NOT FOUND
			AUCTION	TENDER &c		
DECLARATION <u>15 Apr 42</u>	TAKEN BY _____					
EVACUATION <u>20 Apr 42</u>	DATE _____					
	To be stored at 385 1 Stump puller/cable	Studebaker sedan 1200	33			
	Roebuck Rd., Surrey, 1 Dresser	Sprayer, scales, stump				
	BC - 1 Elec Hot plate	puller, shovels, hoes,	2			
	Stump puller, 1 Kitch. cupboard	rakes, forks, all				
	Household furnish- 1 Stool	equipment 750				
	ings for 5 rm 1 sm Table	Furniture, glassware,				
	house 1 Wardrobe	chinaware, kitchen	1 75			
	Garden tools 6 Chairs	utensils, stoves, hot				
	1 - 1913 Dodge	plates etc 150	12 50			
	sm quan. Lumber	Crops from farm 875				
	2 Brooder tops					
	3 car rims	2975 --				
	1 Car wheel (Dodge)					
	1 Gas drum					
	1/2 gal Crock			Incl		
	2 bxs Parts (sundries)		3 50	:		
	1 ctn Sealers			:		
	1 Spray pump with tank		4 75	:		
	Hand pump at well			:		
	Pickers trays			:		
	4 1/2 bdles Shingles			:		
	1 loose Door			:		
	1 240# Scale			:	7 50	
	2 Beds complete		50	:		
	1 Trunk & contents			:		
	1 Shrine			:		
	1 Feed cutter			:		
	4 1/2 gal Crock Fountain			:		
	8 Metal Feed troughs			:		
	1-2 1/4/6 gal Crocks		3	(4)		
	2 Ctns Books					
	1 Box utensils					
	1 Hand saw					
	1 bx Tools					
	2 HM Bunks					
	7 galv. Buckets					
	1 rd Table					
	1 Wheelbarrow					
	3 X-cut Saws		3 50			
	1 Day bed		6			
	2 rolls Tar Paper					
	1 Range		9			
	1 Camp Heater					
	1 Cultivator		10			
			M 16			
			T 11			
			K 5 25			
			F 7 75			
			129 50			
				7.50		

1938

Tend

SALES		SOLD WITH REAL PROP.	DECL. NOT FOUND	NO RECORD AT ANYTIME	ABANDONED	NO ACCOUNT, THEFT &c	UNSOLD	REMARKS
AUCTION	TENDER &c							
33								
2					X ✓			
1 75					X ✓			
12 50					X ✓			
					X ✓	X		Poss. used on premises
					X ✓			
					X ✓			
3 50	Incl					X		
4 75	:							
	:							
	:				X ✓			Fixture
	:				X ✓	X		
50	: 7 50							
	:							
	:				X ✓			
	:				X ✓			
3	(4)				X ✓			
					X ✓	X		
3 50					X ✓			
6								
9						X		
10					X ✓			
16								
11								
5 25								
7 75								

EXHIBIT No. 1363-8
 DATE 7 June 1948
 FILED BY J. W. Hunter

1938 Studebaker Sedan: Eng.#32643, Ser.#4106503, MILEAGE 20617

Tenders to purchase :-

\$250.	rejected	\$500.	rejected
300.	"	500.	"
300.	"	500.	"
341.	"	650.	accepted 14/9/42
358.	"		
375.	"		
380.	"		

129 50 7.50

EXHIB 1363 - 9

DATE 7 June 1948
FILED BY

J.W.G. Punter

ABANDONMENT LIST

October 6th, 1945.

File No. 3889

Re: Sukegoro YASUI

The following articles were considered of no value and were abandoned:

Old range, burnt out
Heater " "
1 Home made stool
6 chairs (poor)
2 Brooder tops (unsold at auction)
3 Car rims
1 Car wheel
1 Gas drum
Quantity of pickers trays
Loose door
Feed cutter
1 Old barrow
3 Cross cut saws
2 Home made bunks
1 Crock (broken)
Quantity of paper books, etc.
1 Feed cutter
8 Metal troughs
2 Cartons of books
1 Table

"W.J. Iverson"
W.J. Iverson

WJI:LBM

I hereby certify that the foregoing words are a true copy of the original whereof they purport to be a copy.

August 4th 1948

W. J. Iverson
W. J.

OFFICE OF THE CUSTODIAN

JAPANESE SECTION

To be completed by persons of the Japanese race having property in any protected area. The proper administration of this property requires such persons to give full particulars as requested in this form.

PERSONAL INFORMATION

NAME: **YASUI Sukegoro** EXHIBIT No. **1363 - 10**
 HOME ADDRESS: **358 Roebuck Rd., Surrey, B. C.** DATE: **7 June 1948**
 REGISTRATION NUMBER **12567** SEX: **Male** AGE: **56**
 OCCUPATION: **Farmer** FILED BY: **J.W.G. Hunter**

(If any business or businesses carried on, state where, under what name and whether carried on by yourself or in partnership with anyone; if partnership, give partner's name.)

EMPLOYER: **None**
 MARRIED? **Yes**
 NAME OF WIFE OR HUSBAND: **Tane**
 ADDRESS OF WIFE OR HUSBAND: **358 Roebuck Rd., Surrey, B.C.**
 NAMES OF ANY LIVING CHILDREN: **Yasue (F) Harding (M)**
 ADDRESS OF CHILDREN: **358 Roebuck Rd., Surrey, B. C.**
 AGE OF CHILDREN: **None**

STATEMENT OF ALL REAL PROPERTY (Each parcel must be mentioned and particulars given)

- LOCATION AND DESCRIPTION: **20 acres - at 358 Roebuck Rd., Surrey, B.C. Lot No.1 - 6 $\frac{1}{2}$ acres cleared-**
- BUILDINGS AND OTHER IMPROVEMENTS: **house - 5 rooms, chicken house, barn, garage, pciker house, warehouse, 2 packing sheds**
- INSURANCE (Give particulars; state where policies are) **None**
- TAXES (Amount and where payable) **\$49.00 paid to the Municipality of Surrey B.C. 1941 taxes paid.**
- ENCUMBRANCES (Including any unregistered claims or deposit of title deed) **\$300.00 still owing on property payable to Harry Johnston K.C., New Westminster, B. C.**
- OCCUPANCY AND LEASES (If vacant so state) **Occupied by owner.**

4. INSURANCE

5. MORTGAGES

OTHER

6. MONEYS

7. BONDS, DEBTS

1. \$50.00

8. BANK ACCOUNTS

9. LIFE INSURANCE

wife, Tenants
unknown

10. INTEREST

11. SAFETY DEPOSIT BOXES

LIABILITIES:

1. PERSONAL

2. TRADE DEBTS

I, the undersigned, certify that the above is a true and correct statement of the property, interests, liabilities, and other matters mentioned in the foregoing questions, and that the same are true and correct to the best of my knowledge and belief.

I certify that the above is a true and correct statement of the property, interests, liabilities, and other matters mentioned in the foregoing questions, and that the same are true and correct to the best of my knowledge and belief.

Dated this _____

"F."

FOR DEPARTMENT OF LANDS
copy of

August

7. STATE WHEREABOUTS OF TITLE DOCUMENTS: Registrars office, New Westminster B.C.

8. STATE IF ANY OTHER PERSON HAS ANY INTEREST: Harry Johnson K.C. New Westminster

9. IF FARM LAND STATE CROPS SOWN: 3/4 acre black currants, 3 1/2 acre strawberries. 10 fruit trees

STATEMENT OF REAL PROPERTY OCCUPIED

1. LOCATION AND DESCRIPTION: None

2. LANDLORD'S NAME AND ADDRESS: None

3. PARTICULARS OF LEASE AND RENT AND DATE TO WHICH PAID: None

4. STATE WHEREABOUTS OF LEASE: None

5. SUB-TENANTS, IF ANY (Give name, address, rent and to what date paid) None

6. IF FARM LAND, PARTICULARS OF CROPS SOWN: None

STATEMENT OF PERSONAL PROPERTY OWNED:

1. GIVE BRIEF DESCRIPTION AND STATE LOCATION OF FURNITURE, FIXTURES, EQUIPMENT AND MACHINERY, STOCK IN TRADE AND PERSONAL EFFECTS:

To be stored at 385 Roebuck Rd., Surrey, B. C. - stump puller, household furnishings for 5 room house, garden tools.

2. HORSES, LIVESTOCK AND OTHER ANIMALS, POULTRY AND PETS

None

3. GIVE THE NAME AND ADDRESS OF ANY PERSON HAVING ANY INTEREST IN, OR CLAIM ON ANY SUCH PROPERTY: None

office, New Westminster

FORM "JP"

FILE No.....

Johnson K.C.
New Westminster
3 1/2 acre strawberries.

4. INSURANCE CARRIED ON ABOVE PROPERTY: None

5. MORTGAGES, LIENS AND OTHER CLAIMS ON PROPERTY IN POSSESSION OF OTHERS: None

6. MONEYS OWING TO YOU (State if any of these debts assigned and if so, to whom) None

PAID:

7. BONDS, DEBENTURES, SHARES, STOCKS OR OTHER SECURITIES (State whereabouts)
1 \$50.00 Victory Bond - 1942 - in owner's possession. No. unknown

paid)

8. BANK ACCOUNTS: None

9. LIFE INSURANCE: Sun Life Assurance Co., for \$1,000.00 Beneficiary - wife, Tame pays \$32.23 1/2 yearly, Policy no. unknown - Policy no. unknown - Policy in owner's possession

10. INTEREST IN ANY ESTATES OR TRUSTS None

11. SAFETY DEPOSIT BOX: None

LIABILITIES:

1. PERSONAL DEBTS: None

FURNITURE, FIXTURES, PERSONAL EFFECTS:

up pulber, household

2. TRADE DEBTS: None

SETS

I, the undersigned, hereby voluntarily turn over to the Custodian all my property in the protected area as set out above, excepting fishing vessels, deposits of money, shares of stock, debentures, bonds or other securities, if any.

I certify that the above information is true and complete and fully discloses all my property of every description in any protected area in British Columbia and sets forth all my liabilities direct and indirect.

Dated this 15th day of April 1942

NY INTEREST IN, OR

"F.T. Williams" (Signature) "S. Yasui"
Witness

FOR DEPARTMENTAL USE..... I hereby certify that the foregoing words are a true copy of the original whereof they purport to be a copy.

August 4th 1948

M. Sealy