

NE 1/4 Sec. 20 Twp. 12

MAPLE RIDGE

NE 1/4 Sec. 20 Twp. 12

1" = 200'

↑ SEC. 29

(27TH RD) 128TH AVE

N ↑

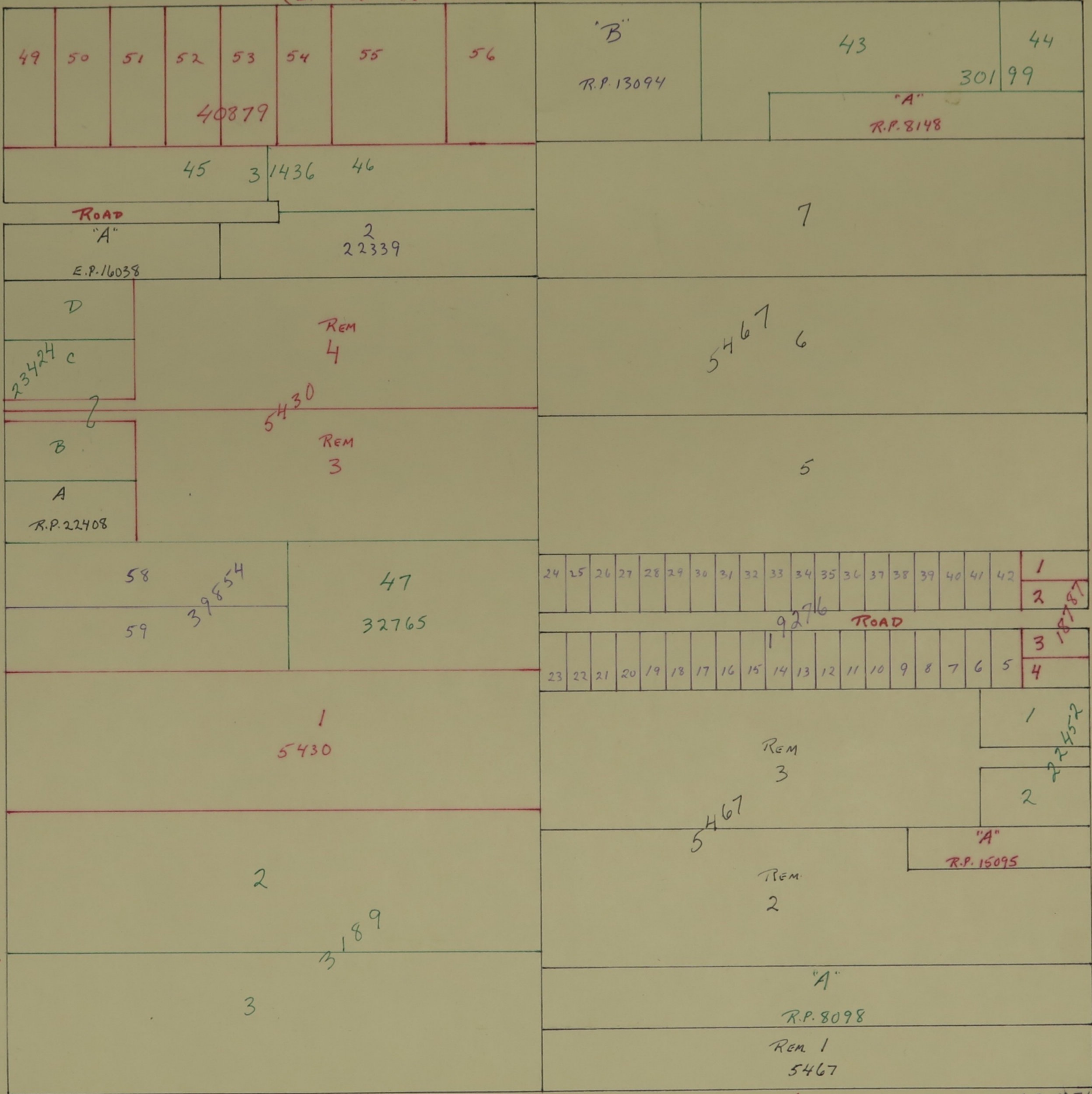

← NW 1/4

→ Sec. 21

(11TH AVE) 228TH ST

232ND ST.  
(14TH AVE) (LILLOOET)

↓ SE 1/4

MAR 1975