

Map of Foreshore No 1 to Northfield (Brechin)

MANITOBA COMMUNITY ARCHIVES

SOURCE: _____

THIS COPY IS PROVIDED FOR
RESEARCH PURPOSES ONLY.

M-2/95 Map of Foreshore No 1 to
Northfield Mine (B-02-010)
[Brechin] (Original)

1909

DEPARTURE
BAY

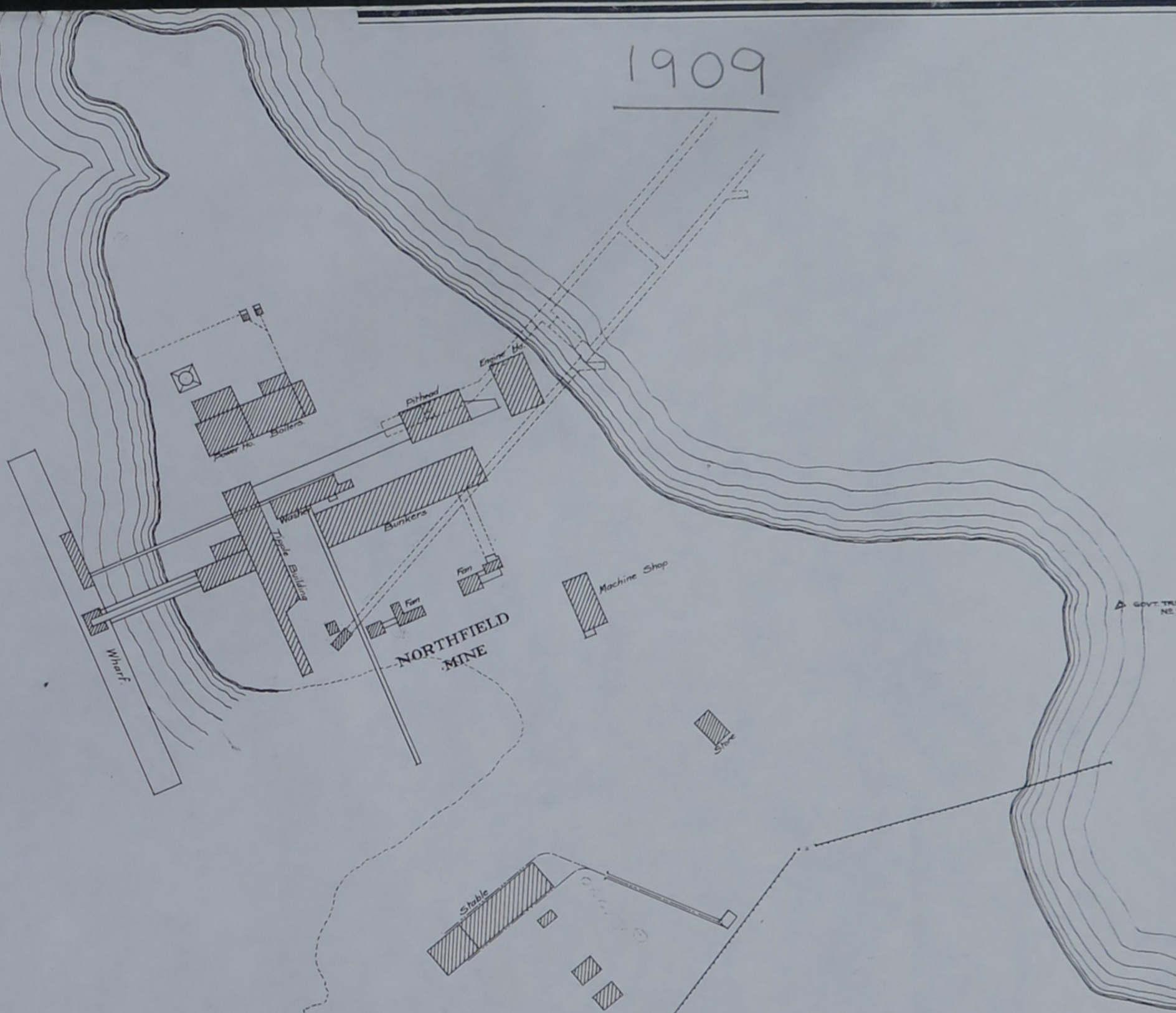

COPY

© BORE HOLE NO

14-169

1909

EXIT CHANNEL



EXIT CHANNEL



GOVT. TRIANG. STA. N5 D

H

No

SCALE

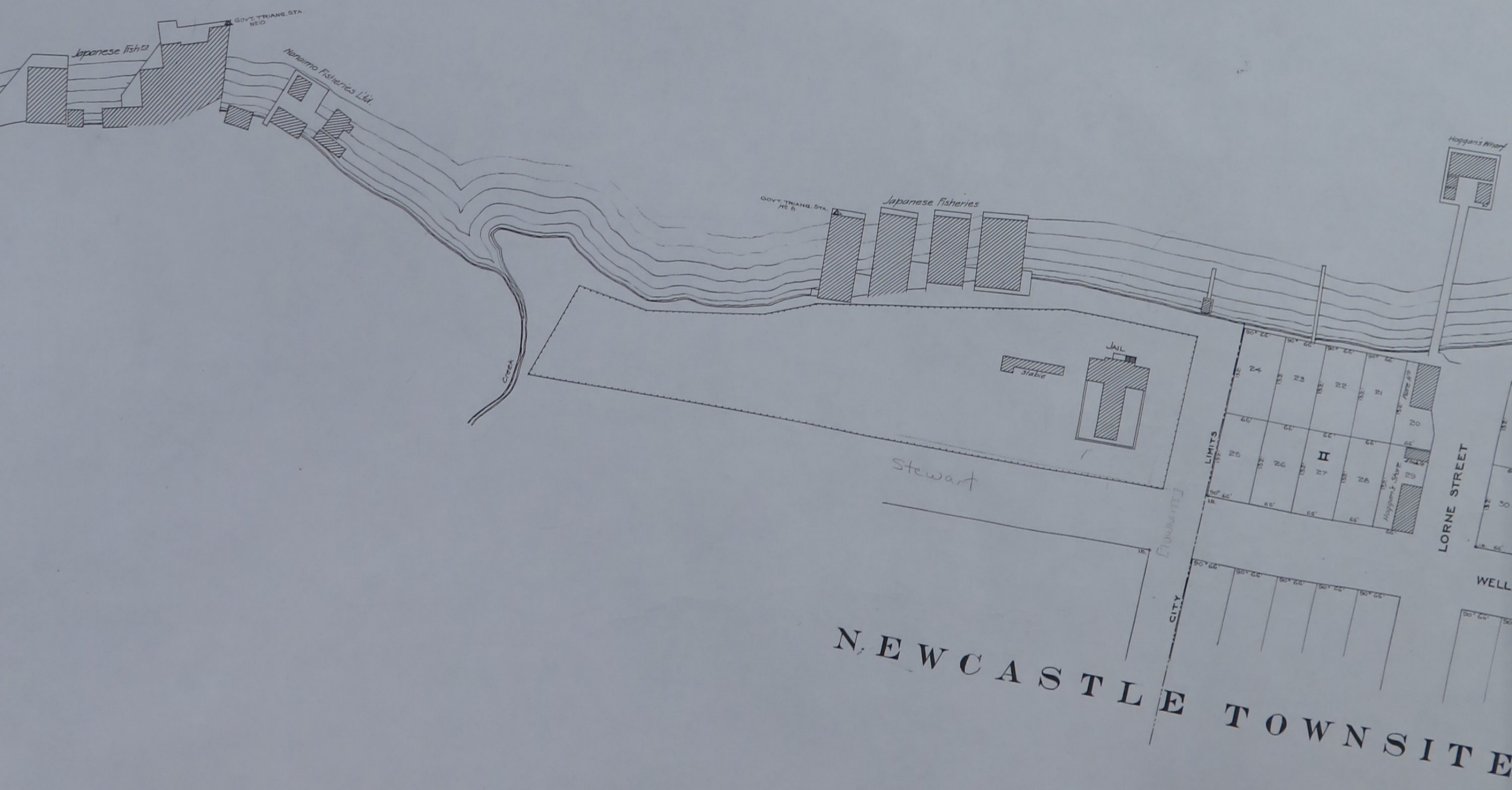

MAP OF FORESHORE

— FROM —

No 1 TO NORTHFIELD MINES

SCALE, 1 IN. = 100 FT.

DATE, SEPT. 09

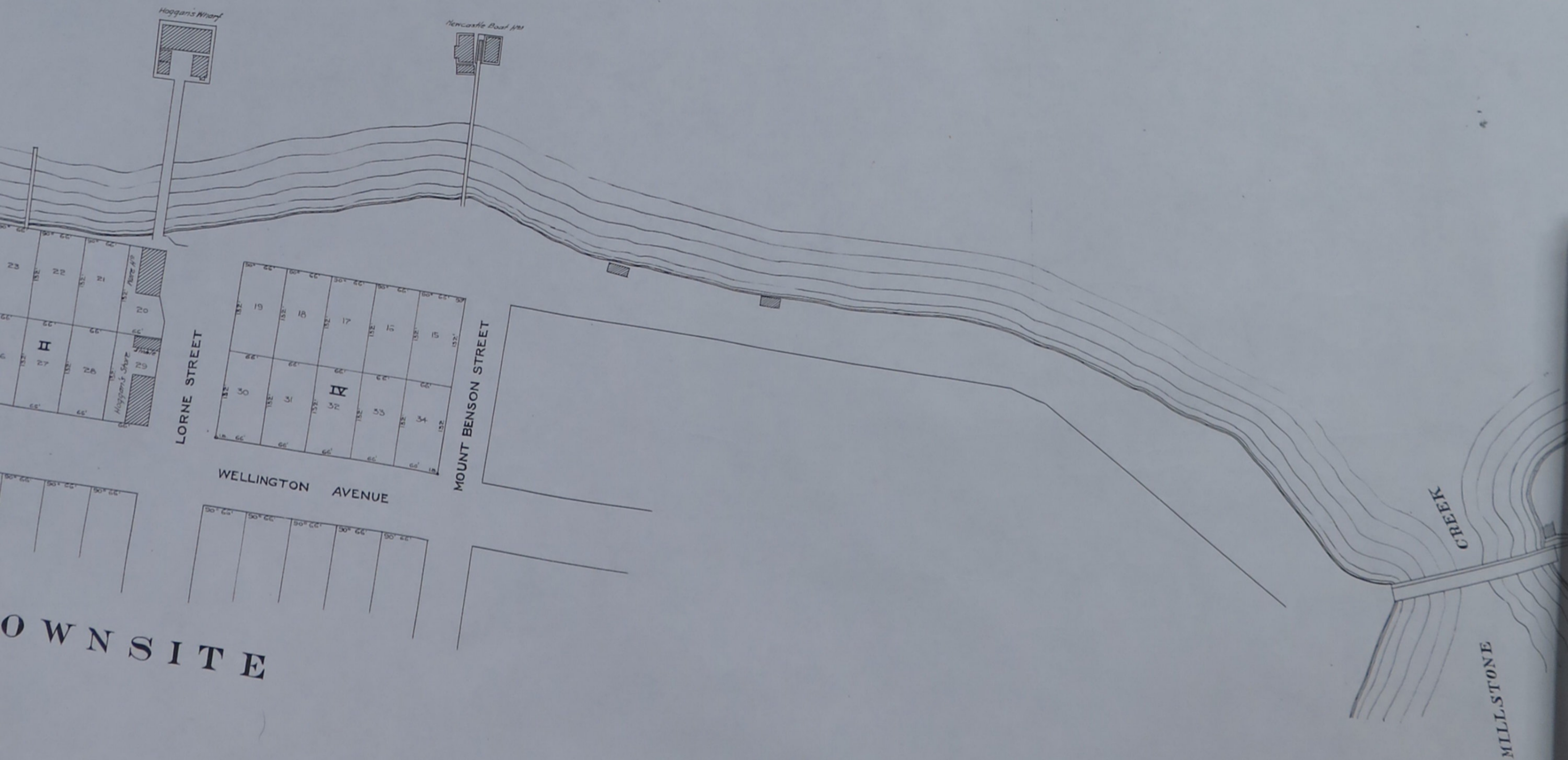
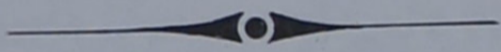

NANAIMO

STONE BEACON



HARBOR.

A I M O

STONE BEACON

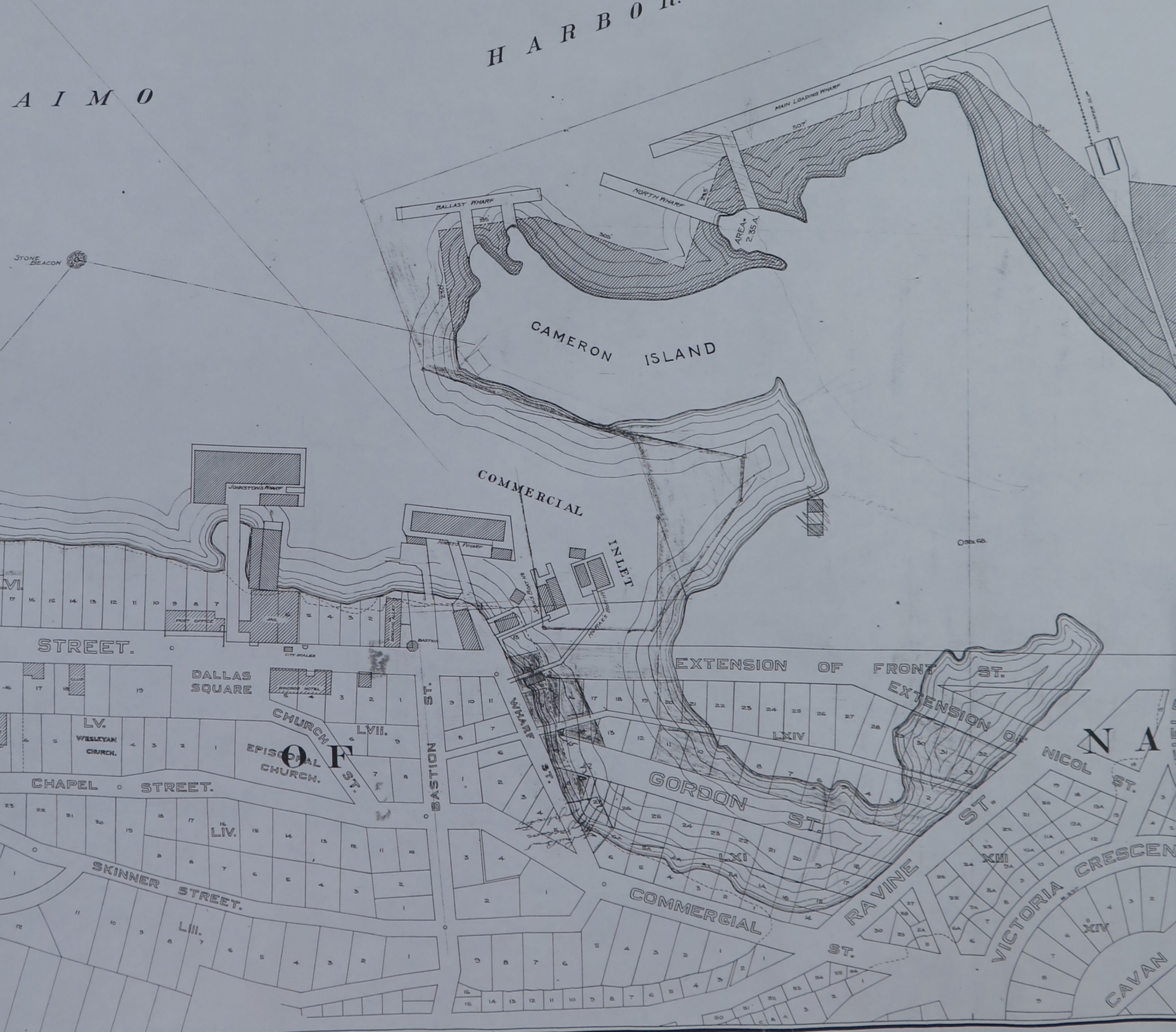

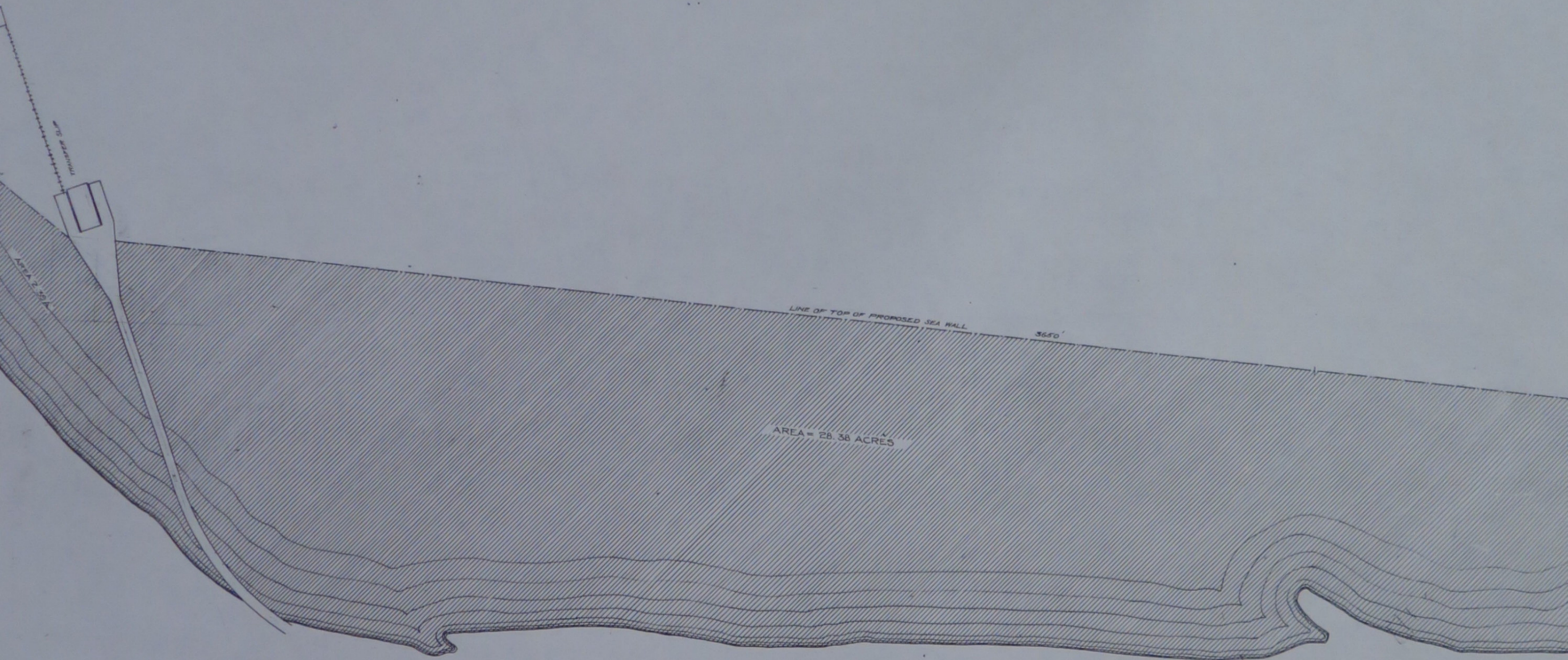

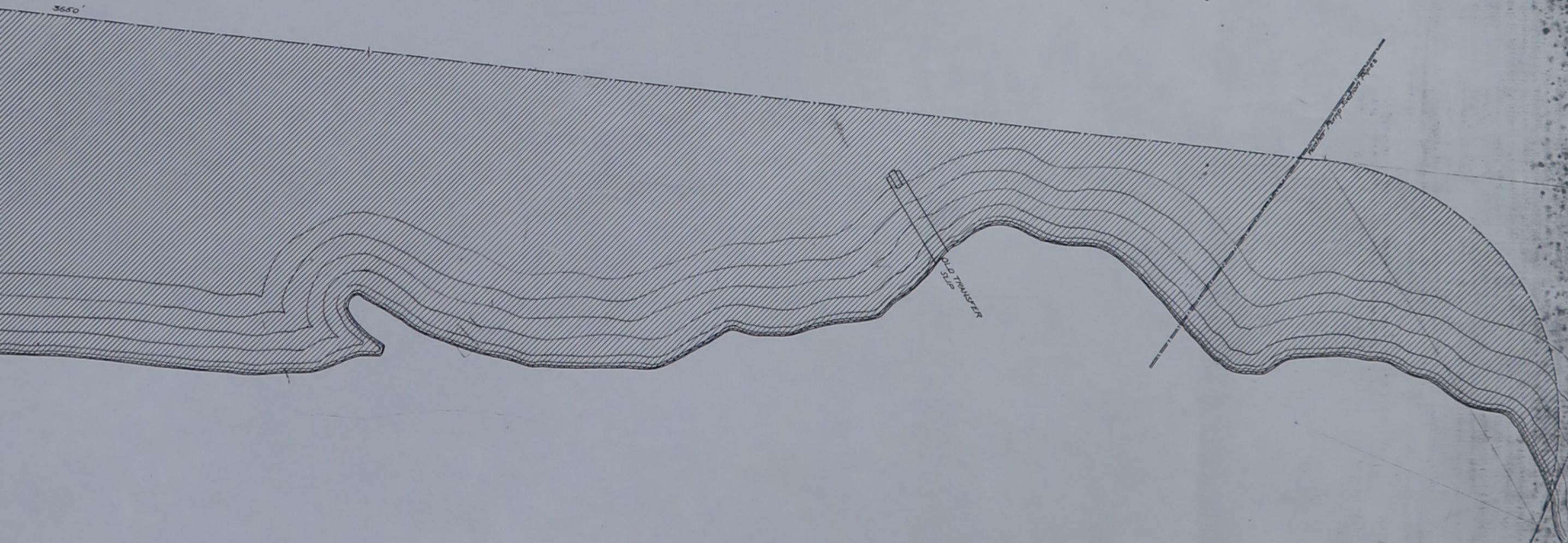

Boam - British Columbia: It's History, People, Commerce
Industries & Resources - 1912





THE FISHERIES

The company lease some very valuable clam beds in the neighbourhood of the Islands from the Provincial Government and have a clam cannery on the Queen Charlotte Islands with a capacity of 3,000 cases a month, each case containing 48 lb. They also have a number of seining licences for salmon and herring both round the islands and off the coast of the mainland.

At Calgary, Alta., the company have their own warehouse and fish market, from which they distribute their produce to various places on the prairies. They possess cool-room facilities for the storage of fish *en route* from Vancouver to interior points.

The company is under the management

of Mr. G. M. Alford, who has been connected with the fishing industry for 3 years.



THE NANAIMO FISH AND BAIT COMPANY, LTD.

The Nanaimo Fish and Bait Company, Ltd., is an amalgamation of the firms of Robinson and Stanall and Johnston and Rudd, who have been engaged in the herring industry since its inception some 15 years ago. Since then they have caught many thousands of tons of fish which are used as bait by vessels engaged in halibut fishing.

During the summer the company employ a fishing outfit in Northern British Columbia

waters in order to supply their customers when herring are unprocurable further south. They are also engaged in drysalting the fish for the Oriental market—an industry in which they have gained special prominence, their plant at Nanaimo being of the most modern type.

The company hold strong views on the question of Oriental labour, and although the fishing industry is one in which Japanese are almost exclusively employed, the employees of the Nanaimo Fish and Bait Company, Ltd., are all white men.

Mr. John Rudd, a partner in the former firm of Johnston and Rudd, is the managing director.



1. HERRING FISHERY BUILDINGS AT NANAIMO.



2. HERRING BOATS, NANAIMO HARBOUR.

CONTINUED FROM BELOW



CONTINUED ABOVE

SCALE 50 FT. = 1 INCH

SOURCE: _____
THIS COPY IS PROVIDED FOR
RESEARCH PURPOSES ONLY