

4844

Haney B.C.
OFFICE OF THE CUSTODIAN
JAPANESE SECTION

To be completed by persons of the Japanese race having property in any protected area. The proper administration of this property requires such persons to give full particulars as requested in this form.

PERSONAL INFORMATIONNAME: TANAKA YoshioHOME ADDRESS: 22nd Rd., 17th Ave., Haney B.C.REGISTRATION NUMBER 13720 SEX: Male AGE: 26OCCUPATION: J Millhand

(If any business or businesses carried on, state where, under what name and whether carried on by yourself or in partnership with anyone; if partnership, give partner's name.)

EMPLOYER: Farnridge Lumber Co. Haney B.C.MARRIED? YesNAME OF WIFE OR HUSBAND: KimiyoADDRESS OF WIFE OR HUSBAND: 22nd Rd., 17th Ave., Haney B.C.NAMES OF ANY LIVING CHILDREN: noneADDRESS OF CHILDREN: noneAGE OF CHILDREN: none**STATEMENT OF ALL REAL PROPERTY** (Each parcel must be mentioned and particulars given)

1. LOCATION AND DESCRIPTION: Lot 16, S.W. 1/4 of Section 22, Township 12, Map 3118, District of New Westminster B.C.

2. BUILDINGS AND OTHER IMPROVEMENTS: 2 Storey Dwelling House, 5 Rooms 1 Shed, 1 Wood Shed,

3. INSURANCE (Give particulars; state where policies are) North West Fire Insurance Co. \$1000.000 Policy No. 193925. Policy in declarant's possession.

4. TAXES (Amount and where payable) Taxes \$28.75. Payable at Maple Ridge B.C.

5. ENCUMBRANCES (Including any unregistered claims or deposit of title deed)

none6. OCCUPANCY AND LEASES (If vacant so state) Leased to William Peters,8 Months lease at \$10.00 per month.

7. STATE WHEREABOUTS OF TITLE DOCUMENTS: In declarants possession
8. STATE IF ANY OTHER PERSON HAS ANY INTEREST: none
9. IF FARM LAND STATE CROPS SOWN Raspberries, Blackberries,
33 Fruit Trees.

STATEMENT OF REAL PROPERTY OCCUPIED

1. LOCATION AND DESCRIPTION: See page 1, Section 2.
2. LANDLORD'S NAME AND ADDRESS:
3. PARTICULARS OF LEASE AND RENT AND DATE TO WHICH PAID:
4. STATE WHEREABOUTS OF LEASE:
5. SUB-TENANTS, IF ANY (Give name, address, rent and to what date paid)
6. IF FARM LAND, PARTICULARS OF CROPS SOWN:

STATEMENT OF PERSONAL PROPERTY OWNED:

1. GIVE BRIEF DESCRIPTION AND STATE LOCATION OF FURNITURE, FIXTURES, EQUIPMENT AND MACHINERY, STOCK IN TRADE AND PERSONAL EFFECTS:
none
2. HORSES, LIVESTOCK AND OTHER ANIMALS, POULTRY AND PETS
none
3. GIVE THE NAME AND ADDRESS OF ANY PERSON HAVING ANY INTEREST IN, OR CLAIM ON ANY SUCH PROPERTY none

4. INSURANCE CARRIED ON ABOVE PROPERTY: none5. MORTGAGES, LIENS AND OTHER CLAIMS ON PROPERTY IN POSSESSION OF
OTHERS: none6. MONEYS OWING TO YOU (State if any of these debts assigned and if so, to whom)
none7. BONDS, DEBENTURES, SHARES, STOCKS OR OTHER SECURITIES (State whereabouts)
\$25.00 War Savings Certificate. \$10.00 in War Savings Stamps. All in declarants possession.8. BANK ACCOUNTS: none9. LIFE INSURANCE: Sun Life Assurance Co. \$1000.00. Policy Number unknown.
In declarants possession.10. INTEREST IN ANY ESTATES OR TRUSTS: none11. SAFETY DEPOSIT BOX: none**LIABILITIES:**1. PERSONAL DEBTS: none2. TRADE DEBTS: none

I, the undersigned, hereby voluntarily turn over to the Custodian all my property in the protected area as set out above, excepting fishing vessels, deposits of money, shares of stock, debentures, bonds or other securities, if any.

I certify that the above information is true and complete and fully discloses all my property of every description in any protected area in British Columbia and sets forth all my liabilities direct and indirect.

Dated this 20th day of April 1942.

(Signature)

J. Tanaka

Witness

FOR DEPARTMENTAL USE

INFORMATION FROM R.C.M.P.

Date Jan 12/43

Full Name

TANAKA, Yoshio
(Surname in Block Letters)

Registration No.

13720

Male - Female
(check)

Age Oct 9, 1915

Former Address

22nd Road - 17th Avenue, Vancouver, B.C.

Date Evacuated

28/4/42

Naturalized - Canadian-Born - National
(check)

Present Address

Diamond City, Alberta (via Lethbridge)

Married - Single
(check)

Name of Wife TAKIMOTO, Kimie - 10854

Name of Husband

Name of Mother

YOSHIDA, Tamiyo - 13820

Name of Father

TANAKA, Soshichi - 13736

Names of Children under 16

Yoshiye Nancy (F) 31/7/42

Our File No.

4844

Registered with Custodian
(yes or no)

yes

Requested By

J. Kato

Additional Information

millhand.

REAL PROPERTY SUMMARY

File 4844

V.L.A. B.C. 178-P

JAPANESE NAME: Yoshio TANAKA - - Reg. No. 13720.

CATALOGUE NO: Part of The Director The Veterans' Land Act first offer.

PROPERTY ADDRESS: 2917 - 22nd Road, Haney, B. C.

LEGAL DESCRIPTION: Lot 16 of the Southwest quarter of Section 22 Township 12 Map 3118 Municipality of Maple Ridge in the District of New Westminster.

TITLE: In the name of Yoshio TANAKA.

ENCUMBRANCE: Vesting 25664 - 2nd April 1943.

ASSESSED VALUE: 1942 -
Land \$750.00
Improvements \$700.00 Total \$1450.00 Taxes \$32.15.

EXHIBIT NO. 764-6

DATE October 6-1948

FILED BY

Grace

CLASSIFICATION: Inspector reported January 15, 1943, a farm of 9.66 acres of which $1\frac{1}{2}$ were cleared. There were about 2 dozen small fruit trees. No other cultivation. A frame house of 2 storeys with cement basement 18 x 24, 4 rooms, good condition; woodshed 12 x 18, fair; chicken coop 8 x 10, fair. Property occupied at the date of inspection by William Peters.

HISTORY OF ADMINISTRATION: Leased by Yoshio TANAKA for 8 months period to the end of the year to William Peters, lessee to pay taxes for the year and for electric light. Taxes were paid on the 29th August 1942. TANAKA reported on the 20th April 1942, this property rented at a rate of \$10.00 per month but apparently this rental had been revised. Leased by the Secretary of State on the 8th March 1943 to Doris RADFORD for $8\frac{1}{2}$ months from the 15th March to the 31st December 1943 at a rental of \$8.00 per month with storage space reserved. Of this rental, \$48.00 was paid into the Custodian and allowed as accrued rental to The Director The Veterans' Land Act.

SOLD: To The Director The Veterans' Land Act for \$1105.00 as at 1st January 1943.
Approval of Advisory Committee 1st June 1943.

FUNDS: Released to the credit of Yoshio TANAKA, sale price \$1105.00 plus refund of insurance \$14.13, total \$1119.13; less insurance \$12.80, Certificate of Encumbrance \$1.00, registration fee \$3.00, legal fee \$15.00, total \$31.80. Net amount released \$1087.33.

TITLE: Included in C. of T. 170840-E and payment of consideration included in cheque to the Custodian dated March 14th, 1944.

OLD C. OF T. NO. 133972-E: In possession of Yoshio TANAKA.

The above summary is certified to be in accordance with the information on file and on record by accounting department.

DATED May 21, 1946.

IM:ML

John Macpherson

LIABILITY SUMMARY

File No. 4844

Re: TANAKA, Yoshio - Reg.No.13720

The above Japanese declared no liabilities and the only one that appears on this file is an account of the St. Michael General Hospital for \$41.60. This was sent to this office on April 10th, 1944 with TANAKA's request that it be paid. Payment was made on May 23rd, 1944.

This file reveals no other liabilities nor does that of his wife.

The above summary is certified to be in accordance with the information on file.

WEA:EH
May 13, 1946



FIRE INSURANCE SUMMARY

File No. 4824

Re: Yoshio TANAKA

Reg. No. 13720.

Insurance was carried by Yoshio TANAKA in the North West Fire Insurance Co., in the amount of \$800.00 expiring on the 18th April 1943. This policy was renewed by policy in the same company, 210034 - \$800.00 for 3 years expiring April 18, 1946.

This summary is certified to be in accordance with the information on file.

D. W. Thompson

DATED May 21st, 1946.

IM:NL

SPECIFIED ARTICLES SUMMARY

MEMORANDUM

To: File 4844

From: Specified Articles Department

July 17, 1943.

Re: TANAKA, Yoshio - Reg. 13720

<u>ARTICLE</u>	<u>DESCRIPTION</u>	<u>APPRAISED VALUE</u>
CAR	1941 Pontiac Sedan No. C-89 License No. (42) 60246	\$900.00

Sold to: R. C. M. P.

Selling Price: \$900.00

Amount of Lien: \$823.64

No Transfer papers on Car File.

EXHIBIT NO. 764-7

DATE October 6-1946

FILED BY J. H. Harris

Harker
Administration expenses of \$25.76 were also deducted from the sale proceeds leaving a net balance of \$50.60 which was credited to TANAKA's account on December 29, 1942.

Full details of sale were sent to TANAKA in our letter of January 17th, 1943.

The above summary is certified to be in accordance with the information on file.

WEA:EH
May 23, 1946

W. E. Lamm

PERSONAL PROPERTY SUMMARY

File No. 4844

Re: TANAKA, Yoshio - Reg.No.13720

CHATELS:

The above Japanese declared no chattels. Our fieldmen when making an inspection of the property inventoried some linoleum, a sink, axe and homemade table being on the premises belonging to the Japanese.

An inspection was made in 1944 regarding valuable chattels however the sink was a fixture, the axe missing, and the other two items were not worth the expense of handling, etc. They were accordingly abandoned on the property.

A quantity of lumber was sold and credited to this account however it was found that it actually belonged to his father and was accordingly transferred to his account on February 25, 1944.

ACCOUNTS RECEIVABLE:

The B. C. Electric Railway Company paid the sum of \$3.00 into this office to TANAKA's credit being a refund of his Security Deposit with them.

SPECIFIED ARTICLES:

TANAKA surrendered his car at Hastings Park. It was sold by the Custodian in accordance with the attached Specified Articles Schedule for \$900.00. The balance owing on the car on a Conditional Sales Agreement amounted to \$823.64 and after also deducting administration expenses of \$25.76, the remaining balance of \$50.60 was credited to TANAKA's account here.

BONDS & INVESTMENTS:

TANAKA declared holding \$35.00 worth of War Savings Certificates. These were not brought under control by the Custodian.

LIFE INSURANCE:

TANAKA declared having a \$1,000.00 Sun Life insurance policy. On April 28, 1944 the insurance company forwarded a Cash Surrender cheque through this office made payable to Yoshio TANAKA and his father as beneficiary. It was forwarded by this office.

This file reveals no other Personal Property assets.

The above summary is certified to be in accordance with the information on file.

WEA:EH
May 23, 1946

WE Hanson

(Information supplied by Ins. Co.)

LIFE INSURANCE

Name Yoshio TANAKA

File No. 4844

*Residential 9th
Alberta (Tan-Landbridge)*

Reg. No. 15920

Company Sun Life

Agency Vancouver

Policy No. 2100755

Premium - \$ 40.40

Payable: ^X Annually, Semi-annually or monthly

Month July Day 1

REMARKS:

Letter sent 27/8/43

Farm Appraisal Report

File No. J.L. 272

Land Description Lot 16 of S.W. $\frac{1}{4}$ Sec. 22, Tp. 12, Plan 3118.

Containing 2.00

Acres

Owner's Name Yoshi Taraka

Post Office Address R.R. #1, Haney.

Nearest Rail Point Haney - C.P.R.

Distance 2 $\frac{1}{2}$ MilesMarket Town Haney - 2 $\frac{1}{2}$ miles; New Westminster

Distance 23 "

Church (give denomination) All in Haney

Distance 2 $\frac{1}{2}$ "

Nearest School A. Robinson

Distance 1 "

State how property was identified: One post, road and map check.

Roads: State whether property has access to main road, the kind of road and its condition.

Yes, fronts on Baker Road; good municipal gravelled road.

Is this district a good one? Normally, yes.

Employment opportunity Limited to Cannery, Brickyard and 2 mills, 1 - 4 miles.

Predominating Nationality and religion: British; Protestant.

Describe Fencing and its condition: Nil.

Value \$

Water supply: Shallow domestic well; probably sufficient.

Value \$

BUILDINGS ON FARM

BUILDINGS	DIMENSIONS	MATERIAL	HEIGHT	ROOF	AGE	Foundation	REPAIR	VALUATION
HOUSE	20 x 24	Frame	16	Shale	5-6	Concrete	Good	\$ 1200.00
Woodshed	10 x 20	"	7	"	5-6	Wood	"	20.00
Shed	8 x 10	"	6	"	5-6	"	"	5.00
BARN	x							
	x							
BARN	x							
	x							
GRANARY	x							
	x							
	x							
	x							
	x							

Electric light installed.

Total present day value \$ 1225.00

Total Value Buildings add to farm

\$ 1000.00

Is dwelling habitable without repairs? Yes

If not what is your approximate estimate of cost to make it

habitable? Very nicely finished downstairs and in good shape generally. Now occupied by

Mrs. Peters and family.

\$

Describe the basement and chimneys: Full cement basement; brick chimney to ground.

No. rooms downstairs? 3 & pantry Upstairs? Attic How finished Papered and painted inside.

Are buildings painted? Not outside Condition of paint

Distance from nearest bush Quite close up.

Note: Particular care must be taken when examining and reporting on foundations, sills and roofs.

ACRES	LEVEL, UNDULATING, ROLLING OR HILLY	SOIL (State Depth)	SUB- SOIL	KIND AND QUALITY OF CROP	VALUE PER ACRE	TOTAL
.75	Level	Clay loam 8-10"	Clay	None	\$75	\$ 56.25
Area which can be cultivated without cost other than for breaking.						
	LEVEL, UNDULATING, ROLLING OR HILLY	SOIL (State Depth)	SUB- SOIL		VALUE PER ACRE	
Area which can be cultivated after a reasonable amount of clearing timber, stones, drainage, etc.						
	LEVEL, UNDULATING, ROLLING OR HILLY	SOIL (State Depth)	SUB- SOIL	NATURE OF RECLAMATION NECESSARY	RECLAMATION COST PER ACRE	VALUE PER ACRE
6.91	Level	Clay loam 8-10"	Clay	Clear bush heavy	\$150	\$10
						69.10
Area Unsuitable for Cultivation.						
	CHARACTER OF LAND E. G. HILLY, SWAMPY, ROCKY.			NATURE OF TIMBER IF ANY AND WHETHER MARKETABLE		VALUE OF LAND PER ACRE
Estimated 2	A large deep brush grown ravine; creek in bottom. General direction easterly and slightly south.					-

Total value of Land \$ 125.35

Total added by buildings to value of farm \$ 1000.00

Total fruit trees add to value of farm (for use in orchard districts only) \$

Total value of farm \$ 1125.35

Describe condition of farm commenting on tillage, length of time unoccupied or partly occupied:

House in very good repair and maintenance, and now rented for the taxes. The small clearing is grass grown; tiny garden started.

State most suitable type of agriculture for farm bearing in mind the district's limitations, if any.

Ready made home for pensioner or employed man.

Noxious weeds:

Not in evidence yet.

Give approximate detail and Municipality of Maple Ridge.
amount of all annual taxes and Land, school and library - \$32.15
names of Taxing Authorities:

Date: June 15, 1942.

Place: New Westminster, B.C.

I certify that the above report is based on a personal examination
of the whole farm made on the 11 day of June 19 42.

Inspector's Signature

"T. GODFREY"

Note: (Use Form 43 (Sheet 2) in connection with this form.)

Farm Appraisal Report

Remarks: Owner away; tenants in residence - Mr. W. Peters. His wife states they have the property for the payment of taxes and light.

This property is adjoining settler R.T. Franklin (D.I. 1970)

Estimated a minimum of 2 acres are lost in deep brush grown ravine.

Clearing is the usual operations necessary for logged off land now grown up to good alder domestic firewood.

(FOR ORCHARD LANDS ONLY)

REMARKS: re general lie of land, fertility of soil, irrigation, drainage or dyking and reclamation.

ANNUAL COST OF IRRIGATION, DYKING AND DRAINAGE.

ORCHARDS, SMALL FRUITS, ETC.

(Give number, age, variety and condition of all tree fruits, condition and area of each kind of small fruits.)

Present Value

	\$
	\$
	\$
	\$
	\$
	\$
	\$
	\$
	\$
	\$
	\$

Total \$

Amount fruit trees add to value of farm \$

Diagram of Property

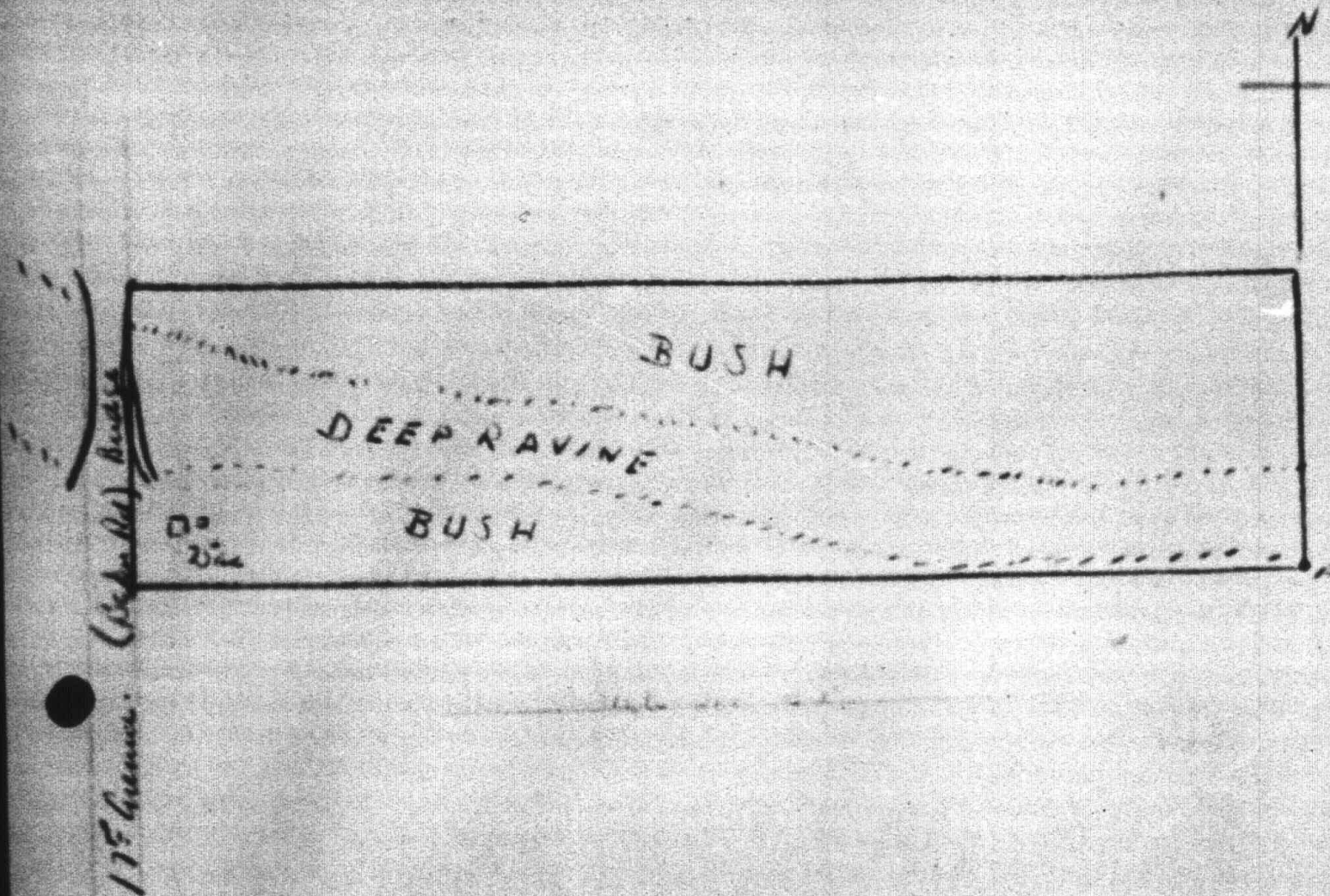

Following careful review of this appraisal report, it is my opinion that the present value is \$ 1100

Date 10th June 19 42.

"I.T. PAWNET"
District Superintendent.

4844
13720

SOLDIER SETTLEMENT and VETERANS' LAND ACT

File No. BC/178-P
(JL-272)

Vancouver, B.C.

A.G. Duncan Crux, Esq.,
Randall Building,
335 West Georgia St.,
Vancouver, B. C.

M. Alister

TANAKA, Yoshio

Dear Sir:-

Re: Lot 16, of the S.W. $\frac{1}{4}$, Sec. 22,
Twp. 12, Map 3118, MUNICIPALITY
OF MAPLE RIDGE.

I beg to acknowledge receipt of Duplicate
Certificate of Title No. 170840-E of the New Westminster
Land Registry Office for the above parcel of land in the
name of The Director, The Veterans' Land Act.

Included in the Veterans' Land Act cheque
for \$ 17,481.14, in favour of The Secretary of State,
forwarded to you and dated March 14th, 1944 is the
amount of the purchase price in full of the above land
arrived at as follows:-

Purchase Price	- \$ 1105.00 ✓
Less arrears of taxes to January 1st, 1943,	- \$ --
Amount paid to Secretary of State	- \$ 1105.00 ✓

Will you kindly acknowledge receipt of the
purchase price by signing the receipt on the duplicate hereof
and return it to me.

Yours truly,

T. J. Tedrick

T. J. Tedrick,
DISTRICT SOLICITOR

RECEIVED Cheque covering the purchase
price in full of the land above described.

MAY 12 1944

Date

Solicitor for
The Secretary of State

Canada

**DEPARTMENT OF THE SECRETARY OF STATE
OFFICE OF THE CUSTODIAN**

JAPANESE EVACUATION SECTION

File No. 4844
Reg. No. 13720

506 Royal Bank Building,
Vancouver, B. C.

Mr. Yoshio TANAKA,
c/o Mrs. E. Pedrini,
Diamond City, Alberta.

JUN - 5 1944

Dear Sir:

Re: 2917 - 22nd Road, Haney, B. C.
Mun. of Maple Ridge, Lot 16 of the S.W. $\frac{1}{4}$ of Sec. 22,
Twp. 12, Map 3118, Dis. of New Westminster, C. of B. 51562.

You have previously been advised that a sale of lands in rural districts was entered into between this Department and The Director, The Veterans' Land Act.

Due to the size of this transaction, the arrangements for same and the completion of the transfer have taken a considerable time. Negotiations were started in the early part of 1943 and were based upon valuations made by qualified appraisers and on the basis of a sale effective as at January 1st of that year. This means that the 1943 revenues from the property were for the benefit of the purchasers, but that taxes, fire insurance and other operating charges were assumed by them.

The following is a statement showing the sale price and adjustments:

Sale price of above described property	\$ 1105.00
Add:	
Unexpired insurance premium as at January 1st, 1943	1.33
	<u>1106.33</u>
Less:	
Tax arrears to December 31st, 1942	\$
Registration fee	3.00
Encumbrance—Principal	
—Interest	3.00
Net proceeds of sale	\$ <u>1103.33</u>

This amount has been placed to your credit and a statement of your account is endorsed hereon showing the present balance on our books. A small amount for legal fees in connection with the conveyance to the Veterans' land will be charged later.

Yours truly,

F. G. SHEARS,
Director.

R

1943

Jan. 1

Balance brought forward

Debit

Credit

Balance

\$ 50.60

\$ 50.60 CR

Credit re Sale of Property

1103.33

Land Registry Office C/E

\$ 1.00

June 21

Cheque to you

35.00

1944

Feb. 6

" " "

67.80

\$103.80

\$1153.93

CR \$1050.13

May 26

St. Michael's General Hospital
settlement of claim

41.60

CR \$1,008.53

MEMORANDUM RE SALE OF CHATTELS

(Apart from Auction Sales)

FILE NO: 4844

NAME: TANAKA Yoshio

DATE ADVERTISED: _____
(or other information)

APPRAISER'S NAME: S. PALLOT

VALUATION: \$20.00

PURCHASE PRICE: \$20.00

COMMITTEE'S APPROVAL: March 8th, 1944

PURCHASER'S FULL NAME: H. TELEP

ADDRESS: Haney, B.C.

OCCUPATION:

BILL OF SALE REQUIRED: YES NO
(state if purchase price already paid or arrangements made) Paid in full

ENCUMBRANCES, IF ANY: _____

LIST OF CHATTELS SOLD: Quantity of lumber.

See memo on file Feb. 25, 1944. Lumber in question found to belong to Soshichi TANAKA - File 4840 and proceeds transferred.

INVENTORY OF CHATTELS BELONGING

TO

TANAKA, Yoshio

13720

4844

Which have been left in the care of: Thomas MAHONEY: 2917 - 22nd. Rd.
HANEY, D.C.

IN HOUSE UPSTAIRS

- 5 Beds complete & 1 Bunk & 1 Mattress ✓
- 1 Cupboard cont. Crtn of bowls, 1 Set cream & sugar & Tea pot, 1 Sm. Hardwood case, Sm. Crtn tied, Crtn of old ties, 7 Pictures (2 with frames) ✓
- 3 Boxes & 1 Crtn. of dishes ✓
- 1 Roll of green wrapping paper ✓
- 1 Bag of paper plates ✓
- 1 Aluminum frying pan ✓
- 1 Box of books & Knives ✓
- 1 Crtn. cont. 3 pres. wool carders, 1 Electric "DARSHOVAL" machine in case ✓
- 1 G.E. Vacuum cleaner ✓ 7 att. in box & hose ✓
- 1 Electric toaster ✓
- 4 Gal. MARTIN BR. Paint ✓
- Sm. crtn of rags ✓
- 1 Large & 2 Sm. Crtns. tied ✓
- Single hole Electric hot plate ✓
- 1 GENE Electric heater ✓
- 37 Gramophone records in case ✓
- Vase ✓
- Crtn. of pers. effects ✓
- 1 Crtn of religious matter ✓
- 1 " Jap papers ✓
- 1 Salesmans display case ✓
- 1 School case of books ✓
- 1 Sm. sieve ✓
- 1 Crtn. of large lamp shades ✓
- 1 Large table mat ✓
- 1 Large chest cont. 3 Crtns. of rags ✓
- man. of wrapping paper ✓
- 2 Sm. trays ✓
- 1 Brass tea pot ✓
- 2 Wooden trays ✓
- Sm. crtns. Dishes ✓
- 13 Crtns. tied ✓
- 2 Windowscreens ✓
- Sm. crtns. of wrapping paper ✓
- Small quan. of loose school books ✓
- 1 Sm. bed warmer ✓
- Sm. crtn. cont. 2 sm. pictur s, cigarette lighter, 1 hand bag of rags & or n. of sake cups, tea pot stand & few knives & forks. ✓
- 1 Large box cont. 11 st ✓
- 3 Boxes clothes ✓
- 1 Drawer cont. scissors, few dishes, hot water bottle, & few lids ✓
- 1 Carton stuffed s, & few clothes, & 4 cartons of clothes ✓
- 1 Box sock tops ✓
- 1 Round jar box cont. quantity of rags etc. ✓
- 1 Shallow cont. box lamp shade, 2 flashlights, & personal effects ✓
- 12 Rolls building paper ✓
- 2 Boxes of short lumber pieces ✓
- 3 Bundles of flooring, & quant. mixed lumber ✓
- 4 10" x 5" panels, for doors ✓
- 2 Small tins of oil ✓
- 1 Box waters nail holder & case ✓

The above chattels have been left in my care by the owner, and I will be responsible for the safe keeping.

WITNESSES:

Thomas Mahoney

SIGNED

Office of Custodian

Dated this 11th Day of December, 1942

Incubator house

- 1 Peevce
 2 Hay forks
 3 Spades
 1 Crow bar
 8 Hoes with one broken handle
 1 spud digger
 1 shovel
 1 Plow
 1 Horse cultivator
 7 Jap cycles *N.V. on property*
 2 'Charter Incubators' & 2 small incubators
 11 Jap tubs
 1 Gas lantern
 1 Photo safe light
 1 Snake bellows
 1 Basket of printing stamps
 1 Roll of line
 7 Windows
 1 20 Gal. copper tub with screen churn *many scratches*
 2 Cartons of sake bottles *N. Value left on property*
 2 1 Gal. crock jugs
 1 Red pen *N. Value*
 1 Lamp base
 1 Small single holed oil stove
 10 Bee boxes & quantity of wax coating *on property*
 1 Milk can & 2 4 Gal. oil cans of roofing fluid & 2 brushes
 2 Egg crates
 5 x cut saws marked 'H ISINAGA' *NOTE*
 IN TOP OF INCUBATOR HOUSE: Plant. of mixed boxes etc. 1 car radiator,
 1 metal lamp base, & 1 box of bottles

CHICKEN HOUSE

- 4 Brooder tops, 1 lantern, no chimney

IN PUMP HOUSE

- 1 Beatty electric pump & tank one lantern *left on property*

STUBBARD HOUSE: 1 Old drum heater *(N.V. left on property)*IN BARN: *on property N.V.* quantity of hay, & set of harness & tugsIN ROOF HOUSE

- 6 qt. sealers & 10 pieces of 6" sewer pipe
 1 Pail & 1 milk can used for white wash *left on property*

LEAN TO

- 2000' used lumber & 1 ladder, not picked up *N.V. left on property*
 2 Boxes of tin stripping & 4 bundles of new lumber
 1 small roll of line, & 1 pail & box of sake bottles

OUTSIDE

- quantity of chicken wire netting, *N.V. left on property*
 18 Window frames 3 x 5' & few panes
 1600' lumber, 2 wheel barrows, 1 wash tub, & 1 rocking chair
 1 Radio aerial, clothesline, large quantity of raspberry posts
 & wire *left*

NOTICE: Approximately 24 light bulbs on property *left on property*

The above articles have been left in my care by the owner, and I will be responsible for their safe keeping.

WITNESS

SIGNED

Office of Custodian

Witness the 4th Day of December 1942

4844

INVENTORY

- 1 Gal gas tin of coal oil ✓
 2 Gal. barrow wheels ✓
 3 Sedges & 2 Trowls & 1 Free ✓
 1 Stirrup pump (H.V.) ✓
 7 Jap sickles ✓
 Gal. quan. of misc. parts & metal ✓
 1 30x16 Tire (fair cond.) *personal*
 2 X cut saws ✓
 1 Box Cutting Machine mounted *left on property*
 1 Gal. lantern ✓
 1 Grtn. cont. 5 Lamp chimneys ✓
 Gal. quan. of Cascara bark *Value - very old*
 5 Jap ~~boxes~~ boxes of books & magazines & 2 Cartons ✓
 1 Box cont. few bottles & toys ✓
 1 Large quger ✓
 App. 80 new fire brick ✓
 1 Enamel wash basin of papers etc. ✓
 1 Wooden barrel ✓
 Large box of old shoes *Value - left on property*
 1 Grtn. of bean & seeds *left on property*
 1 Wire stitching machine & gal. quan. of wire *left on property*
 2 Pss. old gumboots ✓
 App. 30' of old hose (red) & Gal. quan. of black hose ✓
 3 Mounted clapping machines (2 Home made) & extra set of Jaws, for tin
 ridge of tomato boxes *left on property*
 1 Hand cultivator & 3 Att. ✓
 1 Box metal parts et c. ✓
 Quan. of unassembled Tomato boxes *left on property*
 Part roll of chicken wire netting ✓
 1 Vice & block ✓
 1 New roll tar paper ✓
 1 Part roll green wrapping paper ✓
 1 Piece of 1" x 12' Galv. pipe ✓
 17 Pieces of 1/2" pipe random lengths ✓
 1 16" x 22" pipe with filter ✓
 1 Bag crushed shell *Value*
 2 Biscuit tins of oil & books ✓
 1 Tins 4 gals. per of refined RAPE seed oil ✓
 4 Large enamel platters ✓
 2 Thermos bottles ✓
 17 Sake bottles *left*
 1 Granite pot ✓
 1 Gal. crock ✓
 1 Large bake pan ✓
 1 Wrapped jap tub ✓
 1 Cement rice crusher bowl ✓
 1 Cabinet cont. 2 baskets, 1 seive, 4 piece jap bowl, 3 qt. sealers
 1 enamel & 1 iron pot, 1 therm s jug ✓
 1 Homemade flower box ✓
 1 Wash stand ✓
 5 qt. sealers ✓
 1 Part roll tar paper ✓
 1 Fire mat ✓
 2 Large rolls & 1 small roll of insulated wire ✓
 1 Sprinkler can ✓
 2 Hay & 1 manure forks ✓
 3 Hoes ✓
 2 Spades with broken handles ✓
 2 Shovels ✓
 1 Spud digger ✓

*Metal box
left
where on list*

The above articles have been left in my care by the owner, and I will be responsible for their safe keeping.

WITNESSED *Harlan* SIGNED _____

Office of Custodian

Dated this 11th Day of November 1942

✓ 4844

Godshed

- 1 Buck saw no handle ✓
- 2 Hoes with broken handles ✓
- 1 Sledge hammer head ✓
- 1 Carton of seeds *N.V. value.*
- 1 Gal. crock jug ✓
- 1 Chick fountain ✓
- App. 500 lbs. of barrie wire ✓
- Quantity of box shooks *left on property*
- 5 Boxes of parts & metal pieces *N.V. left on property.*
- 1 Small window ✓
- 2 Old folding camp cot springs *N.V. left on property*
- 1 Copper wash boiler *left on property N.B.*
- 1 Screened cooler *N.V. value.*
- 1 straw trunk *N.V. value.*
- 1 Bed spring *N.V. value.*
- 10 Jam crated & 15 pickers trays *left on property all over property*
- 3 Homemade tables *left on property not worth picking up many old.*
- 1 40 oil drum (IMPERIAL) *left on property*

UNDER BACKY PORCH

- 11 Cartons of sake bottles *left on property*
- 1 Part bag stucco *N.V. value.*
- 3 1 Gal. crock jugs ✓
- 1 Food cooler *rated on left.*
- 3 Bundles of shingles *needed for repairs - left on property.*
- 7 Jap tubs ✓
- 3 Old aluminum pots ✓
- 2 Spades one with no handle ✓
- 8 Picker trays *left on property.*

STONE ROOM

- 2 x out saws, 2 two $\frac{1}{2}$ x out saws ✓
- 1 Lantern ✓
- 2 Rolls of roofing paper ✓
- 10 boxes, 1 carton, 1 tin, & 1 sack of sake bottles *left on property N.V.*
- 4 Brooder stoves ✓
- 5 Jap tubs ✓
- 2 Boxes of bicycle & car parts ✓
- 1 Old car lock *N.V. value left on property.*
- 1 Box of insulators ✓
- 1 Large roll of $\frac{1}{2}$ " cable & 3 hooks ✓
- 1 4 Gal. oil can ✓
- 1 Mattock ✓
- 1 Post hole digger ✓
- 2 Old car rims *N.V. value - on property*
- 1 Car chain ✓
- 1 Cow bell ✓
- 1 Mattock & 2 mattock heads ✓
- 1 Grub hoe head, large quant. of metal pieces & pipes ✓

INCUBATOR HOUSE

- 1 Brush hook ✓
- 4 B.D. axes ✓
- 4 Mattocks ✓

These articles have been left in my care by the owner, and I will responsible for their safe keeping.

WITNESS

[Signature]

SIGNED

Officer of Custodian

Dec 11th 1942

✓ 4844

CONTINUED INVENTORY RE: TANAKA, Yoshio # 13720

BASEMENT

- 1 Crow bar & 1 scythe ✓
- 10 Bundles of flooring ✓
- 1 New X cut saw ✓
- 1 Old sawn timber table & bench moved by Tanaka ✓
- 5 Wooden flour pots ✓
- 1 2 Gal. gas tin ✓
- 1 Enamel pot ✓
- 1 Alarm clock ✓
- 2 240 lbs. platform scales ✓
- 1 Old kitchen range (N.V. left on property) ✓
- 1 Mounted asparagus knife ✓
- 1 Small fire shovel ✓
- 2 Jap tubs ✓
- 1 Glass wash board ✓
- 1 Model S.M. BEATTY washing machine ✓
- 3 Pails 1 wooden *N.V. on property* ✓
- 3 Old wheels & rims & one frame for bicycle ✓
- 1 Small sack of cascara bark ✓
- 2 Boat water pumps ✓
- 3 Axes, & 2 axe heads ✓
- 5 Old D.B. axe heads & 2 d.b. axes, one with broken handle ✓
- 1 Small pressure tank & gauge ✓
- 1 Tool chest cont. 1 adze, 2 saw sets, brace & 3 bits, pinch bar, 2 hammers, 4 chisels, 3 pairs of plyers, 1 pair of hedge clippers, 1 jap saw, coal chisels, 3 unches, 1 machine hammer head, spirit level, 1 small bottle of shalac ✓
- 2 X cut saws ✓
- 1 Wooden square ✓
- 3 Plaster & 1 garden trowel ✓
- 1 Small box cont. 2 clothes line pulleys, small quant. of shingle nails & one wet stone ✓
- 3 Small boxes cont. few metal parts, & misc. pieces ✓
- 1 Box cont. door lock set, few old tools, & short handled sledge hammer, 3 homemade planes wooden ✓
- 1 Telescope fishing rod & reel ✓
- 1 Spray tank nozzle & 10 ft. of red hose ✓
- 1 Egg crate comp. *used for shipping* ✓
- 1 Furness made of brick & oil drum *left on property* ✓
- App. 145 box bottoms & sides *left on property* ✓
- App. 70 bundles of box rims ✓
- 2 Boxes rags ✓
- 1 Loose door ✓
- Few pieces of misc. boards ✓

CHATELS MARKED HISANAGA, Vancouver, B. C.

- 1 Locked trunk *Pers*
- 2 Large boxes nailed *Pers*
- 7 Boxes nailed *Pers*
- 2 Cartons tied *Pers*
- 1 Bundle tied *Pers*
- 3 Beds complete & sold *last auction*
- 1 Extra spring *sold*

The above articles have been left in my care by the owner, and I will be responsible for their safe keeping.

WITNESS *G. Carlson* SIGNED _____

Office of Custodian

Dated the 11th Day of December 1942

4844

MAIN FLOOR

- 3 Ortns. tied ✓
- 2 Sal. Dolls in Ortns. & few bc oke, Bottle of LAVORIS antiseptic ✓
- 6 Fancy new cushions ✓
- 1 Large bndl. of bedding ✓
- 1 Glass box cont. Jap doll *shipped* ✓
- 2 Parcels tied ✓
- 3 Ortns. cont. Large vase, 3 Wicker baskets ✓
- 1 Ortn. cont. Sal. table Microphone & quan. electricale equipment. ✓
- 1 Sal. hardwood table ✓
- 1 Glass specimen case cont. 4 birds of paradise mounted on table. ✓
- 1 Bamboo bowl case cont. 2 Sal. ornaments & 10 Volumes of the "CONCISE" Encyclopedia & 2 of the "CONCISE" Dictionary *shipped books* ✓
- 2 Standard ash tray ✓
- 4 Sal. plant stands ✓
- 1 Wooden pot ✓
- 1 3 Piece Chesterfield suite ✓
- 1 Dining table & 6 Chairs ✓
- 1 TRILIGHT lamp ✓
- 2 Linoleum squares ✓
- 6 Pictures in frames ✓
- 3 Volumes of the "DOMINION" Educator ✓
- 3 Vases ✓
- 1 "MAUIHE" Chime clock *shipped* ✓
- 1 Sal. fish bowl on 3 legs ✓
- 1 Novel table lamp ✓
- 2 Light fixtures *left on property* ✓
- 1 Shrine complete with quan. of r ligous matter, wooden trays & glass bowl ✓
- 1 Cupboard cont. quan. of books, magazines, Pers. pprs., shoes, Childrens toys & can of tobacco. ✓
- 3 Cushions ✓
- 1 Roll top desk cont. large qu n. of pers pprs. & effects. ✓
- 1 Modern bath room in cluding: 1 Toilet & basin ✓
- ~~3 Dressing rooms~~ *shipped listed*
- 1 Large H.M. table ✓
- 1 Leather couch ✓
- 1 Gramophone & 75 R records ✓
- 1 Sal. wall cabinet *left on property fixture* ✓
- 6 Kitchen chairs ✓
- 1 Kitchen cabinet with drawers ✓
- 1 H.M. Bench ✓
- 1 Kitchen mantle clock ✓
- 1 Kitchen range with sawdust burner ✓
- 1 Built in ironing board with mirror on door *left on property fixture* ✓
- 1 Side board with mirror ~~shipped~~ ✓
- 2 Sal. cabinets *fixtures left on property* ✓
- 1 Pantry with built in sink & very up to date fixtures ✓
- Part linoleum on kitchen & pantry floors ✓
- 1 Clothes dryer ✓
- 1 Rocking chair ✓
- 1 Fibre & 1 Hair brooms ✓

BASEMENT

- 1 Keg of 2 1/2" Common nails ✓
- 1 Sledge hammer ✓
- 1 Key hole saw ✓
- 1 Hack saw ✓
- Sal. roll blasting fuse ✓
- 1 Old cupboard cont. few old shoes ✓
- 1 H.M. Fruit cabinet ✓
- 1 Sal. mat ✓
- 1 Tin cont. 9 old brushes ✓
- 1 Electric switch & fuse Box. ✓

The above articles have been left in my care by the owner, and I will be responsible for their safe keeping.

WITNESS

[Signature]

SIGNED

Office of Custodian

Dated the 11th Day of December 1942

IN HOUSE UPS AIRS

- 1 Carton cont. set of ear chains ✓
- 1 Travel & quantity of insulated wire ✓
- 1 Small grinder mounted ✓
- 3 Cartons needles *N Value* ✓
- 1 New 100lb. sack rice *shipped* ✓
- 1 Jap basket cont. tea kettle, frying pan, & small cartons cont. sewing machine, stationery ✓
- 1 Shop in basket ✓
- 1 Small carton cont. few noodles ✓ *N Value*
- 1 Small carton cont. bean seeds ✓ *undecid.*
- 1 Jap basket cont. old books ✓
- 1 Carton cont. 3 hats ✓
- 2 Boxes & 2 cartons of Xmas decorations ✓
- 1 Carton books ✓
- 1 Carton cont. personal effects ✓
- 1 Cabinet cont. books & magazines ✓
- 2 Cartons books ✓
- 2 Dining chairs & 3 kitchen chairs ✓
- 1 Electric lamp & shade ✓
- 1 Large & 1 small homemade tables ✓
- 1 Dresser with mirror cont. few personal effects, 1 cushion ✓
- 1 & small quantity of clothes 1 carton of ties, & 1 long extension cord ✓
- 1 Small carton cont. 2 games, 1 picture, few books, and small carton cont. 2 small compasses, cigarette, compact, and 2 cig. lighters ✓
- 1 Carton patterns ✓
- 1 Parcel tied ✓
- Quantity of empty cartons *with property* ✓
- Small box cont. bicycle lamp and quantity of ladies personal effects ✓
- 1 Carton of cream sickle wrappers ✓
- 1 Carton cont. small kitchen utensils wrapped ✓
- 3 Metal tape measures in carton ✓
- 1 Carton of beads etc. ✓
- 1 Small carton of scribblers ✓
- 1 Small carton cont. ladies shoes & Jap lantern ✓
- 1 NATIONAL electric shaver ✓
- 1 Carton of clothes, 6 caps ✓
- 1 Leather hand bag ✓
- 1 Carton personal papers ✓
- 1 Jap medical board ✓
- 1 Flashlight ✓
- 1 Large carton of empty cartons & clothes ✓
- 1 Chest of drawers cont. 1 small tin cont. pieces of old ring with pearl & 2 pieces of copper etc. & odds & ends ✓
- 1 Jap novelty pipe & tobacco pipe ✓
- 1 Wooden tray ✓
- 1 Bowl ✓
- Quantity of tissue paper 1 & d paper ✓
- Small purse ✓
- 1 Carton cont. hair clippers, novelty pen holder, & 3 small vases ✓
- 1 Carton of Xmas papers, 2 cartons clothes & quantity of clothes ✓
- 10 Jap books ✓
- 1 Ornamental figure ✓
- 2 Volumes of Jap books ✓
- 2 Small cartons of books & games ✓
- 1 Hot water bottle in carton ✓
- 1 Carton of patterns & magazines ✓
- 1 Carton cont. money bank, 2 packages dye & odds & ends ✓
- 1 *Electric curling tong* ✓

The above articles have been left in my care, by the owner, and I will be responsible for their safe keeping.

WITNESSES

SIGNED

Office of Custodian

Dated this 11th Day of December, 1942.

IN HOUSE UPSTAIRS

- 1 Carton personal papers & clothes ✓
- 1 Carton cont. pen & 2 cigarette lighters, metal rule, few school supplies, 2 packages new pencils, & few lantern slides ✓
- 6 Parcels wrapped ✓
- 3 Bundles coat hangers ✓
- 1 Flat box cont. personal effects & papers, & 2 patterns ✓
- 1 Bamboo plant stand ✓
- 1 Electric lamp ✓
- 1 Large carton cont. 1 G.R. apron, 2 small cases ✓
- 1 Carton cont. doll, pictures, in frames, & quantity of paper ✓
- 1 Small carton of religious matter ✓
- 1 Wooden tray ✓
- 1 Small shrine ✓
- 1 Small money box ✓
- 1 Small basket of personal effects ✓
- 2 Small cartons ties etc. ✓
- 1 Carton of 3 light bulbs etc. ✓
- 1 School case ✓
- 1 Split bamboo rod tied ✓
- 1 Carton cont. large quantity electrical supplies ✓
- 1 Carton containing photographs, personal papers, & small quantity sewing equipment ✓
- 1 Carton of table clothes ✓
- 1 Small cabinet cont. few books, patterns, & personal papers, etc. ✓
- 3 Cartons books, magazines, & 1 lamp shade ✓
- 1 Carton cont. rags & small mirror ✓
- 1 Electric iron & cord *This item has been given in care to J. Morgan of the Custodian's Office Jan 15/42*
- 1 Carton of patterns & ladies compact ✓
- 10 Ladies dresses, 2 coats, & 1 suit on hangers ✓
- 1 Carton of rugs, 1 Carton personal papers, & 1 carton cont. jap mandolin in pieces ✓
- 1 Carton cont. 2 fancy jap boxes, & quantity of chop sticks ✓
- 1 Carton cont. butterfly specimens, & 2 ladies purses, small quant. photographs, hat pin, few jap cards etc. ✓
- 1 Box cont. small quant. dishes & clothes ✓
- 1 Basket & small carton of clothes ✓
- 1 SINGER sewing machine, containing patterns, buttons etc. ✓
- 1 Large carton cont. clothes, & 1 basket ✓
- 1 Fishing rod ✓

MAIN FLOOR

- 1 3 piece bedroom suite & mattress (bed, dresser & stool) *shipped* ✓
- 1 Wardrob, 1 small vase, & two bed lamps & 1 shade ✓
- 1 Bed table, lamp, & 2 vases ✓
- 3 Small rugs ✓
- 1 Stool ✓
- 13 Pairs of curtains & 9 blinds ✓
- 1 Hall seat with mirror ✓
- 1 Single bed comp. with mattress ✓
- 1 Telephone ✓
- 2 SINGER sewing machines, (one new) *shipped 2-1 defk* ✓
- 1 Fibre mat & 3 window screens ✓
- 1 Bed lamp, ~~2 shades~~, & 1 Aladdin lamp ✓
- 1 Glass cabinet cont. 7 bamboo pots, 1 wooden plant stand, few books & curtains *shipped* ✓
- 1 Volume of the 'GOLDEN' encyclopedia ✓
- 3 Volumes of women's Hygiene ✓
- 1 Bed tea tray ✓
- 4 White glasses & 2 trays ✓
- 2 Wooden trays ✓
- 3 Small baskets & 1 fish bowl ✓
- 1 Carton of decorations ✓
- 4 Pictures & frames ✓
- 4 White bow ties ✓
- 1 Buffet cont. 2 hats, 2 vases, 1 plush box cont. fancy bowl, 1 box of colored twine, small fancy jap box, small carton of hat decorations, ladies purse, tie & scarf set new, carton of thread & sewing materials, combs, etc. ✓

The above articles have been left in my care by the owner, and I will be responsible for their safe keeping.

WITNESS

[Signature]

SIGNED

Office of Custodian

Dated this 11th day of December 1942

Jan. 21, 1944

Re CHATTELS OWNED BY TANAKA, Yoshio #13720
8917-Bend. Rd., Haney, B.C. J. A. #13720

File

The following articles were appraised by S. Pallot, and sold to Mr. N. Telep, Haney, B.C.

Quantity of lumber, approx 1000'	\$15.00
" of used lumber	<u>5.00</u>
TOTAL PRICE	
Less 10% appraisal fee	\$20.00
	<u>2.00</u>
^{Net} TOTAL sale price	\$18.00

I HEREBY CERTIFY THAT the above prices of Chattels appraised by me are a true value.

S. Pallot

Submitted and approved by the Advisory Committee dated 8th March, 1944.

[Signature]

File No. 4844
4840

February 25, 1944.

MEMORANDUM

To: Accounting Department.

From: Mr. Green.

Re: TANAKA, Yoshio - Reg. No. 13720 - File 4844
TANAKA, Shoshichi - Reg. No. 13736 - File 4840

About 1000³ of lumber and some used lumber were sold to N. Tolop, Hancy and credited to TANAKA, Yoshio, File 4844. As this lumber does not belong to Yoshio but to his father Shoshichi, would you please transfer the proceeds to Shoshichi's account - File 4840.

CG.

R E P O R T
ON EVACUATED JAPANESE PROPERTY

File No. _____

MUNICIPALITY: MAPLE RIDGE.

Date: Jan. 15, 1943.

NAME: TANAKA, Yoshio

REGISTRATION NO. 13720.

ADDRESS: 2917-22nd. Rd., Haney, B.C.

PROPERTY: 1st. house south of 22nd. on east side of 17th. Ave., Haney, BC

ACREAGE: 9.66 $1\frac{1}{2}$ acres cleared.

KIND OF CROPS:

Fruit Trees.

APPROXIMATE ACREAGE OF EACH:

2 Doz. sml.

HOUSE: 2 Storeys.

VACANT:

OCCUPIED: Yes, by W. Peters.

DESCRIPTION: Frame, siding.
Cement basement.

ROOF: Shingle.

SIZE: 18' x 24'

NO. OF ROOMS: 4. 3-DS-1-US

CONDITION: Good.

OTHER BUILDINGS: Woodshed 12' x 18' (Fair) Chicken coop. 8' x 10' (Fair).

NAME OF LESSEE OR RENTOR: William Peters.

TERMS: Taxes & light bills, for duration. Agreement made with owner.

WATER: Well.

ON:

OFF:

LIGHT: Yes.

ON: Yes.

OFF:

REMARKS: Upstairs not finished, in good condition generally, house has not been painted.

INVENTORY OF CHATTELS LEFT ON PROPERTY:

In house. (downstairs)

1 Linoleum rug. (on floor)

1 Porcelain kitchen sink.

1 DB axe.

In basement.

1 Table. (HM)

Signed:

J. Morrison
W. G. Stinson

H2 12169

The undersigned seller hereby sells and the undersigned purchaser or purchasers, jointly and severally hereby purchase(s) and agree to pay for, subject to the terms and conditions hereinafter set forth, the following property, delivery and acceptance of which is hereby acknowledged by the purchase or purchases and is subject to the terms and conditions of the contract.

Year	Model	Chassis	Body	Engine	Model Letter or Number	Motor No.	Manufacturer's Serial No.
1941	6	Pontiac	Sedan	2219	33438	1221900631	

RADIO: Make _____ Model _____ Serial No. _____ **Utility Trailer:** Make _____ Model _____ Serial No. _____

Payable at the office of General Motors Acceptance Corporation to be hereafter designated in instalments of on the same day of each successive month, or as indicated in schedule of payments below, and commencing

The final instalment payable hereunder shall equal the amount of the deferred balance remaining due. Interest is due thereon after maturity of each instalment at 10% per annum. If this contract is placed with a Solicitor for collection, the purchaser further agrees to pay 15% of the amount due hereunder as Solicitor's fees, or if prohibited, the amount permitted by law (it being understood that the purchaser agrees to pay all costs, charges, expenses and disbursements, including the Solicitor and Client costs of the Seller's Solicitor and shall pay the ordinary collection charges of Solicitors and shall not be limited to any tariff provided by laws to apply to between party and party).

1	Mo. after date
2	Mo. after date
3	Mo. after date
4	Mo. after date
5	Mo. after date
6	Mo. after date
7	Mo. after date
8	Mo. after date
9	Mo. after date
10	Mo. after date
11	Mo. after date
12	Mo. after date

$$24 \times 47 \overset{47}{\underline{\quad}}$$

1. Title to said property shall not pass to the Purchaser until the entire purchase price and interest (and all costs and expenses) are fully paid in cash, this to include the payment of any judgments secured.

3. No transfer, renewal, extension or assignment of this contract or any interest therein or loss, injury, confiscation, damage or destruction (whether caused by fire, theft or otherwise) to or of said property shall release the Purchaser from his obligations hereunder. The assignee shall be entitled to all the rights of the Seller.

4. In the event the Purchaser defaults on any payment or fails to comply with any condition of this contract and/or any other contract held by Seller or Assignee of this contract or proceeding in bankruptcy, receivership or insolvency be instituted against the Purchaser or the property, or the property is confiscated, seized or misused, or the Seller deems the property in danger of seizure, seizure or confiscation, the full amount shall be immediately due and payable. The Seller's acceptance, after the full amount may have become immediately due and payable as hereinbefore provided, of any installment or payment shall not be deemed to alter or affect the Purchaser's obligations and/or the Seller's rights hereunder with respect to any subsequent payments or default therein.

4. No conditions, warranties or representations, expressed or implied, statutory or otherwise, have been made by the Seller, its officers or agents, shall any agreement collateral hereto be binding upon the Seller, unless endorsed hereon in writing. The term, wherever used in this contract shall include any equipment, attachments, accessories and repairs placed on or attached to said property by the Purchaser.

[illegible]

6. Time is of the essence of this contract, and if the Purchaser default in complying with the terms and conditions herein or the property is confiscated, seized, or impounded or the Seller deems the property in danger of seizure, seizure or confiscation, the Seller may take immediate possession of said property without demand (possession after default being unlawful), including any equipment, attachments or accessories thereto, and for this purpose Seller may enter upon the premises where said property may be and remove same.

7. Seller may reveal the said property to such persons as he may desire, and may show the premises where said property may be and remove same. The Purchaser (if given notice by mail as set forth below) being sufficient) with or without having said property at place of sale, and upon such terms and in such manner as Seller may determine, and the results of such sale shall be such results as Seller deems necessary. The Seller may bid at any public sale. From the proceeds of any such sale Seller may deduct all costs and expenses incurred in advertising, preparing and selling said property, including the costs of the Seller's Solicitor as between Solicitor and Client and the balance of the proceeds shall be paid to the Seller. Any surplus shall be paid over to the Purchaser. In case of deficiency the Purchaser shall pay the same with interest to the Seller. The Seller shall be liable for any other property in the above described motor vehicle at time of repossession, wherever such other property may be found, and shall be liable for the same. For Purchaser without liability on the part of the Seller. Upon repossession, the payments previously made shall be returned by the Seller.

8. It is agreed that the recommendation and retention, sale or right thereto shall not affect the Purchaser's liability, and/or obligation until full payment has been made in cash, or the Seller's right to sue the Purchaser at any time for any monies due and payable whether due and payable by reason of failure or default on the part of the Purchaser in fulfillment of any of the terms, conditions, covenants or warranties he may have hereunder. Any provision of this contract prohibited by law of any Province shall as to that Province be inoperative to the extent of the prohibition. This contract takes the place of the order previously agreed.

9. This Agreement shall apply to and bind the heirs, executors, administrators and assigns of the Purchaser and shall inure to the benefit of and be enforceable by the Seller, the Seller's heirs, executors, administrators, successors and assigns. Purchaser hereby waives notice of any transfer or assignment of Seller's interest in and to this Agreement.

Executed in quadruplicate, one copy of which was delivered to and retained by the Purchaser, this 22 day of July 1977

(DATE PURCHASER SIGNS CONTRACT—DO NOT DATE ON SUNDAY OR LEGAL HOLIDAY)

Handwritten text at the bottom of the page, likely a signature or date, is partially visible and illegible.

1 (2nd) 100

9. Minister

_____ Title II Corp., Co., Park _____

NAME	STREET	TOWN	PROV.
St. Paul			

SIGN IN LINE *Q M* *06*

W10000

TO GENERAL MOTORS ACCEPTANCE CORPORATION:

For value received, the undersigned does hereby sell, assign and transfer to the General Motors Acceptance Corporation, its. its or their right, title and interest in and to the said
 in contract herewith submitted for purchase by it together with the proceeds of the sale of the said

Corporation to do every act and thing necessary to collect and discharge the same.

is the undersigned free of all liens and encumbrances, that said property is as represented in the purchase of said property by the undersigned at the time of sale and is now vested

In consideration of your purchase of the within contract, the undersigned unconditionally warrants that the statements made by the undersigned in the statement form attached herein are true to the best of the knowledge and belief of the undersigned.

the amount remaining unpaid herein and covenants if default be made in payment of any installment herein to pay the full amount then unpaid to General Motors Acceptance Corporation.

agreement, extension, variation of terms of the within contract affected with, or by the discharge or release of the obligation of the undersigned shall not be affected by any

This Agreement shall apply to and bind the heirs, executors, administrators, successors and assigns of the undersigned and shall come to the benefit of and be enforceable by the undersigned.

DATE: July 1961

DATED at London this 17th day of January 1927 1927 Haney Garage Ltd. 21 22

this 22 day of July 1981

 Sign _____ Date _____

MAC 100, RM-10-10 (Use one in all Models)

(For use in all Provinces except Saskatchewan.)

ROYAL CANADIAN MOUNTED POLICE

EXHIBIT REPORT

Detachment

Seizure No.

FOR USE WHEN APPLICABLE

Detachment File No.
 Sub-Division File No.
 Division File No. **E 269-6-15-3**
 Headquarters File No.

Detachment
 Sub-Division
 Division **"X"**
 Date **March 11th**

19 42

RE: **TANAKA, Yoshio**

17th, Ave. Haney, B.C.
NAME OF FILE

On **March 11th**

19 42, 1

H.P. Price RCMPMEMBER'S NAME

Came into possession of the following goods by:-

SURRENDER UNDER O.I.C. P.C. 1486STATE BRIEFLY AUTHORITY, ETC., WHETHER BY SEARCH WARRANT, ETC.

<small>NO. OF PAGES</small>	<small>CAPACITY OR SIZE</small>	<small>DESCRIPTION OF CONTENTS DETAILS TO BE GIVEN IN FULL</small>
	LICENSE NO. MAKE & MODEL SERIAL NO. ENGINE NO. SPEEDOMETER READING CONDITION	(4 2) 60246 Pontiac sedan 49 TIRE NUMBERS 4 1221900631 33438 15263 appears good
	EXTRA EQUIPMENT	heater, defroster, lighter, two seat covers front & rear bumper guards
	DESCRIPTION & CONDITION VERIFIED	Y Tanaka # 13720 Signature of Owner Japanese Registration No. Handed over to representative of Custodian whose signature in receipt thereof appears hereunder B. J. Price March 11/42
	DATE:	Price SIGNATURE OF MEMBER SUBMITTING REPORT

McDermott Motors Ltd.

R. C. M. P.
Heater & Defroster.

USED CAR APPRAISAL RECORD

NAME *# 89*

ADDRESS *spark fire missing.*

Paint	\$	<input checked="" type="checkbox"/>	Make	
Tires <i>4. good</i>	\$	<input checked="" type="checkbox"/>		<i>Pontiac</i>
Body & Fenders	\$	<input checked="" type="checkbox"/>		
Glass	\$	<input checked="" type="checkbox"/>		
Top	\$	<input checked="" type="checkbox"/>	Body Style	
Nickelling	\$	<input checked="" type="checkbox"/>		<i> Sedan</i>
Radiator	\$	<input checked="" type="checkbox"/>		
Running Boards	\$	<input checked="" type="checkbox"/>		
Mats & Kick Pads	\$	<input checked="" type="checkbox"/>	Year	
Upholstery	\$	<input checked="" type="checkbox"/>		<i>41.</i>
Hardware	\$	<input checked="" type="checkbox"/>		
Motor Expense <i>12.00</i>	\$	<input checked="" type="checkbox"/>	License	
Transmission	\$	<input checked="" type="checkbox"/>		<i>60246.</i>
Rear Axle	\$	<input checked="" type="checkbox"/>		
Universal Joints	\$	<input checked="" type="checkbox"/>		
Clutch	\$	<input checked="" type="checkbox"/>	Serial	
Steering	\$	<input checked="" type="checkbox"/>		<i>1-2219</i> ✓
Brakes <i>adjusting</i>	\$	<input checked="" type="checkbox"/>		<i>00631</i>
Tighten Up	\$	<input checked="" type="checkbox"/>	Mileage	
Muffler	\$	<input checked="" type="checkbox"/>		<i>15263.</i>
Sundries <i>Appraisal</i>	\$	<i>3.00</i>		
Wash & Clean Motor	\$	<i>2.00</i>		
Clean Interior	\$	<i>4.00</i>	Remarks	
Oil & Grease, Change	\$			<i>good</i>
Oil & Check Over	\$	<i>4.00</i>		
Total	\$	<i>15.00</i>		

Mod. interested in _____

Selling price \$ _____

Salesman _____

Less Repairs \$ _____

Date *H. Hume.*

Appraised By _____

Allowance \$ *900.00*

For immediate acceptance only.

REDIFORM - PATENTED - MUST BE USED FOR ALL BUSINESS PURPOSES

Case 764

NEW OR USED - PURCHASE ORDER AND AGREEMENT

DATE

DEALER NAME

HANEY GARAGE LTD.

ADDRESS

HANEY & MISSION, B.C.

Please enter my Order for the following Motor Vehicle according to the Specifications, Terms and Conditions mentioned on back:

Year or Year Range	Make	Model	Model Number	Color	Body	License
1960	Pontiac	Sedan	7219	Light Blue		

Wheelbase	Asks Ratio	Make	TIRES Front - Size - Rate	Cab	Body and Special Equipment

To be Delivered on or about

Used Car as Shown OR

New Car with Standard Factory Equipment, including General Motors Owner's Service Policy. PLUS ADDITIONS AS FOLLOWS:

equipped except radio

FOR THE SUM OF 125.00 AND MY USED CAR DESCRIBED AS FOLLOWS

Make	Model	Year	Body	License
Make (if Any)	Payable To			Contract No.

1. The Purchaser represents and guarantees the motor vehicle which is being taken from him as Deposit or part payment on this purchase agreement is his property, and that his title is clear and free from all liens or encumbrances, except as hereby stated, and that the said motor vehicle was purchased by him from

and it was sold for by (Delivered Payment) (Cash) on or about (Date)

It is agreed that the Dealer can or may satisfy any charge now existing or which may arise in the future claimed upon the said motor vehicle, and the amount so paid shall be a credit against the motor vehicle herein ordered, or added to any claim the Dealer shall have for unpaid purchase price or otherwise against the said motor vehicle, and that title to this motor vehicle shall not pass from the Dealer to the Purchaser until such amount or amounts have been paid in full by the Purchaser to the Dealer, failing which the Dealer shall be at liberty to exercise its right to those amounts the condition mentioned in the sales contract as applied to any unpaid balance thereon.

2. The Purchaser agrees that if the used motor vehicle being taken in exchange as part payment is not delivered to the Dealer on or before the signing hereof, the Dealer may upgrade the said used motor vehicle upon delivery, and the amount of such last upgrade shall be the amount allowed for the used motor vehicle, and the Purchaser will pay the difference, if any, between such last upgrade and the amount of the allowance as stated above.

THIS SPACE FOR OFFICE USE ONLY - NOT PART OF AGREEMENT

Price of Car

License

Equipment

TOTAL

Trade In

Less Taxes

Balance Due

Finance Charge

Equity

Terms of Payment

Deposit with Order

Cash on Delivery

Balance Owng

Payable in

Monthly Installments of

Each

- I have carefully examined the motor vehicle herein above described and I declare that it is in good order and satisfactory in every respect.
- I have read the matter printed on the back hereof and agree to it as part of this Order the same as if it were printed above my signature.
- The front and back of this Order comprise the entire agreement effecting this purchase and no other agreement or understanding of any nature concerning the same has been made or entered into or will be recognized.
- It is expressly agreed that there are no Conditions, no Warranties (either legal or conventional) or contractual, including the legal Warranty for latent defects, the Warranty printed on the back hereof being hereby expressly accepted in lieu of all other Warranties or Representations, express or implied, statutory or otherwise, made by the Dealer or the Manufacturer, its Officers or Agents, on the Motor Vehicle, Chassis or Part furnished hereunder, nor shall any Agreement collateral hereto be binding upon the Dealer unless endorsed hereon in writing.

This Order is not Binding and does not constitute an Agreement on the part of the Dealer until it is Accepted in Writing by the Dealer or Sales Manager.

I hereby acknowledge Receipt of a Copy of this Order.

ADDRESS

PHONE

Purchaser's Signature

For

By

TOWN

EMPLOYED BY

OCCUPATION

SALESMAN

APPROVED AND ACCEPTED

Dealer

Extract from Lease.

Lease No. 473.

File No. 4844.

Lessor: The Secretary of State. (Yoshio TANAKA)

Lessee: Mrs. Doris RADFORD.

Date: 8th April, 1943.

Term: 8½ months from 15th April, 1943 to 31st December, 1943.

Consideration: \$68.00 - payable \$8.00 on 10th every month commencing
10th April, 1943. No Taxes.

Property:

Land: Lot 16 of S.W.¼ of Section 22, Tp.12, Map 3118, C. of T. 133972 E.
Municipality of Maple Ridge.

Buildings: Included. Space reserved for storing chattels.

Chattels: Not included.

Lease handed S.S.B. 13/8/43.

412-G

912 Royal Bank Bldg.,
Vancouver, B. C.,
September 2nd, 1942.

The General Motors Acceptance Corp.,
1014 Homer St.,
Vancouver, B. C.

Dear Sirs:

I enclose herewith cheque in your favour for
\$4,051.94, being payment in full for liens held on the
following Japanese motor vehicles:

No. 55	- S. Yamashita	- \$645.66
No. 56	- S. Yamashita	- \$645.66
No. 58	- S. Yamashita	- \$645.66
No. 59	- S. Yamashita	- \$645.66
No. 57	- S. Yamashita	- \$645.66
No. 89	- I. Tanaka	- \$823.64

\$4051.94

Will you kindly acknowledge receipt, and
forward the liens together with any other papers in
connection with the granting of security.

Yours faithfully,

R. B. Bell
(For Authorized Deputy of the Secretary
of State and/or Custodian.)

/ms
Enclosure.

Mr. Wm Peters
17th & 2nd road,
RR #1 Haney B.C.

EVACUATION SECTION
Rec'd JAN 7 1943
File No. 4844
Signed <u>Richard M. Anderson</u>

Dear Sir -

I received your letter and now I will send you the agreement, I made with the Japanese. The Lessee agree is to pay the taxes & Electricity lights used for the duration of the war or 8 months, I had to pay the taxes for 1 year for the 8 months I have been here, it amounted to \$2.15. If you agree I will pay the amount of taxes to you. This place only counts the house no garden was raised here the soil is no good. and no fruit.

Yours truly
William Peters.

T. S. ANNANDALE

426 FOURTH STREET
NEW WESTMINSTER, B. C.
TELEPHONE 969

8th. April 1943

EVACUATION SECTION	
Rec'd	APR 9 1943
File No.	
Ans.	
Referred	Anderson

Mr. Anderson,
506 Royal Bank Building,
Vancouver B.C.

Dear Sir:

I believe a Mrs. Moran of this City called on you recently, about a piece of land formerly occupied by Japs, near Haney, for which she states that you asked a rental of Nine dollars per month, (9), and that there was a well on the property. She asks me to state to you on her behalf that there is no well at all - only a hole in the ground with no water in it, and that she would have to carry all the water from an adjoining property.

Under these circumstances she thinks that a rental of Six dollars per month (\$6.00) is ample, especially as she states that a former tenant, only paid the taxes. Will you please write to her, as she wants to get busy with the planting, if you can come to terms.

Yours sincerely

T. S. Annandale

1844

31st May, 1946.

REGISTERED

Mr. Yoshio TANAKA,
Registration No. 137 0,
c/o Mrs. E. Pedrin,
Diamond City, Alta.

Dear Sir:

Your file has now been reviewed and we take this opportunity of giving you a brief summary of our administration of your affairs.

You registered with this office on the 20th April, 1942, and real property on 17th Avenue at Haney, which you declared you owned, at that time became vested in the Custodian. Prior to your evacuation you had leased your property to William Peters until the end of 1942, in consideration that he pay the Municipal taxes and electric light account for that year. The payment of these accounts were made by him, but as this was the only consideration of rent you registered, no rentals accrued to your credit at this office during the period. In accordance with the policy of liquidation decided upon by the Canadian Government, the property was sold to the Director of Veterans' Land Act as of the 1st January, 1943. Full details of the property sale were sent to you on the 5th June, 1944, from which you will have noted that the net proceeds were credited to your account here. Legal fees amounting to \$15.00 in connection with the conveyance of the property were later charged to your account.

It is noted that you declared you had the Certificate of Title for the property in your possession. We do not appear to have received it, and therefore request that you send it to us without delay, as it has been cancelled at the Land Registry Office.

You declared no chattels being left in the Protected Area. Our fieldmen when inspecting the property found a few items there, but noted that they would not be worth the expense of removing same to auction, and accordingly abandoned them.

In accordance with Government regulations, your car was surrendered to the Custodian, and sold for the sum of \$900.00. The balance owing on the car under the conditional sales agreement amounted to \$823.64, so that after making payment of this amount and deducting expenses of \$25.76, the net balance remaining amounted to \$50.60, and was credited to your account here, as you were advised in our letter of the 17th January, 1943.

The B.C. Electric Railway Company paid the sum of \$3.00 in to this office to your credit being a refund of your security deposit with them.

You declared that you had a number of War Savings Certificates, and a

31st May, 1946.

Sun Life Insurance policy. These were not brought under control by the Custodian. However, when you arranged with the Insurance Company for the cash surrender value of your policy, this office co-operated with you by forwarding the Insurance Company's cheque, which was made payable to yourself and your father as beneficiary, to you.

Attached hereto please find Custodian cheque in the amount of \$96.53, which sum is your full remaining balance at this office. This balance is arrived at by the addition of the \$3.00 refund of security deposit referred to above, to the credit balance shown on the statement of account previously sent to you, less legal fees of \$15.00 and the remittance of \$900.00 to you on the 14th May, 1946.

It would appear that we have accounted for all the property of every kind left by you in the Protected Area, which vested in the Custodian, and in order that you may confirm this and acknowledge the cheque, we are enclosing a stamped addressed envelope for your convenience in replying.

Yours truly,

W.E. Anderson,
Administration Department.

WRA:HA
Encls. (2)

C/o Mrs. E. Pedrini,
Diamond City, Alta.

Dept. of the Secretary of State,
Office of the Custodian,
Japanese Evacuation Section,
Vancouver, B.C.

EVACUATION SECTION	
Rec'd	JUL 8 1946
File No.	4844
Ans.	
Referred	Adler

Dear Sir:

I have received your cheque of \$996.⁵³ being settlement in full as been stated by you. According to my figuring there seems to be quite a difference as I expected more than that amount.

In regards to Rent Funds, Mr. M. Peters was renting my property after my evacuation. Then, when Mr. Peters left, you sent me letter stating you had another people renting. During those times, wasn't there any Rent too?

Then at the time of evacuation I had 3 or 4 pieces of Carpets in good condition, left in the house. What has become of that, or did you sell them?

And here again, I'm not satisfied the price of the car & the property you sold for.

A 1941 Pontiac Sedan with Heater, Defroster, Lighters, 2 seat covers, and front & rear Bumper Guards, was worth more than \$900⁰⁰ at the time of evacuation. Because a 1938 car was \$800⁰⁰ or more, cash, in Lethbridge, so according with a 1938 Model car, the 1941 Pontiac Sedan is worth at

least \$1200⁰⁰. I bought this car in July or Aug. of 1941,
and then the Govt. surrendered it. Within 7 or 8 months
I have lost \$600⁰⁰ on this car.

I cannot understand why you have to charge the
Administrative Expense of \$25.⁷⁶ when the car was forcibly
taken away from us.

And in regards to my property, the Maple Ridge Tax
Statement says, the land is worth \$750⁰⁰, and value of
improvements is \$700⁰⁰.

Then you have charged all kinds of fees in connection
with the property, ^{which} ~~which~~ I again have to mention it.

My father has the land title, so when I get it,
I'll send it, ^{your} upon receiving some reasonable settlement.

In the meantime, please ~~go~~ go over my file
and let me know what you think about my
situation.

your very truly,
Y. Tanaka.
Reg. # 13720.

5th July, 1946.

Mr. Yoshio TANAKA,
Registration No. 13720,
c/o Mrs. E. Pedrin,
Diamond City, Alta.

Dear Sir:

We have received your undated letter in reply to our letter of the 31st May, in which we set out details of our administration of your affairs.

Regarding the rent funds. In reply to an inquiry in May 1943, we did advise you through the Department of Labour that your property was being rented for the sum of \$8.00 per month. However at that time we had no knowledge that the property was being sold under instructions from the Canadian Government at Ottawa. The date of the sale of the property and adjustments of same, was set to be as of the 1st January, 1943, and therefore any rentals received at this office covering rentals after that date, were paid over to the purchaser of the property under adjustments.

Regarding your linoleum. Our inventory of chattels on the property confirms your statement that linoleum was left in the house. However our fieldmen reported that the expense of removing same for sale, was likely to exceed the sale price which could be derived, and it was therefore abandoned where it was.

Your remarks regarding both the sale price of your real property and your automobile are noted, and we appreciate your courteous objections to the value which was obtained from their sale, and we know that this is a matter of personal concern. The sale of both were however, carried out under a policy of liquidation decided upon by the Canadian Government on the basis of appraisal by qualified appraisers, and this office is not in a position to consider any alternative.

Your letter is being placed on your file where your expression will be available at any time in the future.

Yours truly,

W.E. Anderson,
Administration Department.

WEA:HA

CASE NO. 764.

IN THE MATTER OF THE "INQUIRIES ACT"
PART 1. REVISED STATUTES OF CANADA 1927. CHAPTER 99.

JAPANESE PROPERTY CLAIMS COMMISSION.

B E F O R E

(HIS HONOUR JUDGE L. H. STACK, SUB-COMMISSIONER)

10

Lethbridge, Alberta,
 October 6th, 1948.

IN THE MATTER OF THE CLAIM OF
YOSHIO TANAKA,

PROCEEDINGS AT HEARING.

20

APPEARANCES:

G.E.A. RICE, Esq., K.C.,

appearing for the
 Dominion Government.

W.S. RUSSELL, Esq.,...

appearing for the
 Claimant.

MISS LILLIE THOMAS,

Secretary.

MRS. LUCIE HANDFORD,

Official Interpreter.

S.R. HOWARD, Esq.,

Official Reporter.

30

H. Tanaka,
In Chief.

THE SECRETARY: Case No. 764, Yoshio Tanaka.

YOSHIO TANAKA, the claimant herein,
being first duly sworn, testified
as follows:

DIRECT EXAMINATION BY MR. RUSSELL:

Q Mr. Tanaka, I am showing you a summary of evidence
in support of claim? A: Yes.

Q You are familiar with the contents?
A Yes.

10

Q This was prepared on your instructions and from
information supplied by you? A: Yes.

Q This is your signature at the end?
A Yes.

Q You believe it to be true and correct to the
best of your knowledge, information and belief?
A Yes.

MR. RUSSELL: Put it in as Exhibit 1.

(SUMMARY MARKED EXHIBIT NO. 1).

MR. RUSSELL: Q: I am showing you a picture of a
building; what building is that?

20

A That is my house at Haney.

Q That is your house at Haney? A: Yes.

Q That is the one that you are claiming for?
A Yes.

MR. RUSSELL: I will put that in.

(PHOTOGRAPH MARKED EXHIBIT NO. 2).

MR. RUSSELL: I was wondering if you would let me
have the R.C.M.P. report on the automobile.

Your Honour, the personal property claim is
for a Pontiac 1941 automobile.

30

3
Y. Tanaka,
In Chief.

MR. RICE: I don't appear to have that. It might have been in the master file.

MR. RUSSELL: Just a second; maybe I have a copy of it.

Q Did you receive this report on your motor car from the Mounted Police?

A Yes, I got this one when I surrendered it.

Q They gave you that? A: Yes.

MR. RUSSELL: I will file that, your Honour.

(R.C.M.P. REPORT MARKED EXHIBIT NO. 3).

10 THE SUB-COMMISSIONER: From the Custodian's file, is it?

MR. RUSSELL: No, that is from our own file.

Q You were buying this car on time, isn't that right?

A Yes, on time.

Q And you hadn't fully paid for the car?

A No, I hadn't.

Q And I believe there was a lien against the car of \$823.64, is that correct? A: Yes.

Q So that your claim is with respect to your equity in the car? The car cost you \$1250.00, isn't that right? A: Yes.

Q Now, there was \$823.64 against that car?

A Yes.

Q Therefore, your equity would be the difference between these two figures? A: Yes.

MR. RICE: He hasn't sworn to that in his statement.

MR. RUSSELL: I just wanted to clear that up.

Q So that your actual equity in the car would be \$426.36? A: Yes.

Q Which gives you the difference between these two figures. Now, the car was sold for \$900.00?

Y. Tanaka,
In Chief.

A Yes.

Q And you say the fair market value was \$1250.00?

A Yes.

Q So that that difference of \$350.00 is what you are claiming on that car, because the lien was paid for out of the \$900.00?

A: Yes. You see, there was extra equipment I put on later, you see. I have itemized it.

Q It is all itemized here?

A: Yes, I figured that as depreciation like.

Q Well, this heater and the defroster, that cost you \$35.00, did it?

A: Yes.

Q And the other fixtures, seat covers, and the rest, do you remember what you paid for them?

A The seat covers \$35.00, and the lighter was \$5.00, and the bumper guard was \$6.00, I think.

Q That is all, thank you.

MR. RICE: I am submitting, your Honour, that the real estate was sold for its fair market value. I am submitting that the car was sold for its fair market value.

I wish to tender the following documents as exhibits. Farm appraisal report respecting the land.

(APPRAISAL REPORT MARKED EXHIBIT NO. 4).

MR. RICE: 1943 assessment of the land, showing the improvements \$700.00, or valued at \$700.00, and the land at \$750.00.

(ASSESSMENT NOTICE MARKED EXHIBIT NO. 5).

MR. RICE: A real property summary showing the assessment and the history of the administration and the sale.

Y. Tanaka,
Cross Exam;

(SUMMARY MARKED EXHIBIT NO. 6).

MR. RICE: There were two summaries in that, real property summary and claim on real and property summary.

THE SUB-COMMISSIONER: They are filed as one exhibit?

MR. RICE: Yes, your Honour.

I submit as an exhibit a memorandum respecting the sale of the car, showing that it was appraised at \$900.00 and sold for that amount.

(MEMORANDUM MARKED EXHIBIT NO. 7).

10

CROSS EXAMINATION BY MR. RICE:

Q You bought your car a year before you were evacuated?

A Yes, 1941.

Q For \$1250.00?

A: Yes.

Q And after using it for a year you say it is still worth \$1250.00?

A: Yes. Well, I

added this heater and the defroster, and the lighter and bumper guard and seat covers, so that I naturally intended to be fair so that I allowed that as depreciation.

Q But you probably put several hundred miles on the car driving it in the meantime, didn't you?

A Pardon?

Q You probably put several hundred miles on the car driving it around in the meantime?

A Yes, a few hundred miles.

Q As a matter of fact, the car would depreciate in value if you put it in a glass case and kept it for a year, would it not? Isn't that right?

20

30

Y. Tanaka,
Cress Man.

A Yes.

THE SUB-COMMISSIONER: But cars increased a good deal
in value, did they not, second hand cars?

MR. RICE: No, sometime later.

THE SUB-COMMISSIONER: Sometime later?

MR. RICE: Yes.

Q There was a lien against the car when you turned
it over to the police amounting to \$823.64?

A Yes.

10

Q That is right?

A: Yes.

Q That you owed?

A: Yes.

Q Who did you buy your property from, your land?

A Mrs. K. Yoshida.

Q How much did you pay for it?

A \$2575.00.

Q Did you pay her in cash?

A: Yes.

Q And you bought it in 1939?

A: Yes.

Q All right, that is all.

THE SUB-COMMISSIONER: Anything further, Mr. Russell?

20

MR. RUSSELL: No.

THE SUB-COMMISSIONER: That is all, thank you.

(Witness aside)

(PROCEEDINGS ADJOURNED SINE DIE)

I hereby certify the foregoing to be
a true and accurate transcript of the
proceedings herein.

"S.R. HOWARD" Official Reporter.

I hereby certify that the foregoing transcript
purports to be an accurate record of the proceedings
adduced before me.

30

SUB-COMMISSIONER.

Defence Brief

Yoshio TANAKA

File No. 4844

Case No. 764 ✓

LETHBRIDGE
6 Oct. 48
V.L.A.

REAL PROPERTY CLAIM

1. Real Property Claim

\$2575.00

Appraised at

\$1125.35

Sold for

\$1105.00

Witness: ✓ T. Godfrey, Appraiser

PERSONAL PROPERTY CLAIM

2. Motor Car Claim

\$1250.00

Appraised at

\$900.00

Sold for

\$900.00

Witness: ✓ McDermott Motors, Appraiser.

Submission:

That the real estate was sold for its fair market value.
That the car was sold for its fair market value.
Purchase price of car 1250.00
Put on extras costing 81.00
Total cost new 1331.00

RWD/nw

Name of Claimant **TANAKA, Toshio**Case **764**Custodian File **4844**

REAL PROPERTY										Total		
Greater Vancouver		Rural (except V.L.A.)			V.L.A. (except Mission Village)		V.L.A. Mission Village					
Sale Price	5% thereof & 12.50	Sale Price	10% thereof	Charges 12.50 & Comm.	Sale Price	Total Award 80% of all Sale Prices		Sale Price			Total Award 125% of all Sale Prices	
						% of Total	Amount				% of Total	Amount
					1185.		661.00				661.00	
PERSONAL PROPERTY												
Motor Vehicles		Boats and Boat Gear										
Sale Price	25% thereof	Sale Price	Nelson Bros. 23.5% of Sale Price	Other Sales 28.5% of Sale Price	Equipment charges paid to purchasers in error. Repay to owners	Amount of Claims for Boat Gear Declared & Recorded Now Missing	45% of amount in next preceding column					
900.00											225.00	
225.											225.00	
NETS												
Total award for Nets plus Sale Price	Total Claim for Nets Sold, Declared Not Found and Recorded Now Missing	Percentage Total Award to Total Claim	Claim for Nets Sold Declared Not Found, & Recorded Now Missing	Apply % ratio to Claim	Deduct Custodian Sale Price							
MISCELLANEOUS CHATELS												
Claim for goods Sold By Auction	Sale Price of Goods Sold By Auction	Rebates of charges 30% of Sale Price	Ratio in % of Sale Price to Claim	Claim for goods Declared Not Found, Recorded Now Missing, & Sold Not Paid	Application of % ratio to amount in next preceding column	Sale Price of goods Sold by Tender	12% of Sale Price					
TOTAL RECOMMENDATION										661.00		