

10987

711 Stock Exchange Bldg.,
475 Howe Street,
Vancouver, B.C.
Oct. 18/46

Custodian of Enemy Property,
Royal Bank Building,
Vancouver, B.C.

TREASURY DEPT. CLAIM \$ 200

Dear Sir:

KITIGAWA, Itsu ~~10987~~ 10987
Re: In Trust for KITAGAWA, Sikichi #17407
(Essondale Case)

Please note that the above has been
repatriated to Japan. At the time of repatriation, the
following transactions took place:

Cash turned in - - - - - Nil

Draft Issued - - - - - \$ 200.00

It will be seen that this Japanese is
indebted to the Department on account of repatriation in
the amount of \$ 200.00. Therefore should you receive
further funds on this account such funds should be turned
into this office. It will be applied first to recoup the
expenditure made and, second, if there is any surplus such
surplus will be remitted to Japan for the account of the
Japanese in question.

Yours truly,

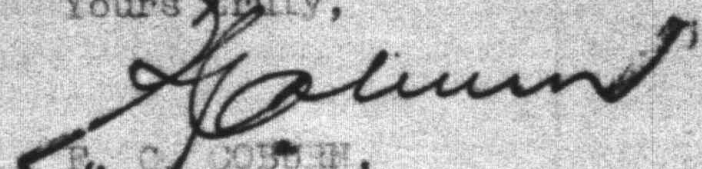
E. C. COBBEN,
Supervising Treasury Officer.

FGC/EJ.

REAL PROPERTY SUMMARY

JAPANESE NAME: Seikichi KITAGAWA

Reg. No. —
In Mental Hospital.

File No. 10987.

CATALOGUE NO: —

PROPERTY ADDRESS: 2327 Hammond Road, P.O. Box 313, Pitt Meadows, B. C.

LEGAL DESCRIPTION: Lot "A" of Lots 1 to 7, Block "C" of Lot 283, Group 1, Map 3531,
Mun. of Pitt Meadows, D.N.W.

TITLE:

Registered in the name of Seikichi KITAGAWA.

ENCUMBRANCES:

A Caveat was registered against this property by Ian Macpherson,
Agent for Glenn Willoughby McPherson, Authorized Deputy of the
Secretary of State and/or Custodian, November 12th, 1942.

No indication of any unregistered charges.

The above mentioned Caveat was withdrawn January 6th, 1944.

HISTORY OF
ADMINISTRATION:

The owner, Seikichi KITAGAWA, of the above described property was a
patient in the Essondale Mental Hospital. His property did not vest
in the Custodian but was administered by the Attorney General's
Department, Victoria, B.C. This property was sold by the Department
for \$1200.00. After paying Taxes and Commission to the Real Estate
Agent there was a net balance of \$1080.00 left which was applied to
reduce the Hospital's Maintenance Account as at December 31st, 1943,
of \$1472.00.

This Japanese was repatriated to Japan on the S.S. General Meigs,
17th June 1946.

This summary is certified to be in accordance with
information on file.

February 13th, 1947.

DAC:JS

37
41

D. A. Cramer
D. A. CRAMER.

Farm Appraisal ReportFile No. JL 420Land Description Lot "A" of Lot "C", D.L. 283, Map 3531.
(House No. 2327)Containing 10.01 AcresOwner's Name KITAGAWA, Seikichi Post Office Address Pitt Meadows, B.C.Nearest Rail Point Pitt Meadows, B.C. Distance 1 mileMarket Town New Westminster, B.C. Distance 13 milesChurch (give denomination) United and Anglican Distance 1 mileNearest School Pitt Meadows Distance 1 mileState how property was identified: Corner posts and map location.

Roads: State whether property has access to main road, the kind of road and its condition.

Direct access to Hammond Road, surfaced, good.Is this district a good one? Fairly good, co-operative marketing.Employment opportunity Sawmills, brick yard and peat plant.Predominating Nationality and religion: Mixed, Japanese predominating.Describe Fencing and its condition: South only. Value \$Water supply: Domestic water from well. Value \$**BUILDINGS ON FARM**

10987

| BUILDINGS | DIMENSIONS | MATERIAL | HEIGHT | ROOF | AGE | Foundation | REPAIR | VALUATION |
|-----------|------------|----------|--------|-------|-----|------------|--------|-----------|
| HOUSE | 21 x 30 | frame | 1 sty. | shgl. | 20 | wood | poor | 150.00 |
| | x | " | | " | | " | " | |
| Garage | 10 x 14 | " | 1 sty. | " | 20 | " | " | 20.00 |
| BARN | x | " | | | | " | " | |
| | x | " | | | | " | " | |
| BARN | 18 x 20 | " | 8'-14 | shk. | 20 | " | " | 50.00 |
| | x | | | | | | | |
| GRANARY | x | | | | | | | |
| | x | | | | | | | |
| | x | | | | | | | |
| | x | | | | | | | |
| | x | | | | | | | |

Total present day value \$220.00

Total Value Buildings add to farm \$

Is dwelling habitable without repairs? Yes. If not what is your approximate estimate of cost to make it habitable?

Describe the basement and chimneys: No basement, brick chimney to ground.No. rooms downstairs? 4 Upstairs? - How finished Wood lined.Are buildings painted? No. Condition of paint -Distance from nearest bush No bush near.

Note: Particular care must be taken when examining and reporting on foundations, sills and roofs.

| ACRES | LEVEL, UNDULATING, ROLLING OR HILLY | SOIL (State Depth) | SUB- SOIL | KIND AND QUALITY OF CROP | VALUE PER ACRE | TOTAL |
|--|--|-----------------------|--------------|---|------------------------------|-------------------|
| 5.89 | level | edy. loam 12"-18" | hardpan | Mixed, small fruits | 60.00 | 353.40 |
| Area which can be cultivated without cost other than for breaking. | | | | | | |
| | LEVEL, UNDULATING, ROLLING OR HILLY | SOIL (State Depth) | SUB- SOIL | | VALUE PER ACRE | |
| | | | | | | |
| Area which can be cultivated after a reasonable amount of clearing timber, stones, drainage, etc. | | | | | | |
| | LEVEL, UNDULATING, ROLLING OR HILLY | SOIL (State Depth) | SUB- SOIL | NATURE OF RECLAMATION NECESSARY | RECLAMATION COST PER ACRE | VALUE PER ACRE |
| 4.12 | level | edy. lm. 12"-18" | hard- pan | clearing bush, levelling, draining | 175.00 to 250.00 | 10.00 |
| Area Unsuitable for Cultivation. | | | | | | |
| | CHARACTER OF LAND E. G. HILLY, SWAMPY, ROCKY. | | | NATURE OF TIMBER IF ANY AND WHETHER MARKETABLE | VALUE OF LAND PER ACRE | |
| | | | | | | |

Total value of Land \$ 394.60

Total added by buildings to value of farm \$ 220.00

Total fruit trees add to value of farm (for use in orchard districts only) \$

Total value of farm \$ 614.60

Describe condition of farm commenting on tillage, length of time unoccupied or partly occupied:

Property in poor state of cultivation, leased to A. Buffard 50% of 1942 crop. Area in beans and potatoes only portion under cultivation. General growth indicates poor fertility.

State most suitable type of agriculture for farm bearing in mind the district's limitations, if any.

Mixed small fruits and asparagus.

Noxious weeds: No serious weed situation, bracken making inroads on cleared area.

Give approximate detail and amount of all annual taxes and names of Taxing Authorities:

1942 Taxes \$28.55
District of Pitt Meadows.

Date: July 2nd, 1942.
Place: New Westminster, B.C.

I certify that the above report is based on a personal examination of the whole farm made on the 1st day of July, 1942.

Inspector's Signature

"H.L. SINCLAIR"

Note: (Use Form 43 (Sheet 2) in connection with this form.)

Diagram of Property

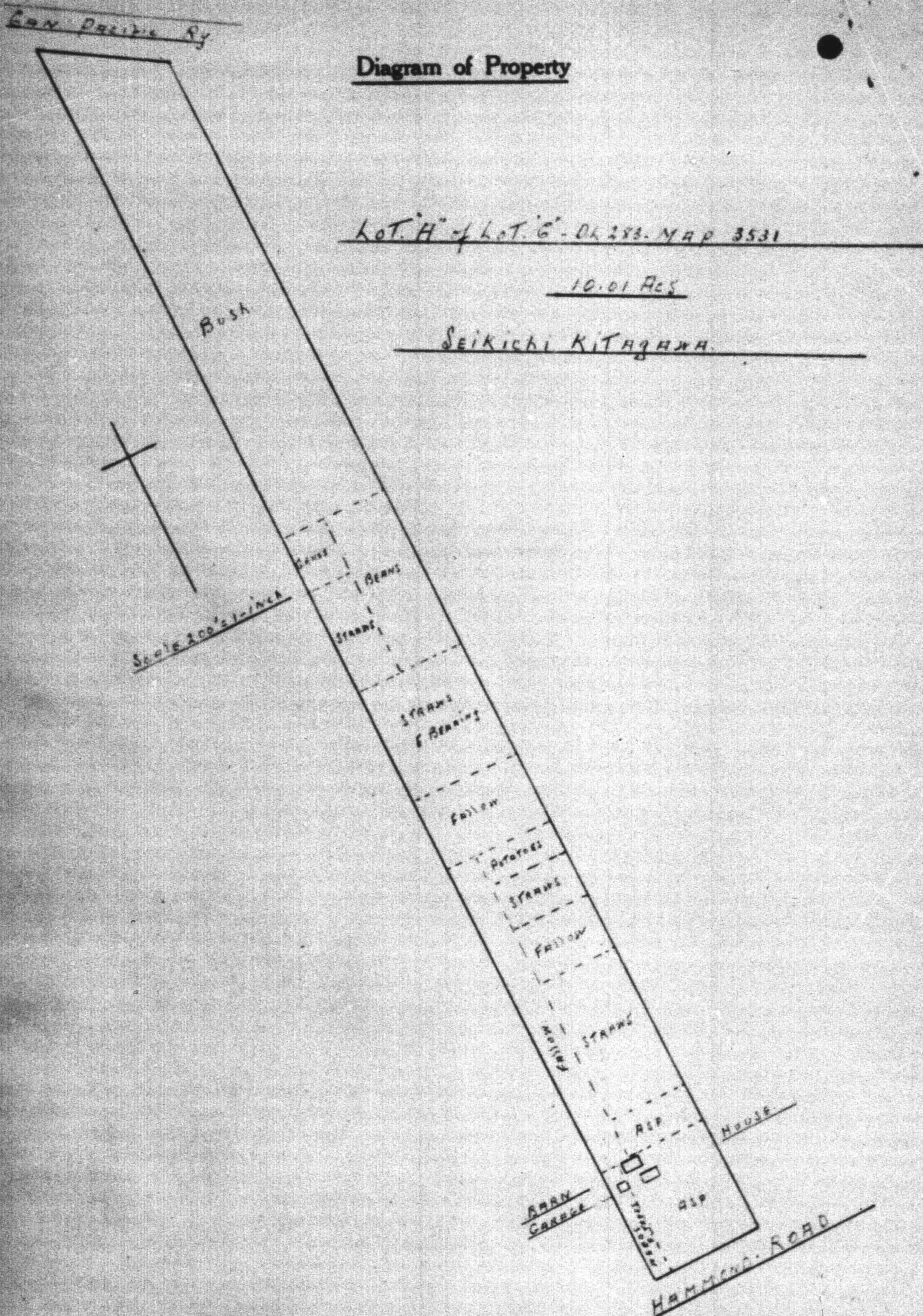

Following careful review of this appraisal report, it is my opinion that the present value is \$ 600.00

Date 3rd July, 19 42.

"I.T. BARNET"
District Superintendent.

C L A I M

File No. 10987

DATE

Jan. 20th, 1944.

CREDITOR

Dr. G. Morse,
Haney, B.C.

DEBTOR

Seikichi KITAGAWA

AMOUNT OWING

\$9.00

AGENT

nil

ORIGINAL FILE

G. 68.

| | |
|---------------|------------|
| ENEMY SECTION | |
| Rec'd | FEB 3 1944 |
| File No. | |
| Ans'd | |
| Refer'd | |

January 30, 1944.
Oak Bluff, Fla.

Dear Sis:

In referring to your letter of January 20th, I have the Certificate of Title in my possession.

But without my husband's permission to release this Title, I would not like to mail it for you. So please tell me what is your intention to do of my husband's title.

I will mail the Title as soon as you let me know what you are going to do with it because I hate to do anything without my husband's permission.

Yours sincerely,

Elmer Kilgawa

70 Menards E. & W. Co.,

Oak Bluff, Fla.

File No. 10987

Richardson 10927
The Office of the Custodian,
Royal Bank Building,
Vancouver, B. C.

Gentlemen:

I hereby make application to lease the farm of
S. Itozawa situated at *Ritt Meadows*
on a crop sharing basis agreeable to you.

If my application is accepted I agree to enter into an agree-
ment with you whereby the cash proceeds of present fruit crop is
equally divided between the owner of the farm and myself less
necessary expenses for cultivation, picking etc.

Yours very truly,

A. Bouffard

MEMORANDUM.

File #10987.

25th June, 1942.

re: Seikichi KITAGAWA.

Mr. McRae, Provincial Collector of Institutional Revenue, informed me this morning that the property of S. Kitagawa, who is now confined in Essondale Mental Hospital, was being administered by the Attorney General of the Province and, therefore, the Custodian should take no action in controlling and managing this property.

[Handwritten signature]
RD:GF

IN REPLYING PLEASE REFER
TO FILE NO. **K 1058 A**

INSPECTOR OF MUNICIPALITIES



OFFICE OF THE CUSTODIAN
JAPANESE SECTION

RECEIVED
JUL 8 1942

DOMINION BANK BUILDING
VICTORIA

July 2nd, 1942.

G.W. McPherson, Esq.,
Authorized Deputy of the
Secretary of State and /or Custodian,
Japanese Evacuation Section,
1404 Royal Bank Building,
VANCOUVER, B.C.

| | |
|----------|------------|
| Rec'd | JUL 4 1942 |
| File No. | |
| Ans. | |
| Relayed | |

Dear Sir:

Sukichi
re Sukichi Kitagawa, Pitt Meadows, B.C.

The above-named has been a patient at the Provincial Mental Hospital since December 21st, 1939, and during his stay there the Attorney-General, for whom this office acts, is statutory committee of his estate and charged with the duty of its administration.

I have been informed by Mr. J.G. McRae, Collector of Institutional Revenue, 410 Seymour Street, Vancouver, that you wish us to administer this man's 10 acre property near Pitt Meadows. I have written to Mr. J.B. Shimek, Secretary-Manager of the Pacific Co-operative Union, at Mission City, regarding the proceeds of the berry crop. I might mention that we have no funds here to the patient's credit and I understand the patient's father, wife and child have been living on the property in the past. Would you kindly let me know whether the family has been evacuated.

Yours truly,

E.H. Bridgman

E.H. Bridgman,
Inspector of Municipalities.

BH/LDG

10987
3695

10th July, 1942.

Pacific Co-operative Union,
Mission City, B.C.

Attention Mr. Shimek.

Dear Sirs:

re: Seikichi Kitazawa.

We return herewith letter received by you
from the Inspector of Municipalities dated July 2nd
with reference to the above Japanese.

As this property is being administered by
the Attorney General of British Columbia, it is nec-
essary for you to deal direct with the Inspector of
Municipalities.

Yours truly,

Manager,
Farm Department.

RDR:GF

Encl:

INSPECTOR OF MUNICIPALITIES
Province of British
Columbia

In replying please
refer to File No. K 1058 A

Dominion Bank Building
Victoria

November 30th, 1942

William Ure, Esq.,
c/o Pacific Co-operative Union,
Mission, B.C.

OFFICE OF THE CUSTODIAN
JAPANESE SECTION
RECEIVED
DEC 5 1942

Dear Sir:

re Seikichi Kitagawa (Japanese),
formerly of Pitt Meadows

I have been advised by the Commissioner, B.C. Police, that you are the Custodian, Japanese Evacuation Section, at Mission, and he has forwarded to me the statement regarding the berry crop on the property of the above-named, which you handed to Constable J. McGeachan. I note from the statement that the proceeds of the berry crop did not cover expenses and consequently no funds will accrue for the benefit of the estate.

We were requested last June by the Office of the Custodian in Vancouver to administer this property. Constable McGeach mentions in his report that Alfred Bouffard has some arrangement for the leasing of this property for 1943 and I would appreciate it if you would let me know the position. As this year's crop results have shown no revenue to the estate, I am of the opinion that it would be preferable to dispose of this property, if a purchaser can be found, the more so as the present owner would not be permitted to occupy the property in the event of his release from the Hospital. The assessed value is \$1000.00 for improvements and \$1100.00 for land. Alternatively the place could be rented and I am advised by the Municipal Clerk of Pitt Meadows that a fair rental for this property of 10.1 acres would be \$10.00 per acre for land and \$5.00 monthly for the house, making a total of \$160.00 per annum.

Would you be good enough to let me have your views in the matter.

Yours truly,

/signed/ E.H. Bridgman

Inspector of Municipalities

BH/LDG

C O P Y

10987

Your file No. K 1058 A

December 8, 1942.

Mr. E. H. Bridgman,
Inspector of Municipalities,
Dominion Bank Building,
Victoria, B. C.

Dear Sir:

Re: Seikichi KITAGAWA

Mr. Ure has referred to us your letter to him dated November 30th in connection with the individual mentioned above.

Our records indicate that Mr. Seikichi Kitagawa is confined in the Essondale Mental Hospital, Mr. Kitagawa did not register his assets with us, was not evacuated from the Protected Area and that in conclusion his property in the Municipality of Pitt Meadows did not vest in the Custodian.

Our records further indicate that on July 2nd you wrote to Mr. G. W. McPherson following word received by you from Mr. J. G. McRae, Collector of Institutional Revenue, indicating that you were in touch with Mr. J. B. Shimek, Manager of the Pacific Co-operative Union, Mission City, regarding administration of Mr. Kitagawa's property.

Our records further indicate that a Mr. A. Bouffard is occupying the property under a share-crop arrangement, and in so far as the Custodian is concerned, please note that as relative property has not vested in the Custodian, it is our understanding that the matter of administration remains in your hands subject to Soldier Settlement of Canada Order-in-Council P. C. 5523 of June 29, 1942, and subject to Caveat filed by the Custodian on November 12, 1942 for the purpose of protecting any interest which Mrs. Seikichi Kitagawa may have in the estate of her husband.

Your letter raises the question of sale of relative property and in this connection we wish to call your attention to the fact that, generally speaking, the Custodian is not liquidating real estate previously owned by the evacuated individuals of the Japanese race.

If it is possible for you to arrange rental of the property at the figures mentioned in your letter and subject to your obtaining the permission of the Director of the Soldier Settlement,

IN REPLYING PLEASE REFER
TO FILE NO. K 1058 A

10987
OFFICE OF THE CUSTODIAN
JAPANESE SECTION
RECEIVED
DEC 12 1942

INSPECTOR OF MUNICIPALITIES



DOMINION BANK BUILDING
VICTORIA

December 11th, 1942.

R.P. Alexander, Esq.,
Manager, Japanese Evacuation Section,
Department of the Secretary of State,
Office of the Custodian,
506 Royal Bank Building,
Vancouver, B.C.

Dear Sir:

Re: Seikichi Kitagawa.

I have received your letter of the 8th instant and thank you for the information contained therein. After we have ascertained what arrangement, if any, has been made with Alfred Bouffard for 1943, we will consider the question of renting the property meanwhile. I will keep you informed as to developments in this matter.

I note that a Caveat has been filed by the Custodian for the purpose of protecting any interest which the patient's wife may have in the estate and I would appreciate it if you would send me a copy of this Caveat for our files.

Yours truly,

A handwritten signature in cursive script, appearing to read "E.H. Bridgman".

E.H. Bridgman,
Inspector of Municipalities.

BH:HS

A handwritten mark or signature in the bottom right corner of the page.

10987

17th December, 1942.

E. H. Bridgman, Esq.,
Inspector of Municipalities,
Dominion Bank Building,
Victoria, B. C.

Dear Sir:

Re: Seikichi KITAGAWA

Thank you for your letter dated December 11th, your reference K 1058 A. Attached please find copy of Caveat dated November 12th, 1942.

Yours truly,

R. P. Alexander
Manager

RPA:LF

10987

October 27, 1943.

A. G. Duncan Crux, Esq.,
535 West Georgia Street,
Vancouver, B. C.

Dear Sir:

Re: KITAGAWA, Seikichi and the
Director, Veterans' Land Act

Lot "A" of Lots 1-7, Block "C" of
Lot 283, Group 1, Map 3531, Municipality of Pitt Meadows. D.N.W.

The owner of the above property Seikichi Kitagawa, is a patient in the Essondale Mental Hospital. His property did not vest in the Custodian but was and is being administered by the Attorney General's Department, Victoria, B. C.

In error, Certificate of Encumbrance No. 49781 was forwarded to your office for inclusion in the transmission. Under the circumstances, the Custodian is not in a position to convey this property and we therefore request that you return relative Certificate of Encumbrance to this office.

Yours truly,

R. D. Richardson.
Farm Department.

RDR/MFP

CRUX & McMASTER*Brokers and Solicitors*G. F. McMASTER
A. G. DUNCAN CRUX308 RANDALL BUILDING
535 WEST GEORGIA ST.
VANCOUVER, B. C.

October 29, 1943

Department of the Secretary of State
Office of the Custodian
Royal Bank Building
VANCOUVER, B. C.Attention Mr. F. G. Shears, Director

Dear Sir:

| | |
|--------------------|---------------|
| EVACUATION SECTION | |
| Rec'd | OCT 30 1943 |
| File No. | 10987 |
| Ans. | Print 4/11/43 |
| Referred | Shears |

Re: Kitagawa, Seikichi - Lot "A" of
 Lots 1-7, Block "C" of Lot 283,
 Group 1, Map 3531, Municipality of
 Pitt Meadows, D.N.W. Your file - 10987

In response to your letter of October 27th in which you state that the above property did not vest in the Custodian by reason of the fact that the owner was a patient in the Essondale Mental Hospital and his property is being administered by the Attorney General's Department at Victoria, B. C., we enclose herewith certificate of encumbrance number 49781 which you state was forwarded to us in error.

Would you please acknowledge receipt of this certificate at your earliest convenience.

Yours truly,

CRUX & McMASTER

PER

AGDC

A. G. DUNCAN CRUX

AGDC/SH
Encl.

IN REPLYING PLEASE REFER
TO FILE NO. **K 1058 A**

INSPECTOR OF MUNICIPALITIES



DOMINION BANK BUILDING
VICTORIA
November 19, 1943.

Manager,
Japanese Evacuation Section,
Department of the Secretary of State,
Office of the Custodian,
506 Royal Bank Building,
Vancouver, B.C.

| | |
|--------------------|-------------|
| EVACUATION SECTION | |
| Rec'd | NOV 22 1943 |
| File No. | 10997 |
| Ans. | |
| Referred | Anderson |

Dear Sir:

Re: Seikichi Kitagawa

Referring to your letter of December 8th, 1942, I would advise you that no revenue was received from Mr. A. Bouffard, who rented this property for 1942 on a crop sharing basis. We endeavoured to rent it for 1943 to Mr. Bouffard on a straight rental basis, which he would not accept. We requested him to vacate the property but he has harvested the crop during this year without, however, making any accounting to us so far. We gave him definite notice through the Provincial Police to vacate this property.

There are taxes outstanding of \$31.18 for 1942 and \$26.80 for 1943. As we have no funds at credit of this estate, we are unable to pay these taxes. I am informed by the Municipal Clerk, of Pitt Meadows, that the taxes were paid by the Soldier Settlement Board but were later refunded as they claimed this did not come under their Department.

We are endeavouring to find a new tenant but as the property is now somewhat run-down and the buildings are in poor shape, there may be some difficulty in finding a suitable tenant. We have been advised, however, that the property could be sold now for about \$1200.00.

Would you kindly let me know whether the Custodian would now agree that this property should be sold, otherwise, it is liable to go to tax sale next year. In the event of a sale being agreed upon, would you please let me know the position as regards the Caveat filed by the Custodian in the interests of the patient's wife.

Awaiting to hear from you, I remain,

Yours truly,

E.H. Bridgman,
Inspector of Municipalities.

offer 603%

BH/II

10987
Evacuation Section

912 Royal Bank Building,
Vancouver, B. C.,
December 2nd, 1943

E. H. Bridgman, Esq.,
Inspector of Municipalities,
Dominion Bank Building,
Victoria, B. C.

Re: Seikichi KITAHARA, and
Your File No. K 1038 A

Dear Sir:

Your communication of the 19th instant has been referred to the writer for reply.

Provided the committee of the estate is satisfied that \$1200.00 is a good and sufficient price for this parcel of land, the Custodian will offer no objection to the sale, and in the event of a sale, will withdraw the Vesting Certificate now recorded in the Registry Office.

It is noted that the property is liable to go to Tax Sale next year. If necessary, we will obtain a special Vesting Order pursuant to Subsection 2 of Subsection 12, P.C. 2483, and protect the title against such sale under Section 51, of the Consolidated Regulations Respecting Trading with the Enemy (1939).

We enclose herewith copies of P.C. 2483, as well as a copy of the Consolidated Regulations Respecting Trading with the Enemy (1939) referred to above.

Will you be kind enough to keep us advised.

Yours truly,

K. E. WRIGHT
COUNSEL TO THE CUSTODIAN

KW/JF
Encls.

INSPECTOR OF MUNICIPALITIES



ENEMY SECTION

Rec'd JAN 3 1944

File No.

Ans'd

Refer'd

DOMINION BANK BUILDING
VICTORIA

December 31st, 1943.

K.W. Wright, Esq.,
Counsel to the Custodian,
Department of the Secretary of State,
Office of the Custodian,
912 Royal Bank Building,
Vancouver, B.C.

Your Ref: 10987 -
Evacuation Section.

Dear Sir:

re Estate of Seikichi Kitagawa.

I duly received your letter of December 2nd and note that the Custodian is prepared to withdraw the Vesting Certificate now recorded at the Land Registry Office against the property of the above-named, described as: Lot "A" of Lots 1 to 7, Block "C" of Lot 283, Group 1, Map 3531, District of New Westminster. *not vested*

Mr. Hal Menzies, Real Estate Agent, Naney, B.C., has now sold this property for the sum of \$1200.00 cash. We were also in touch with the Soldier Settlement Board who advised us that the best price they could offer was \$603.00. Under the circumstances, we propose to complete the sale.

The Certificate of Title is not on file at the Land Registry Office and we would appreciate it if you would let me know whether same is in your possession or if you can obtain it from Mrs. Seikichi Kitagawa who may have it.

Awaiting to hear from you, I remain,

Yours truly,

E.H. Bridgman
E.H. Bridgman,
Inspector of Municipalities.

EE/IDG

AUTHORIZED
of State and/or Custodian.

GRP/JY

10987
3695
Evacuation Section

809-10 Royal Bank Building,
Vancouver, B. C.
January 6th, 1944

E. H. Bridgman, Esq.,
Inspector of Municipalities,
Dominion Bank Building,
Victoria, B. C.

Your Reference - K 1082 A

Re: Estate of Seikichi KITAGAWA, and
Lot A of Lots 1 to 7, Block C of Lot 263,
Group 1, Map 3531, N. E. D.

Dear Sir:

We beg to acknowledge your letter of December 31st
last, and wish to advise you that we are withdrawing the caveat
filed against the above noted property.

We have written to Mrs. KITAGAWA requesting that she
send to us the Certificate of Title, and we will communicate with
you as soon as we have received her reply.

Yours truly,

K. W. WRIGHT
COUNSEL TO THE CUSTODIAN

CHP/JV

10987
3695

Evaluation Section

509-10 Royal Bank Building,
Vancouver, B. C.
January 6th, 1944

Mrs. Itau Kitagawa,
c/o Messrs. E. & H. Erb,
Oak Bluff, Manitoba

Re: Lot A of Lots 1 to 7, Block C of Lot 283,
Group 1, Map 5531, N. W. 14.

Dear Madam:

The Provincial Inspector of Municipalities, who is acting as Administrator of your husband's affairs, has requested us to ask you to send to this Office a Certificate of Title covering the above noted property.

If the Certificate of Title is not in your possession, please advise us where it is at present located.

Yours truly,

K. W. BRIGHT
COUNSEL TO THE CUSTODIAN

CHP/JT

IN REPLYING PLEASE REFER
TO FILE NO. K 1058 A

INSPECTOR OF MUNICIPALITIES



PROVINCE OF
BRITISH COLUMBIA

ENEMY SECTION

Rec'd JAN 11 1944

File No.

Ans'd

Refer'd

DOMINION BANK BUILDING
VICTORIA

January 10th, 1944.

K.W. Wright, Esq.,
Counsel to the Custodian,
Department of the Secretary of State,
Office of the Custodian,
912 Royal Bank Building,
Vancouver, B.C.

Your Ref: 10987
Evacuation Section.

Dear Sir:

To Estate of Seikichi Kitagawa.
Lot "A" of Lots 1 to 7, Block "C"
of Lot 283, Group 1, Map 3531,
District of New Westminster.

I thank you for your letter of January 6th and am pleased to note that you have agreed to withdraw the Caveat filed against the above property.

We have now confirmed the sale of this property for \$1200.00. Out of the Proceeds we will pay the outstanding taxes amounting to about \$50.00, and there will also be a commission to the estate agent of 5% - \$60.00, leaving a net of about \$1090.00.

Seikichi Kitagawa has been a patient at the Provincial Mental Hospital since December 21, 1939, and the maintenance account owing to the Hospital at December 31, is \$1472.00. The proceeds of the sale will therefore not be sufficient to meet the Hospital account and the latter is of course likely to increase as the latest report we have from the Medical Superintendent is that his prognosis is unfavourable, the patient being entirely mute. The Medical Superintendent also states that the patient's wife is anxious to return with him to Japan after the war.

As you know, the Attorney-General of British Columbia is ex-officio committee of the patient's estate since 1939 and the Security Commission has made no payment towards his maintenance account. Under the circumstances, would you kindly confirm that it is in order for the Attorney-General to dispose of the funds received and that the Custodian does not intend to make any claim to them.

I shall be pleased to receive the Certificate of Title when you obtain same from Kitagawa, which will enable us to complete the Conveyance in favour of the purchaser.

*Letter
sent
to wife*

Yours truly,

E.H. Braggman,
Inspector of Municipalities.

BH/LDG

10987
Evacuation Section

509-10 Royal Bank Building,
Vancouver, B. C.
January 13th, 1944

E. H. Bridgman, Esq.,
Inspector of Municipalities,
Dominion Bank Building,
Victoria, B. C.

Re: Estate of Seikichi KITAGAWA
Lot "A" of Lots 1 to 7, Block "C"
of Lot 283, Group 1, Map 3531, NWD

Dear Sir:

We wish to thank you for your letter of the tenth instant and have noted the contents thereof.

The Custodian does not intend to make any claim against the proceeds of the sale of the above noted property.

We have written to Mrs. Kitagawa asking her to send the Certificate of Title to this Office for forwarding to you, but to date we have received no reply.

Yours truly,

K. W. WRIGHT
COUNSEL TO THE CUSTODIAN

GHP/JT

10987
3535 (Drae)
Evacuation Section

509 Royal Bank Building,
Vancouver, B. C.,
January 30th, 1944

Mrs. Ito Kitagawa,
c/o Messrs. E. & H. Erb,
Oak Bluff,
Manitoba,

Re: Lot A of Lots 1 to 7, Block C Of Lot 283,
Group 1, Map 3531, N. E. E.

Dear Madam:

On the sixth instant we wrote you as follows:

"The Provincial Inspector of Municipalities, who is acting as Administrator of your husband's affairs, has requested us to ask you to send to this Office a Certificate of Title covering the above noted property.

If the Certificate of Title is not in your possession, please advise us where it is at present located".

Will you kindly see that the above mentioned Certificate of Title is mailed to us at once.

Yours truly,

K. W. WRIGHT
COUNSEL TO THE CUSTODIAN

CHP/JP

IN REPLYING PLEASE REFER
TO FILE NO. **K 1058 A**

INSPECTOR OF MUNICIPALITIES



DOMINION BANK BUILDING,
VICTORIA, BRITISH COLUMBIA,
CANADA

January 28th, 1944.

Your Ref: 10987 -
Evacuation Section.

K.W. Wright, Esq.,
Counsel to the Custodian,
Department of the Secretary of State,
Office of the Custodian,
912 Royal Bank Building,
Vancouver, B.C.

| | |
|---------------|-------------|
| ENEMY SECTION | |
| Rec'd | JAN 28 1944 |
| File No | |
| Ans'd | |
| Refer'd | MR Peers |

Dear Sir:

re Estate of Seikichi Kitagawa.

Referring to my letter of January 10th, we have now completed this transaction and the Conveyance has been executed in favour of the purchaser. Before giving this over to him however we would like to register the Certificate of Title and I would appreciate it if you would forward same to me as soon as you obtain same from Mrs. Kitagawa.

Thanking you for your co-operation in this matter, I remain,

Yours truly,

E.H. Bridgman,
Inspector of Municipalities.

BE/LDG

10987
Evacuation Section

509 Royal Bank Building,
Vancouver, B. C.
February 4th, 1944

L. H. Bridgman, Esq.,
Inspector of Municipalities,
Dominion Bank Building,
Victoria, B. C.

Re: Estate of Seikichi KITAGAWA
Your File No. K 1052 A

Dear Sir:

As requested by you, we wrote to Mrs. Itsu Kitagawa, wife of the above named, requesting that she mail to us the Certificate of Title, covering her husband's property. We attach hereto a copy of her reply dated January 30th last, to which you will, no doubt, wish to reply.

If we can be of any further assistance to you in this matter, kindly advise us.

We have on our file a claim against this man amounting to \$9.00, made by Dr. G. Morse, Haney, B. C., and we are writing him today advising him that you are administering this estate.

Yours truly,

K. W. WRIGHT
COUNSEL TO THE CUSTOMER

GHP/JT
Encl.

10987
Legal Department

509 Royal Bank Building,
Vancouver, B. C.
February 4th, 1944

Dr. G. Morse,
Honey, B. C.

Re: Seikichi KITAGAWA

Dear Sir:

With reference to your claim amounting to \$9.00, against the above, we beg to advise you that this man is an inmate of the Provincial Mental Hospital, and his affairs are being administered by Mr. L. H. Bridgman, Inspector of Municipalities, Dominion Bank Building, Victoria, B. C.

Should you desire to do so, we would suggest that you file your claim with Mr. Bridgman.

Yours truly,

K. W. WRIGHT
COUNSEL TO THE CUSTODIAN

GHP/ST

R 1088 A

COPY

INSPECTOR OF MUNICIPALITIES



DOMINION BANK BUILDING
VICTORIA, B.C., CANADA

February 18, 1944.

Mrs. Iku Kitagawa,
c/o Messrs. E. & H. Erb,
Oak Bluff, Nanaimo.

Dear Madam:

Re: Estate Seikichi Kitagawa

I have been advised by the Custodian, Department of the Secretary of State, Vancouver, B.C., that you are in possession of the Certificate of Title No. 1819668 to your husband's property at Pitt Meadows, B.C. During the time your husband is a patient at the Provincial Mental Hospital, Burnside, B.C. the Attorney-General of British Columbia, for whom this office acts, is an-officio committee of his estate and is charged with the duty of its administration. Under this authority the property in question has been sold and the Certificate of Title is required in order to give clear title to the purchaser. The money received will be placed to your husband's credit and used for his maintenance, clothing and comforts at the Hospital. I would appreciate it therefore if you would kindly forward the Certificate of Title to this office at your earliest convenience and we will send you our official receipt for same.

Yours truly,

E.H. Bridgman,
Inspector of Municipalities.

EH/II

IN REPLYING PLEASE REFER
TO FILE NO. K 1058 A

INSPECTOR OF MUNICIPALITIES



ENEMY SECTION

Rec'd FEB 16 1944

File No.

Ans'd

DOMINION BANK BUILDING

VICTORIA, BRITISH COLUMBIA

CANADA

February 15, 1944.

K.W. Wright, Esq.,
Counsel to the Custodian,
Department of the Secretary of State,
Office of the Custodian,
912 Royal Bank Building,
Vancouver, B.C.

Dear Sir:

Re: Estate of Seikichi Kitagawa
Your Ref: 10987 - Evacuation Section

I thank you for your letter of February 4th and as suggested I have today written a letter to Mrs. Itse Kitagawa which I enclose herewith. I would appreciate it if you would forward this on to her with a covering letter advising her that it will be in order for her to send the Certificate of Title to us.

Your assistance in this matter is much appreciated.

Yours truly,

A handwritten signature in cursive script, reading "E.H. Bridgman".

E.H. Bridgman,
Inspector of Municipalities.

BH/II
Encl.

C
O
P
Y

February 27, 1944
Oak Bluff, Man.

Dear Mr. Bridgman:

I am forwarding the title of Certificate to you and to the Custodian. I trust that you will notify the Attorney-General of British Columbia who is charged with the duty of my husband.

I have nothing to say about the property's value been used for my husband's hospital fee for it's his title. But what I like you to understand is that our living in Manitoba is very hard and we have to have help in our food from the government. So it is impossible for us to pay for my husband's hospital needs. If my husband was able to come out from the hospital in the future. I hope that he can be free to come out and join me in spite of the possibility of not paying back or the property's credit is not enough to pay all the expense.

We have made arrangements to go back to Japan, hoping that my husband could join me so if this was to happen, I hope that he will be able to come out in this case, also.

I will be waiting for the receipt so that I will have the paper to show my husband what has happened.

Thanking you, I remain,

Yours sincerely,

"Mrs. Itsu Kitagawa"
c/o Messrs. E. & H. Erb,
Oak Bluff, Man.

10967
Evacuation Section

509 Royal Bank Building,
Vancouver, B. C.
February 17th, 1944

Mrs. Itau Kitagawa,
c/o Messrs. R. & H. Erb,
Oak Bluff, Manitoba

Dear Madam:

We enclose herewith a letter addressed to you
from Mr. E. R. Bridgman, Inspector of Municipalities, requesting
that you forward to him the Certificate of Title to your husband's
Pitt Meadows property, and setting out his reasons for his request.

Will you kindly follow out the instructions given
in Mr. Bridgman's letter?

Yours truly,

K. W. WRIGHT
COUNSEL TO THE CUSTODIAN

GWP/JF
Encl.

February 27, 1944.
Oak Bluff, Mass.

To - Office of the Custodian

| | |
|---------------|--------------|
| ENEMY SECTION | |
| Rec'd | MAR 2 1944 |
| File No. | 10987 (Kore) |
| Ans'd | ✓ |
| Refer'd | MR. Peers |

Dear Sir:

I have received your letter and
have read Mr. Bridgman's letter and
now I understand the situation as an-
• pending the Certificate of Title.

Enclosed, I have a letter to Mr.
Bridgman, the Inspector so please see
that he reads it.

Yours sincerely,
Mrs. Isaac Kitayama
File no - 10987

10967
Evacuation Section

509 Royal Bank Building,
Vancouver, B. C.
March 2nd, 1944

L. H. Bridgman, Esq.,
Inspector of Municipalities,
Dominion Bank Building,
Victoria, B. C.

Re: Estate of Seikichi Kitagawa
Your File No. K 1086 A

Dear Sir:

Enclosed please find Certificate of Title No. 121956-E
for the property described as Lots 1 to 7, Block C of Lot 283,
Group 1, Map 3531, New Westminster District, as requested by you.

We also enclose, at the request of Mrs. Kitagawa,
her letter, dated February 27th, 1944, addressed to you.

Kindly acknowledge receipt of the above-mentioned
Certificate of Title.

Yours truly,

K. W. WRIGHT
COUNSEL TO THE CUSTODIAN

OWP/JF
Encl.
REGISTERED

10987
Evacuation Section

809 Royal Bank Building,
Vancouver, B. C.
March 2nd, 1944

Mrs. Ito Kitagawa,
c/o Messrs. E. & H. Erb,
Oak Bluff, Manitoba

Dear Madam:

We beg to acknowledge receipt of your letter of February 27th last, enclosing Certificate of Title No. 121956-E, covering the property described as Lot A of Lots 1 to 7, Block C of Lot 283, Group 1, Map 3531, New Westminster District, and also your letter to Mr. Bridgman, Inspector of Municipalities, both of which have been forwarded to him.

We wish to thank you for your co-operation in this matter.

Yours truly,

K. W. WRIGHT
COUNSEL TO THE CUSTODIAN

OWP/37

IN REPLYING PLEASE REFER
TO FILE NO. K 1058 A

INSPECTOR OF MUNICIPALITIES



| | |
|--|------------|
| ENEMY SECTION | |
| Rec'd | MAR 7 1944 |
| File No. | 10987 |
| Ans'd | MR Peers |
| Refer | |
| DOMINION BANK BUILDING, VICTORIA, BRITISH COLUMBIA, CANADA | |

March 4th, 1944.

K.W. Wright, Esq.,
Counsel to the Custodian,
Department of the Secretary of State,
Office of the Custodian,
912 Royal Bank Building,
Vancouver, B.C.

Dear Sir:

re: Estate of Seikichi Kitagawa,
Your Ref: 10987 - Evacuation Section.

I beg to acknowledge receipt of your letter of the 2nd instant enclosing a letter from Mrs. Kitagawa together with the Certificate of Title No. 121956E, dated August 24th, 1937.

I have replied to Mrs. Kitagawa and attach a copy of my letter for your information.

Again thanking you for your co-operation in this matter, I remain,

Yours truly,

E.H. Bridgman,
Inspector of Municipalities.

BH/LDG
Encl. 1.

K 1000 A

COPY

INSPECTOR OF MUNICIPALITIES



DOMINION BANK BUILDING
VICTORIA, B.C., CANADA

Essex 4th, 1944.

Mrs. Iwa Kitagawa,
c/o Messrs. E. & E. Ish,
Oak Street, Nanaimo.

Dear Madam:

Re Estate of Seikichi Kitagawa.

I have received your letter of the 27th February through Mr. E. V. Wright, Counsel to the Custodian, and herewith acknowledge receipt of Certificate of Title No. 121204-2 dated August 20th, 1937, in respect of your husband's property at Plot No. 1000.

Any balance owing to the Hospital for your husband's maintenance at the time of his discharge would, of course, be a charge against him, but the Hospital authorities would no doubt be prepared to consider some arrangement regarding this, dependent on his ability to pay. Should your husband return to Japan later on, the Assessment Committee would probably agree to waive any balance then owing.

Yours truly,

E. E. Wright,
Inspector of Municipalities.

EE/LDS

REGISTERED MAIL

10987 & 2229

April 1, 1944.

Pacific Co-operative Union,
Mission City, B. C.

Dear Sirs:

Re: Seikichi and Yasuhiro KITAGAWA.

Enclosed herewith please find three share certificates, as follows:

| | |
|---------------------------|-------------------------|
| Share Certificate No. 579 | - 1 share numbered 1224 |
| " " " 611 | - 1 share " 1305 |
| " " " 709 | - 2 shares " 1444-1445 |

Your cheque to cover the above would be appreciated.

Please inform us of the registered owner of these shares as, according to our records, S. Kitagawa is shown in one place and Y. Kitagawa in another. It is also noted that the share certificates have been changed from "S" to "Y".

Yours truly, -

W. E. Anderson,
Farm Department.

Enc. 3.
WEA/EG

*Shares registered in name of
Y. Kitagawa 3rd 2229
DCO letter Apr 4/44*

10987
Evacuee Section

509 Royal Bank Bldg.,
Vancouver, B. C.
January 26th, 1945

H. H. Bridgman, Esq.,
Inspector of Municipalities,
Dominion Bank Building,
Victoria, B. C.

Re: Estate of Seikichi KITAGAWA
Your File No. K 1058 A

Dear Sir:

The above account shows a debit of \$1.00 in our books,
being charges for a Certificate of Encumbrance obtained in connection
with property described as Lot "A" of Lots 1 to 7, Block "C" of Lot 283,
Group 1, Map 3531, Municipality of Pitt Meadows, in the District of New
Westminster, registered in the name of Seikichi Kitagawa.

We would be pleased to receive your cheque to cover.

Yours truly,

K. W. WRIGHT
COUNSEL TO THE CUSTODIAN

KWW/JF