

THE OFFICE OF THE ATTORNEY GENERAL, WASHINGTON, D. C.

UNITED STATES DEPARTMENT OF JUSTICE

13566

FILE NO.

FILE NO.

FILE NO.

FILE NO.

FRASER VALLEY

OFFICE OF THE CUSTODIAN
JAPANESE SECTIONFILE No. 13566
EXHIBIT No. 1160-5
DATE OCT 22 1948
FILLED BY H. H. Christie

Completed by persons of the Japanese race having property in any protected area. The proper administration of this property requires such persons to give full particulars as requested in this form.

PERSONAL INFORMATION

NAME: Yasukichi Goto
HOME ADDRESS: R.R. No. 1, Gibson Rd., New Westminster, B.C.
REGISTRATION NUMBER 12603 SEX: male AGE: 44
OCCUPATION: Farmer

(If any business or businesses carried on, state where, under what name and whether carried on by yourself or in partnership with anyone; if partnership, give partner's name.)

EMPLOYER:

MARRIED? Yes

NAME OF WIFE OR HUSBAND: Miyoshi Goto

ADDRESS OF WIFE OR HUSBAND: R.R. No. 1, Gibson Rd., New Westminster, B.C.

NAMES OF ANY LIVING CHILDREN:

Yone, Tenji, Tomoko, Sakae
Masayo Goto

ADDRESS OF CHILDREN: R.R. No. 1, New Westminster, B.C.

AGE OF CHILDREN: 18, 15, 14, 11, 8

STATEMENT OF ALL REAL PROPERTY (Each parcel must be mentioned and particulars given)

1. LOCATION AND DESCRIPTION: Situated on Gibson Rd.,
Kennedy District of Delta, New Westminster
Lot No. 113.

2. BUILDINGS AND OTHER IMPROVEMENTS: house
5 chicken house, feed-house, wood shed
Incubator-house, Pump house with
electric pump & tank & pipes to house & chicken house

3. INSURANCE (Give particulars; state where policies are)

4. TAXES (Amount and where payable) \$16.43 Payable Delta Municipality

5. ENCUMBRANCES (Including any unregistered claims or deposit of title deed)

6. OCCUPANCY AND LEASES (If vacant so state)

Leased to D. Hubbard at \$10 a month
and pay the taxes

STATEMENT OF REAL PROPERTY OCCUPIED

7. STATE WHEREABOUTS OF TITLE DOCUMENTS: *None*
8. STATE IF ANY OTHER PERSON HAS ANY INTEREST: *None*
9. IF FARM LAND STATE CROPS SOWN: *grain, alfalfa, fruit trees, sweet*

1. LOCATION AND DESCRIPTION:

2. LANDLORD'S NAME AND ADDRESS:

3. PARTICULARS OF LEASE AND RENT AND DATE TO WHICH PAID:

4. STATE WHEREABOUTS OF LEASE:

5. SUB-TENANTS, IF ANY (Give name, address, rent and to what date paid)

6. IF FARM LAND, PARTICULARS OF CROPS SOWN:

STATEMENT OF PERSONAL PROPERTY OWNED:

1. GIVE BRIEF DESCRIPTION AND STATE LOCATION OF FURNITURE, FIXTURES, EQUIPMENT AND MACHINERY, STOCK IN TRADE AND PERSONAL EFFECTS:

*Electric water pump & tank with pump house
4 electric fans, 3 incubators & farm table
with incubator house, 3 coal burners
2 in. show house, 1 in. the egg grading room*

2. HORSES, LIVESTOCK AND OTHER ANIMALS, POULTRY AND PETS

3. GIVE THE NAME AND ADDRESS OF ANY PERSON HAVING ANY INTEREST IN, OR

CLAIM ON ANY SUCH PROPERTY

4. INSURANCE CARRIED ON ABOVE PROPERTY: _____
5. MORTGAGES, LIENS AND OTHER CLAIMS ON PROPERTY IN POSSESSION OF OTHERS: _____
6. MONEYS OWING TO YOU (State if any of these debts assigned and if so, to whom) _____
7. BONDS, DEBENTURES, SHARES, STOCKS OR OTHER SECURITIES (State whereabouts) _____
8. BANK ACCOUNTS: _____
9. LIFE INSURANCE: Sun Life Assurance Co.
Policy No. 2215567 - Full of Policy, 1000 ✓
10. INTEREST IN ANY ESTATES OR TRUSTS: _____
11. SAFETY DEPOSIT BOX: _____

LIABILITIES:

1. PERSONAL DEBTS: _____
2. TRADE DEBTS: _____

I, the undersigned, hereby voluntarily turn over to the Custodian all my property in the protected area as set out above, excepting fishing vessels, deposits of money, shares of stock, debentures, bonds or other securities, if any.

I certify that the above information is true and complete and fully discloses all my property of every description in any protected area in British Columbia and sets forth all my liabilities direct and indirect.

Dated this 1 day of December 1942.

(Signature)

Yasukichi Goto

Witness

FOR DEPARTMENTAL USE

INFORMATION FROM R.C.M.P.

DATE Nov. 20, 1942

File No. 13566

Full Name GOTO, Yasukichi
(Surname in Block Letters)

Registration No. 12603

Male - Female
(Check)

Age Mar. 27, 1898

Former Address R. R. #1, New Westminster, B. C.

Date Evacuated _____

Naturalized - Canadian-Born - National
(Check)

Present Address _____

Essondale

Married - Single
(Check)

Name of Wife SATO, Mivoshi --12602

Name of Husband _____

Name of Mother SATO, Iki Tomeo

Name of Father Rikichi Japan

Names of Children under 16 _____

(dec'd)

Tokuji (m) Jan. 26/27

Tonoko (f) Dec. 9/28

Sakae (f) May 4/31

Masaye (f) July 28/34

Requested by W. E. Anderson

Registered with Custodian

No
(Yes or No)

Additional Information Farmer. (5 acres, house, poultry)

173/121

BC-433-1
BC-1603-B

COPY

BC/433-P
BC/1603-B

Page 1

S.S. Form No. 43
(Sheet 1)

Farm Appraisal Report

File No. J.L.718

Land Description Lot 113 of S.E. 1/4 of Sec. 36, D.L. 440, Grp. 2, Map 1133.

Containing 4.75 Acres

Owner's Name Yasukichi GOTO

Post Office Address R.R. 1, New Westminster, B.C.

New Westminster - C.P.R. & shipping.

3 1/2 miles

Nearest Rail Point Kennedy Station - B.C.E.R.

Distance 1/2 mile

Market Town New Westminster

Distance 3 1/2 "

Church (give denomination) New Westminster - All Denominations

Distance 3 1/2 "

Nearest School Kennedy Public School

Distance 1/2 "

State how property was identified: Map location and corner posts

DATE

1160-2

Apr. 22/48

Roads: State whether property has access to main road, the kind of road and its condition.

FILED BY

K. P. Christie

The direct access to Gibson Road - fair gravel road.

In this district a good one? Poor farming location; fairly good for poultry raising

Employment opportunity City industries at 3 1/2 miles

Predominating Nationality and religion: Japanese owners predominate

Describe Fencing and its condition: No fencing

Value \$

Water supply: 2 wells, said to be doubtful supply

Value \$

Electricity: Power available - lights installed.

BUILDINGS ON FARM

BUILDINGS	DIMENSIONS	MATERIAL	HEIGHT	ROOF	AGE	Foundation	REPAIR	VALUATION
HOUSE	18 x 30	Frame	1 1/2 st.	Shale.	20 yr.	Wood	Poor	400.00
Addition	12 x 30	"	1 "	"	20 "	"	"	"
Barnhouse -	18 x 100	"	1 "	"	20 "	"	"	200.00
Wash "	18 x 20	"	1 "	"	10 "	"	Fair	175.00
Feed shed	18 x 20	"	1 "	"	5 "	"	Good	100.00
same Barnhouse	20 x 20	"	1 "	"	10 "	"	Fair	175.00
" "	20 x 100	"	1 "	"	15 "	"	Poor	180.00
Wash " "	20 x 20	"	1 "	"	20 "	"	"	120.00
Shed	12 x 20	"	1 "	"	20 "	"	"	20.00
"	"	"	"	"	"	"	"	"
4 Colony Houses	12 x 15	"	1 "	"	15 "	"	@ \$10 each	40.00
"	"	"	"	"	"	"	"	"

Total present day value \$ 1380.00

Total Value Buildings add to farm

\$ 500.00

In dwelling habitable without repairs? Yes If not what is your approximate estimate of cost to make it habitable?

\$

Describe the basement and chimneys: No basement; chimney is stove pipe.

No. rooms downstairs? 4 Upstairs? 2 How finished Wood downstairs; not finished upstairs.

Are buildings painted? None Condition of paint -

Distance from nearest bush House approx. 100 yards; barnhouse adjacent to bush.

Note: Particular care must be taken when examining and reporting on foundations, sills and roofs.

ACRES	LEVEL, UNDULATING, ROLLING OR HILLY	SOIL (State Depth)	SUB- SOIL	KIND AND QUALITY OF CROP	VALUE PER ACRE	TOTAL
.30	Level	Sandy 8" to 10"	hardpan	Mixed garden	\$80	44.80
1.37	Slight rise	Gravel and stone	Gravel over hardpan	Buildings & yards Some stumps & scrub	\$80	41.30
Area which can be cultivated without cost other than for breaking.						
	LEVEL, UNDULATING, ROLLING OR HILLY	SOIL (State Depth)	SUB- SOIL		VALUE PER ACRE	
Area which can be cultivated after a reasonable amount of clearing timber, stones, drainage, etc.						
	LEVEL, UNDULATING, ROLLING OR HILLY	SOIL (State Depth)	SUB- SOIL	NATURE OF RECLAMATION NECESSARY	RECLAMATION COST PER ACRE	VALUE PER ACRE
2.48	Slightly Undulating	Sandy to gravel	Gravel over hardpan	Clearing, stumping, breaking, stoning.	\$75 to \$150	\$5
Area Unsuitable for Cultivation.						
CHARACTER OF LAND E. G. HEAVY, SWAMPY, ROCKY.			NATURE OF TIMBER IF ANY AND WHETHER MARKETABLE		VALUE OF LAND PER ACRE	

4.75 acs.

Total value of Land \$ 99.05

Total added by buildings to value of farm \$ 800.00

Total fruit trees add to value of farm (for use in orchard districts only) \$

Total value of farm \$ 899.05

Describe condition of farm commencing on tillage, length of time unoccupied or partly occupied:
Property occupied by tenant. Land in poor condition; little attempt at cultivation this year.
Apparently very poor in fertility.

State most suitable type of agriculture for farm bearing in mind the district's limitations, if any.
Not suitable for farming, but fairly good for poultry raising.

Notion weeds:
No serious weed condition

Give approximate detail and
amount of all annual taxes and
name of Taxing Authority

Corporation of Delta

Assessed - Improvements - \$1800

Land - 261

Taxes 1942, \$16.45

Date: July 30th, 1942.
Place: New Westminster, B.C.

I certify that the above report is based on a personal examination
of the whole farm made on the 29th day of July 1942.

Inspector's Signature

"D. DODDING"

Note: (Use Form 43 (Sheet 2) in connection with this form.)

Farm Appraisal Report

Remarks: This is a small holding with little land development, and equipped as a poultry proposition. The poultry houses are in fair condition but have never been first class structures. The dwelling is a very poor type of building and poorly constructed. The property lies on a rise of land which runs north and south through this area with a stone and gravel ridge protruding at the height of land which takes in most of this holding. The water situation is very poor here, and wells are said to go dry for a month or six weeks during the summer.

The property is rented to D. Hubbard for \$10 a month, plus taxes, to the end of the current year.

EXPERT No.

100

~~FILED~~

(FOR ORCHARD LANDS ONLY)

REMARKS: re general lie of land, fertility of soil, irrigation, drainage or dyking and reclamation.

VII.

ANNUAL COST OF IRRIGATION, DYKING AND DRAINAGE.

NIL

ORCHARDS, SMALL FRUITS, ETC.

(Give number, age, variety and condition of all tree fruits, condition and area of each kind of small fruits.)

Present Value

Mixed garden - very poor - .69 ac.

Buildings, yards, etc.

A few stumps & considerable scrub - 1.57

Bush

2.49

4.75 acres

Total \$

Amount fruit trees add to value of farm \$

Diagram of Property

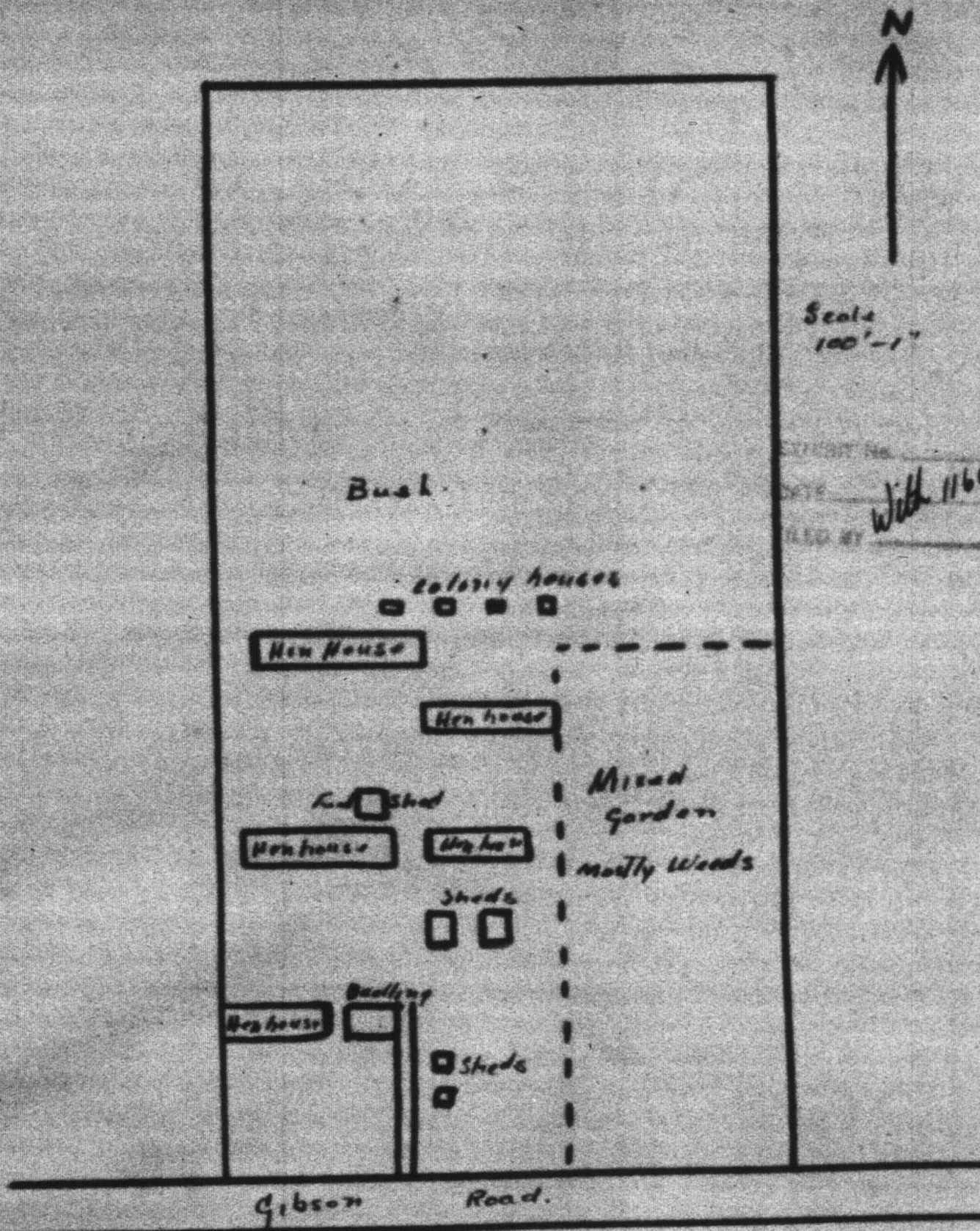

Lot 113 of SE 1/4 of Sec. 36. DL. 1160.
Gp 2. Map 1133- - 4.76' ac.
Yasukichi Goto.

Following careful review of this appraisal report, it is my opinion that the present value is \$ 500.

Date 1st August 1948.

"T. T. BARNETT"
District Superintendent.

PERSONAL PROPERTY SUMMARY

Files 7706 & 13566

June 13, 1949

File 7706 - Mivoshi (Mrs. Yasukichi) GOTO #12602 - JP signed May 5, 1942
Evacuation date - June 9, 1942

In her JP Mrs. Goto declared the real property later found to belong to her husband.

Mrs. Goto, also, declared farming tools and implements and household furniture left at the farm at Strawberry Hill, Surrey, B.C.

File 13566 - Yasukichi GOTO #12603 - Evacuated March 13, 1942
Committed to Provincial Mental Hospital April 28/42.
JP, dated December 19, 1942, signed by one of his daughters (according to evidence at hearing).

JP reports real property registered in name of Yasukichi Goto, and also farm equipment. The real property is dealt with in the Real Property Summary. Rentals and proceeds of sale of real property have been credited to the account of Yasukichi Goto.

The proceeds of the sale of farm equipment and household effects were credited to the account of Mrs. Goto, and all funds from her account were remitted to Mrs. Goto July 17, 1947. Statement of account June 25, 1947, shows that Mrs. Goto received \$100.59, made up of \$96.09 net proceeds of sale of farm and household goods, and \$4.50 rent of a brooder.

Breakdown of the sales shows that Mrs. Goto's account in the \$96.09 credit received proceeds of sales of farm and household goods as follows: prices shown are gross

Farm Equipment (incl. one brooder) - at auction -	\$55.00	
One Electric Brooder by appraisal	20.00	
Two Electric Brooders (sold through Mackman-Ker)	15.00	
Total	\$90.00	
Household Effects at auction +	\$28.00	28.00 \$118.00

The attached schedule shows the individual items declared, listed on inventory signed by Mrs. Goto and her tenant, and inventoried by Custodian agent.

Household goods - Inventoried by Custodian but later missing - 2 heaters and 1 kitchen chair

Farm Equipment - Inventoried by Custodian but later missing - 3 Incubators

(We did sell 3 brooder stoves, which may have been the only saleable part of the incubators)

Electric Water Pump was sold as a fixture with real property.

Jan. 11/43 Mrs. Goto wrote stating she had no legal interest in her husband's property, except that before he had left for the road camp he had made a will leaving everything to Mrs. Goto and the children.

/FM

G. MacLean

Files 7706 & 13566

JP, May 5/42
Mrs. Goto File 7706
4 Incubators
4 Electric Brooders
3 Coal Brooders
Farming Tools
& Implements

JP, Dec. 19/42
signed in behalf
of Yasukichi Goto
Electric Water Pump
& Tank with pipes
4 Electric Brooders x
3 Incubators x
Farms Tools x
3 Coal Brooders x

(x declared also by
Mrs. Goto as shown)

CHARTERED DOCUMENTS

Yasukichi & Miyoshi 9270, 912601 & 912602

Inventory signed
by Mrs. Goto & Yasukichi
3 Incubators
4 Electric Brooders
3 Coal Brooders
Beatty Motor Model 77 608 T.M. & HP
Automatic Controller T.140,
Ser. #140-3582

1 Cultivator
2 Japanese Hoes
1 Pick
1 Complete Water System
except hot -
2 Wedge Hammer
3 Wedges
2 Axes
4 Japanese Scythes
8 Kinds of Hoes(?) for Chicken House
6 Wood Water Troughs
13 Tin Water Troughs
1 7' Cross-cut Saw
2 4' " "
2 Spades
3 Shovels
2 Iron Bars
1 Brush
1 Peavey
1 Garden rake (no handle)
20 Wooden Egg Trays
4 Metal Egg Trays
25 Baby Chick Feed Trough
1 Spray Map
4 Brooder Thermometer
140 16x16 Plate Glass
6 Tin Feed Troughs 5'
11 Wooden Feed Troughs
56 Water Taps
11 Mash Troughs
50' Rubber Hose
1 Wheel-barrow
3 -10-gal Milk Cans

1 Cultivator
2 Japanese Hoes
1 Pick
1 Complete Water System
except hot -
2 Wedge Hammer
3 Wedges
2 Axes
4 Japanese Scythes
8 Kinds of Hoes(?) for Chicken House
6 Wood Water Troughs
13 Tin Water Troughs
1 7' Cross-cut Saw
2 4' " "
2 Spades
3 Shovels
2 Iron Bars
1 Brush
1 Peavey
1 Garden rake (no handle)
20 Wooden Egg Trays
4 Metal Egg Trays
25 Baby Chick Feed Trough
1 Spray Map
4 Brooder Thermometer
140 16x16 Plate Glass
6 Tin Feed Troughs 5'
11 Wooden Feed Troughs
56 Water Taps
11 Mash Troughs
50' Rubber Hose
1 Wheel-barrow
3 -10-gal Milk Cans

June 13, 1949

Custodian
Inventory July 2/42
3 Incubators
4 Elect. Brooders
No record
4 sold for \$55.00

Probable part of pump
system fixture on property

Hand Cultivator Tools
\$5.50
Tools \$5.50

Fixture on property

1 Sledge Hammer

See tools sold

See troughs sold

2 Saws & Peavey-\$5.00
See tools sold

See tools sold
" " "

Sold with saws

See sundries & troughs sold

Sprayer - \$2.50
Chick Troughs - \$3.00

3 Bx. Glass-\$6.50

See troughs sold.

Hose Pipe - \$4.00

Wheelbarrow -\$2.00

Milk cans abandoned.

3 Brooder Stoves-\$1.00

Miyoshi

Files 7706 & 13566

JP, May 5/42

Mrs. Goto, File 7706

3 Stoves
3 Tables
6 Chairs
1 Desk
Book-case
Household Furniture

CHARTER SCHOOL

Yamaguchi & Miyabe GOTO, #12601 & 12602

Inventory signed by

Mrs. Goto & Infant

1 Stove
2 Tables
4 Chairs
1 Desk
1 Book-shelf
3 Beds with Spring
1 Chiffonier
1 Closet
1 Eagle Stuffed

Custodian

Inventory July 2/42

2 Benches
2 Tables
4 Kitchen Chairs
1 Desk
3 Beds, 1 Spring
1 Chest of Drawers
1 Wardrobe
1 Stuffed Eagle
1 Gramophone
1 Linoleum Rug
1 Fr. Rubber Boots
1 Auto Tire
1 Bicycle Tire
5-gal. Oil Can

From RCMP

Camera

Matsumoto

Shipped to Mrs. Goto

June 13, 1949

Sales

(3 Brooder stoves sold)

4 Tables 1.25

3 Chairs-- \$3.00 (1 chair missing)

Desk 1.00

Magazine Rack --.25

Bed & Spring \$12.00 - 2 beds abandoned

Chest of Drawers \$1.00

Wardrobe abandoned

Eagle abandoned

Photograph \$5.50

Radio abandoned

Misc. Items, Dishes

Pots, Etc. \$4.50

MEMORANDUM

September 14, 1943.

TO: File No. 13566

FROM: Specified Articles Department.

Re: GOTO Yosukichi, Reg. No. 12603

<u>ARTICLE</u>	<u>DESCRIPTION</u>	<u>APPRAISED VALUE</u>
CAMERA	#3 Autographic Kodak Model C (Poor Condition) F7.7 lens	\$2.00

In 992 Powell St.
July 4/45 Jan

Shipped July 14/47
to Mrs. Goto.

From

RS

REAL PROPERTY SUMMARY

JAPANESE NAME: Yasukichi GOTO Reg. No. 12603 File No. 13566.

CATALOGUE NO: Sold by Special Arrangement, The Director, The Veterans' Land Act.
First Offer BC/433-P.

PROPERTY ADDRESS: 1327 Gibson Road, New Westminster, B.C.

LEGAL DESCRIPTION: Lot 113 of Lot 440, Group 2, Map 1133, Municipality of Delta, D.N.W.

TITLE: Registered in the name of Yasukichi GOTO.

ENCUMBRANCES: None registered. No indication of any unregistered charges.
Vesting Order filed No. 25236, dated December 19th, 1942.

ASSESSED VALUES: Land \$ 261.00
Improvements \$1500.00 - \$1761.00. Taxes - \$16.43.

CLASSIFICATION: This is a small fruit farm with dwelling and out-buildings. The Custodian's representative reported July 7th, 1942, that this property had an area of 4.75 acres (mostly cleared) and planted to the following crops: 1 acre strawberries and black currants (Mixed). 1/8 acre raspberries and gooseberries (Mixed). 1 dozen mixed fruit trees.
1 - 1½ storey 7-room dwelling 30'x36'. 1 storage shed. 1 straw shed. 1 woodshed. 1 feed house (new 2 rooms) 18'x18'. 1 chicken house 120'. 1 chicken house 72'. 1 chicken house 100'. 2 chicken houses 60'. 3 colony houses.
"Everything becoming grown over, most buildings becoming poor for lack of care. Upstairs of house unfinished".

HISTORY OF ADMINISTRATION: Miyoshi GOTO, file 7706 (Wife of Yasukichi GOTO), leased this property to Donald Palmer Hubbard, 8th June 1942, for a term of 1 year from June 8th, 1942. Consideration \$120.00 - \$50.00 paid in advance 8th June 1942, and balance of \$70.00 payable at rate of \$10.00 monthly from November 8th, 1942. This lease was replaced by Lease No. 522 given by the Custodian to Donald P. Hubbard on May 13th, 1943, for a term of 1 year and 207 days from June 8th, 1943, to December 31st, 1944. Consideration \$188.00 payable \$10.00 monthly for 18 months commencing July 8th, 1943, and final payment of \$8.00 on December 8th, 1944, in addition \$2.50 per month for taxes for years 1942, 1943 & 1944.

Original lease handed to The Director, The Veterans' Land Act, August 18th, 1943, and Lease No. 522 was handed to The Director, The Veterans' Land Act, 29th July 1943.

SOLD: To The Director, The Veterans' Land Act for \$587.00 as at 1st January 1943.
Approval of Advisory Committee - 1st June 1943.

Funds released to the credit of Yasukichi GOTO as at April 17th, 1944, against which were the following charges: Registration Fees \$3.00,

Legal Fees \$15.00, Arrears of Taxes \$18.88 = \$36.88, leaving a net credit of \$550.12 from said transaction.

In view of the rents having been collected by the Custodian up to August 8th, 1943, viz., \$75.00, the following cheques covering same were issued by the Custodian: Cheque to Donald P. Hubbard, June 8th, 1943, \$26.75 being payment in full of repairs to roof of GOTO'S house, and cheque covering the balance of the rents collected, viz., \$48.25, was issued to The Director, The Veterans' Land Act, 17th November 1943.

Certificate of Title No. 168962E in the name of The Director, The Veterans' Land Act.

This summary is certified to be in accordance with information on file.

March 14th, 1947.

DAC:JS

D. A. CRAMER.

FIRE INSURANCE SUMMARY

File No. 13566.

Yasukichi GOTO - Ser. No. 12603.

On the SF Form signed by Miyoshi GOTO, file 7706
(wife of Yasukichi GOTO), 24 May 1942, she declared that
Yasukichi GOTO carried no Fire Insurance, and none was placed
by the Custodian.

This summary is certified
to be in accordance with
information on file.

March 14th, 1947.

D. H. CRAMER
D. H. CRAMER

MAC:JE

LIABILITY SUMMARY

File No. 13566.

Yamichi GOTO - Reg. No. 12603.

On the JP Form signed by Miyoshi GOTO, file 7706 (wife of Yamichi GOTO), 5th May 1942, covering her husband's property, she declared that there were no personal or trade debts, and we can find no evidence of any claims having been filed against him.

This summary is certified
to be in accordance with
information on file.

March 14th, 1947.

DAG:JS

D. A. CRAMER.

PERSONAL PROPERTY SUMMARY

File No. 13566

25th June, 1947.

Re: Yasukichi GOTO - Reg. No. 12603

CHATELS:

The above Japanese registered with this office on the 19th December, 1942, and at that time declared leaving an electric water pump, farm implements, brooders and incubators on his property in Surrey.

The electric pump was sold as a fixture with the property. As Miyoshi GOTO, Yasukichi GOTO's wife, File No. 7706, had also declared the above implements as well as household furniture, and as Yasukichi GOTO is a patient at the Provincial Hospital, Essondale, all chattels are being handled under her file.

ACCOUNTS RECEIVABLE:

The B.C. Security Commission remitted to this office, the sum of \$1.72, on the 20th October, 1942, being for March and April wages.

LIFE INSURANCE:

When registering, Yasukichi GOTO, declared a Sun Life Insurance policy, but this was not brought under control by the Custodian.

This file reveals no other personal property assets.

The above summary is certified to be in accordance with the information on file.

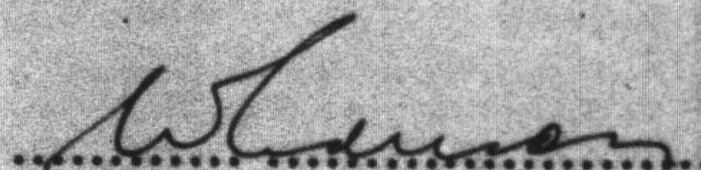
.....

HA

(Information supplied by Ins. Co.)

LIFE INSURANCE

Name GOTO, Mr. Yasukichi

File No. 13566

Essondale B.C.

Reg. No. *12603*

Company Sun Life

Agency Vancouver

Policy No. 2205567

Premium - \$ 53.45

Payable: ^X Annually, Semi-annually or monthly

Month December Day 1st

REMARKS:

3

Letter sent 26/8/43

ROYAL CANADIAN MOUNTED POLICE

EXHIBIT REPORT

No. 166

HEADQUARTERS File No.

SUB-DIV'N and File No. Vancouver

DIVISION and File No.
J.R. No. 12503

DETACHMENT and File No. C.I.B.

DATE July 13th. 1944.

Insults COTO - New Westminster, B. C.

Re: Mar. 9th. 1942.

(Name of File)
D. B. MacLaren Cat.

On (Date)

(Member's Name)

Came into possession of the following described goods by

Handed over by Magojira HISHIGUCHI

(State Authority from whom seized and place of seizure)

No. OF EXHIBIT	No. OF PACKAGES	CAPACITY OR SIZE	DESCRIPTION OF EXHIBITS
	1		No. 3A Autographic Kodak Model C. Poor Condition. 13526 File 13566

REMARKS: Handed over to Custodian of Alien Property.

DATE July 11th. 1944.

(State briefly disposition)

E. B. Lewis for Custodian

(Signature of Recipient or Witness)

CERTIFIED CORRECT
I.H. Jefferson 10559 Cat.

(Signature of Member)

CANADA
DEPARTMENT OF THE SECRETARY OF STATE
OFFICE OF THE CUSTODIAN
JAPANESE EVACUATION SECTION

Form PACIFIC 6121

PLEASE REFER TO

File No. 13566
7706

808 ROYAL BANK BLDG.,
HASTINGS AND GRANVILLE
VANCOUVER, B.C.

25th November, 1942.

Mrs. Yasukichi Goto, #12603,
Slocan, B.C.

Dear Madam:

re: Mr. Yasukichi GOTO.

In order that we may complete our files we would appreciate receiving the following information from you in connection with your husband:-

1. The approximate date of departure by your husband from New Westminster. *March, 13, 1942.*
2. His address whilst outside the protected area. *Black's Camp, Blue River*
3. The period of his stay outside the protected area. *1 month or so.*
4. The date of his return. *April, 14,*

We note that when you registered your assets with us on May 5th that you declared your husband was at that time in the New Westminster Hospital.

Although you have registered your assets with us, we do not appear to have any record of receiving your husband's registration. We are, therefore, enclosing three copies of our regular "J.P." Registration Form, and we ask that you be good enough to complete all three copies on behalf of your husband, thereafter to sign said statements on behalf of your husband, and then return two copies to us at the earliest possible date and retain the third copy for your own use.

The records we have on file indicate that the property known as 1327 Gibson Road, New Westminster, is registered in the name of your husband. We would appreciate your advising us whether or not our records are correct and whether you have any legal interest in the real estate mentioned above.

Yours truly,

R. P. Alexander,
Manager.

RPA:GF

Encl:

13566 ✓
7706

25th November, 1942.

Mrs. Yasukichi Goto, #12603,
Slocan, B.C.

Dear Madam:

re: Mr. Yasukichi GOTO.

In order that we may complete our files we would appreciate receiving the following information from you in connection with your husband:-

1. The approximate date of departure by your husband from New Westminster.
2. His address whilst outside the protected area.
3. The period of his stay outside the protected area.
4. The date of his return.

We note that when you registered your assets with us on May 5th that you declared your husband was at that time in the New Westminster Hospital.

Although you have registered your assets with us, we do not appear to have any record of receiving your husband's registration. We are, therefore, enclosing three copies of our regular "J.P." Registration Form, and we ask that you be good enough to complete all three copies on behalf of your husband, thereafter to sign said statements on behalf of your husband, and then return two copies to us at the earliest possible date and retain the third copy for your own use.

The records we have on file indicate that the property known as 1327 Gibson Road, New Westminster, is registered in the name of your husband. We would appreciate your advising us whether or not our records are correct and whether you have any legal interest in the real estate mentioned above.

Yours truly,

R. P. Alexander,
Manager.

RPA:GF

13566 ✓
7706

25th November, 1942.

British Columbia Security Commission,
Marine Building,
Vancouver, B.C.

Dear Sirs:

re: Yasukichi GOTO, Reg. #12602.

Please refer to your letter dated October 20th, to which were attached two cheques covering wages earned by the individual mentioned above during the months of March and April, 1942.

Please be good enough to inform us by return mail as to the address of Mr. Goto during March and April whilst he was employed in the protected area, the services for which he received remuneration from the B.C. Security Commission.

Yours truly,

R. P. Alexander,
Manager.

RPA:GF

1327 Gilsen Rd.

R.R. #1 New Westminster
B.C.

Dec. 14th, 1942

OFFICE OF THE CUSTODIAN
JAPANESE SECTION

RECEIVED
DEC 16 1942

The Custodian of Japanese
Evacuee Property
Vancouver, B.C.

Dear Sir:-

Re: Late Mrs. Yasukichi (Miyoshi)

Regn. no. 12602

File no. 7706

Please find enclosed \$10.00 for rent
from Dec. 8th, 1942, to Jan. 7th, 1943.

Thank you!

13566

12603

Yours Truly,

Donald R. Hubbard.

GOTO, Miyoshi (Mrs. Yasukichi)

File # 7706

Reg. # 12602.

13566

December 21st, 1942.

Mr. Donald P. Hubbard,
1327 Gibson Road,
R. R. #1,
New Westminster, B. C.

Dear Sir:

Re: Yasukichi GOTO. #13566

Enclosed herewith please find your receipt for rent on the above Japanese property, December 8th, 1942, to January 7th, 1943. We wish to thank you for your co-operation in stating the Japanese name, registration number and file number with your remittance.

We would ask you to please note that, as the property is registered in the husband's name, you quote the new file number as stated above.

Yours truly,

R. D. Richardson,
Farm Department.

WEA/EM

SUCCESSION SECTION
 Rec'd JAN 18 1943
 Jan. 18 1943
 File No. 35 665 7706
 Ans. B. W. C.
 [Signature]

Dear Sirs,

I have ~~filled out~~ ^{filled out} my
 husbands, Registration Forms
 and sending 3 copies to you
 As you have asked me
 if I have any legal interest
 in my husbands property.
 I haven't any, except,
 before he left for the Road
 Camps, he had a Lawyer
 make his will, leaving
 everything to me & the children.
 Should anything happened
 to him.

We have rented the
 place to Mr D. Hubbard, with
 the agreement that he pay
 the taxes each year and
 \$10 a month rent starting

from November.

In a year we should
receive \$120, with that I
wonder if you could pay
our son's two Insurance
policy to the "Monarch Life
Assurance Company."

Kunji Goto

Policy No. P 114,895 Premium 105.90
" P 116,991 " 53.35

If you will we shall
be very grateful.

Yours truly,
Shizushi Goto.

1327 Sibley Rd R.R.#1.
New Westminster, B.C.

Jan 12th, 1943 ✓

Office of the Custodian,
506 Royal Bank Bldg,
Hastings & Granville
Vancouver, B.C.

EVACUATION SECTION	
Rec'd	JAN 13 1943
File No.	
Ans.	WJA
Referred	

Dear Sir:

Re: Yasakichi Goto, #13566
Enclosed herewith please find a
ten dollar (\$10.00) money order to cover rent from
January 8th to February 7th.

Yours Truly,

GOTO, Yasakichi

Date 13566 Reg 12603

Donald P. Hubbard.

J.P. K.

7706 and 13566.

January 27, 1943.

Mrs. Yasukichi (Miyoshi) GOTO,
Registration Number 12602,
Elocan, B. C.

Dear Madam:

With reference to property which I understand belongs to your husband and which includes a dwelling and other buildings, located on land described as being "Lot 113 of Lot 440, Group 2, Map 1133, Municipality of Delta, District of New Westminster".

This property you have leased to D. P. Hubbard and I wish to be advised if you made any arrangements with him as to carrying Fire Insurance protection. Information supplied by your husband indicates that no Fire Insurance has been carried. If no arrangement was made with the tenant, and if you should desire Fire Insurance carried, kindly indicate the amount that you need on the buildings that you wish covered, and also the amount that you wish carried on chattels, indicating also which buildings those chattels are stored in.

We will expect, of course, that the premium will be paid from revenue obtained from this property or that you would remit sufficient to take care of it. Please let us have your answer concerning this matter as early as possible.

I wish also to advise that your request to us to pay Life Insurance Premiums on your son's two policies is under consideration, and you will hear further from us in that respect.

Yours truly,

S. M. Gibson,
Insurance Department.

SMG:RAD

1327 S. 1st St.,
R.R.#1. New Westminster, B.C.
Feb. 3rd, 1943

Dept. of the Secretary of State
Office of the Comptroller
506 Royal Bank Bldg.
Hastings & Granville
Vancouver, B.C.

RECEIVED
Feb 5 1943
13566
Refer: Richardson

Anderson

Dear Sir:

Re: Isaac Kichi Ento; File no. 13566

I regret having to admit that as far as I have not paid the taxes. Not that I have been trying to dodge them. I simply haven't had the money to spare.

I won't be able to pay them for awhile because I came down with the mumps after Christmas and lost three weeks work.

Would it be possible for your department to pay the taxes and I pay you as soon as possible?

I am as anxious to have them paid as you are.

Yours Truly,

Donald P. Hubbard

13566
7706

3rd March, 1943.

*Letters from Ins. Co's
in file 7706*

Mrs. Miyoshi GOTO,
Registration No. 12602,
SLOCAN, B.C.

Dear Madam:-

Re: Life Insurance

Referring back to your letter of January 14th and to the last paragraph of ours to you of January 27th. I have made further inquiries in connection with life insurance covering on the lives of yourself and other members of your family. For your information I am enclosing copies of letters received from the Prudential Insurance Company, the Monarch Life Assurance Company and the Sun Life Assurance Company. Apparently there are the following policies:-

Prudential No. 6510717 for \$800.00 on the life of Miyoshi Goto, premium \$4.05 per month, paid to December, 1942;

Prudential No. E-6540354 - \$500.00, on the life of Miyoshi Goto, premium \$2.53 per month, paid to December, 1942.

\$19.74 is required to be paid on these two policies to bring them up to date -- March, 1943. These two premiums should be paid immediately to keep these two policies in good standing, if possible.

Monarch Life Policy No. P-116991 on the life of Teruji Goto, taken out June 8, 1941. First premium of \$105.90 paid. Face amount of policy - \$3500.00. Policy is lapsed and out of force because of non-payment of second premium due August, 6, 1942.

Monarch Life Policy No. P-117895 on the life of Teruji Goto, issued October 11, 1941. First premium of \$53.35 paid. Face amount of policy - \$1500.00. Policy is lapsed and out of force because of non-payment of premium due October 11, 1942.

Sun Life Policy No. 2,205,567 - Yasukichi Goto, issued December 1, 1935 - \$1000.00. Annual premium - \$53.45 (due December 1, 1942, still outstanding). There are dividends on deposit amounting to \$31.19 as at that date.

In your letter referred to previously you asked us, I believe, to pay the premium on your son's policies, that is the Monarch Life Policies, amounting to \$105.90 and \$53.35. To add to these amounts there would be

Interest to date as from the due date of the premiums and also the policies would have to be reinstated.

In checking up in the office we find that your husband, Yasukichi Goto (File 13566) has a credit balance of \$40.72 as at today's date, so that you can see that there is far from enough to meet the premiums as requested. First of all, I would suggest that you have us pay the premiums on your Prudential Policies which I mentioned above would take \$19.74 to bring them up to date as at March, 1943. We can do that for you if you so desire.

Waiting to hear from you in the near future, we are

Yours very truly,

S. M. Gibson,
Insurance Department

ENCLOSURE

Enc.

New Westminster, B.C.

R.R. # 1. 1327 Eileen Rd

R.D. Richardson, Farm Dept.

Dept. of the Sec. of State

Office of the Custodian

506 Royal Bank Bldg

Hasting & Granville, Vancouver B.C.

EVACUATION	FILE
Rec. MAR 5 1943	
File No. 13566	
Ans.	
Referred	Richardson

Dear Sir:

File # 13566 Re: Yasukichi Ito.

I would appreciate it very much if you would send me the tax notice for this place.

I am also interested in buying this place and would be willing to pay \$1500.00 if terms could be arranged. Would you please let me know when you receive full instructions regarding the disposal of Japanese real estate.

Yours Truly,

Donald P. Hubbard.

New Westminster, B.C. RR#1
1327 Gibson Rd.
March 11th, 1943

Mr. H.D. Richardson
Office of the Custodian
806 Royal Bank Bldg
Hastings & Granville
Vancouver, B.C.

EVACUATION SECTION	
Rec'd	MAR 13 1943
File No.	
Ans.	
Referred	Richardson

Dear Sir:

Re: Igarashi Goto, File # 13566.
Please find enclosed a ten dollar
(\$10.00) money order for the March 8th to
April 7th, rent.

Yours Truly,

Donald P. Hubbard.

Goto, Igarashi
File 13566 Reg 12603
Mar 8 apr 7/43.



DEPARTMENT OF THE PROVINCIAL SECRETARY
COLLECTOR OF INSTITUTIONAL REVENUE

EVACUATION SECTION	
MAILED	MAY 19 1943
FILE NO.	3566
REFERRED	<i>Re: Goto</i>

COURT-HOUSE
800 GEORGIA STREET WEST
VANCOUVER, B.C.
TELEPHONE: MAIN 5141

File No. 68

May 18, 1943

Office of the Custodian,
Japanese Evacuation Section,
Royal Bank Building,
Vancouver, B. C.

Dear Sirs:

Re GOTO, Yasukichi - aged 40
#20,035. Married
Provincial Mental Hospital

The above-named patient was committed
to the Provincial Mental Hospital on April 28, 1942
and still a patient.

He has a wife, Miyoshi Goto, and a
daughter, Naoe Goto. He was a poultry farmer prior
to his admittance to hospital.

The patient was committed to the Mental
Hospital under authority of the British Columbia
Security Commission. Further information may be
had from C. G. McNeil, Secretary, British Columbia
Security Commission, Vancouver, B. C.

Yours very truly,

J. G. McRae
J. G. McRae,
Collector.

M/MP

R.R. #1. New Westminster B.C.
1327 Gibson Rd.
May 30th, 1943

The Custodians Office
Dept. of the Secretary of State
of Canada
Vancouver, B.C.

EVACUATION SECTION	
Rec'd	MAY 31 1943
File No.	13566
Ans.	
Referred	Anderson

aut

Dear Sir:- Re: Yasukichi Goto, #13566

The following is a bill for the
removal of old shingles and the re-shingling
of kitchen roof size $17\frac{1}{2}$ ft x 21 ft.

Shingles
Labour

Total

\$14.75
12.00

26.75

I would be very pleased if you
would make remittance immediately as
the money is urgently needed.

Thank you.

Yours Sincerely

Donald P. Hubbard.

13566

3rd June, 1943.

Mr. Donald P. Hubbard,
1327 Gibson Road,
R.R. #1,
New Westminster, B.C.

Dear Sir:

re: Yasukichi GOTO.

We are in receipt of your letter of May 30th and also receipt from the Valley Lumber Yards for purchase of shingles in the amount of \$14.75.

In the statement embodied in your letter regarding repairs to the roof of the house, there is a charge of \$12.00 for labour in addition to the cost of shingles. Kindly advise us if this applies to you or to outside help. If the latter, we ask that you send us a receipt and your account will be given due consideration.

We would point out that you omitted to notify us about this work, and as it is customary to have any work or repairs to houses on any property authorized by the owner or his representative we trust you will bear this in mind in future.

Yours truly,

R. D. Richardson,
Farm Department.

WEA:GF

CANADA
DEPARTMENT OF THE SECRETARY OF STATE
OFFICE OF THE CUSTODIAN
JAPANESE EVACUATION SECTION

PHONE PACIFIC 6121

PLEASE REFER TO
FILE NO. 13566

808 ROYAL BANK BLDG.,
HASTINGS AND GRANVILLE
VANCOUVER, B.C.

8th June, 1943.

Mr. Donald P. Hubbard,
1327 Gibson Road,
R.R. #1,
New Westminster, B.C.

Dear Sir:

re: Yasukichi GOTO.

We enclose herewith our cheque in the amount
of \$26.75, being payment in full of your claim against
subject Japanese for repairs to the roof of his house.
Kindly acknowledge receipt of this remittance.

Yours truly,

R. D. Richardson

R. D. Richardson,
Farm Department

WEA:GF

Encl:

*New Westminster, B.C. R.R. #1
1327 Gibson Rd.
June 10th, 1943*

*Dear Sir: Cheque for \$26.75 received.
Thank you!
Yours Sincerely,
Donald P. Hubbard.*

EVACUATION SECTION	
Rec'd	JUN 14 1943
File No.	<i>W</i>
Ans.	<i>W</i>
Referred	<i>Anderson</i>

R.R. #1. New Westminster, B.C.
1327 Gibson Rd.

July 14th, 1943

The Custodian of Japanese
Property
Mr. C. H. Reed

EVACUATION SECTION	
Rec'd. JUL 16 1943	
File No.	
Ans.	
Referred	

Dear Sir -

Re: Goto Yasukichi
Regn. no. 12603 File no. 13566

Enclosed please find a money order
for twelve dollars and fifty cents (\$12.50)
to cover rent from June 9th to July 8th.

Thank you!

Yours Truly,

GOTO, Yasukichi

13566/12603

Donald T. Hubbard

Paid June 9 - July 8/43 10⁰⁰
on a/c - Taxes 2⁵⁰

1327 Gibson Rd.
R.R.#1 New Westminster, B.C.
July 23rd, 1943

The Custodian of
Japanese Evacuee Property
Vancouver Office.

EVACUATION SECTION	
Rec'd	JUL 24 1943
File No.	
Ans.	
Referred	

M.C. Smith, Cashier:
Dear Sir:

Re: Goto Yasukichi, file no. 13566

Please find enclosed the sum of
\$12.50 to cover rent from July 9th
to Aug 9th and taxes.

Thank you,

Yours sincerely

m/o - 12th

Donald P. Hubbard

GOTO, Yasukichi
13566/12603

Rent July 10 to Aug 9 - 10.00
prop taxes 2.50
22.50

13566 & 7706

July 5, 1945.

Mr. Donald P. Hubbard,
1327 Gibson Road,
R. R. #1,
New Westminster, B. C.

Dear Sir:

Re: Yasukichi GOTO, #12603

While reconciling the liquidation of chattels left on subject Japanese property, under lease to you, we find that, according to our inventory, four electric brooders were left in your care.

Our fieldman removed the chattels to auction in March. We note, however, that only one brooder is accounted for. Please advise as soon as possible the whereabouts of the three missing brooders.

Yours truly,

WEA/TH

W. E. Anderson,
Farm Department.

1 - 2nd App. H. H. H.
2 - 1st App. H. H. H.
2 - 2nd App. H. H. H.

1327 Eithon Rd

K.R.#1. New Westminster, B.C.

July 9th, 1945

EVACUATION SECTION	
Rec'd	JUL 11 1945
File No.	1-2566
Ans.	
Referred	Anderson

H.C. Anderson

Farm Department,

506 Royal Bank Bldg.

Hastings & Granville, Vancouver, B.C.

with Mrs. D. H. H.

Re: -

Re: Ysukichi Eto, #12603

Mr. W. Page of Brackman-Ker Milling Co. Ltd., New Westminster, B.C. gave authority to loan two brooders to the following persons:

On 10th day of May 1943 to J. Luker, one only Snyder Brooder. supposed to have been returned at end of season but was not.

On 28th day of May 1943 to George M. Blackman gravel Rd, K.R.#2, one only Jansway brood, not working.

On Jan 22nd 1945 one electric brooder removed by H.C. Anderson, Custodian agent.

I bought one Jansway brooder when details were removed for auction in March.

enclosed at
Jansway

Yours Sincerely

Donald P. Hubbard

ESTABLISHED 1878

INCORPORATED 1888

THE BRACKMAN-KER MILLING CO. LIMITED

BRANCHES AT
NEW WESTMINSTER, VANCOUVER, VICTORIA,
CHILLIWACK, ROSEDALE, SARDIS, ABBOTSFORD,
LANGLEY PRARIE, CLOVERDALE, HANEY,
COQUITLAM, LADNER, BRIDGEMOUNT, NANAIMO,
COURTENAY, PORT ALBERN, NELSON,
ROSSLAND.



CABLE ADDRESS: "BRACKMAN"
DOWLING'S GRAIN CODE
BENTLEY'S CODE

HEAD OFFICE:
P.O. BOX 920
NEW WESTMINSTER, B.C.

DISTRIBUTORS OF
PURITY FLOUR

Box 920,
New Westminster, B.C.
Sept. 19th. 1945.

Office of the Custodian,
Japanese Evacuation Section,
506 Royal Bank Building,
Vancouver, B.C.

Attn. W. Anderson.

Dear Sirs,

I am remitting \$5.00 less 10% commission for rent
collected on Brooder owned by Y. Goto, #13566.

The Brooder is now stored at our Langley Prairie
Branch and will be disposed of as soon as possible. Also
there is another Brooder belonging to this party which is
stored at one of our customers and will be disposed of as
soon as possible.

Yours truly,

GOTO, YASUKICHI, File 13566/12603

W. Page

*Credited to Mrs Goto
for 7706. 18th March 46
JA*

7706
13566

March 16th, 1946.

Mrs. Yasukichi (Miyoshi) GOTO,
Registration No. 12602,
Slocan, B. C.

Dear Madam:

We thank you for your letter of March 11th, 1946 and in reply may say that the property in Delta registered in the name of your husband was sold to the Director, Veterans Land Act some time ago and the sales proceeds were placed to the credit of his account.

The personal chattels registered with the Custodian by your husband and yourself have as far as possible been recovered and sold at auction in accordance with the Federal Government's provisions. The sales proceeds, \$64.59 in this instance have been credited to the respective accounts of your husband and yourself according with the declaration on our file. Very shortly we shall forward you a summary of your affairs coming under our administration.

Yours truly,

W. J. Iverson,
Protection Dept.

WJI:DP

7706
13566

May 31st, 1946.

Mrs. Yasukichi (Miyoshi) GOTO,
Reg. No. 12602,
Shosan, B. C.

Dear Madam:

Referring to your letter of April 27th, 1946 and in reply we may advise that the amount given in our letter of March 16th, 1946 was correct. All saleable effects removed from your husband's former residence on Gibson Road, Delta were either sold at public auction or sold on a private sale. The electric pump however, was not sold as it was a fixture on the property.

In view of the fact however, that your husband declared the incubators, brooders and the farm implements, the proceeds from the sale of these will be credited to his account. The sum of \$24.90 which is that part of the sales proceeds representing the household goods and furniture can be remitted to you upon application.

The camera you refer to can be mailed to you if you forward the R. C. M. P. receipt and 25¢ for postage.

Yours truly,

W. J. Iverson,
Protection Dept.

WJI:DP

W706 & 13566

18th March, 1947.

Mrs. Miyoshi GOTO,
Registration No. 12632
c/o Mr. Frank Purvis,
R.R. No. 6,
Chatham, Ontario.

Dear Madam:

Some time ago you requested that we send to you your autographic Kodak which was placed in safe-keeping with the Custodian. At that time we asked that you send the receipt given you at the time you surrendered it.

As we have not received this receipt we are assuming that you have lost it, and are therefore attaching hereto a statement, which we would appreciate you signing in front of a witness, to the effect that the camera is yours but the receipt is lost.

Upon receipt of this duly signed document, your camera will be forwarded to you.

Yours truly,

W.E. Anderson,
Office of the Custodian.

WEA:HA
Encl.

MEMORANDUM

File Nos. 7706 & 13566

25th June, 1947.

Re: Miyoshi GOTO (Mrs. Yasukichi) - Reg. No. 12602
Yasukichi GOTO - Reg. No. 12603

TO: Miss C. Girard

FROM: W.E. Anderson

An electric brooder was sold by appraisal for \$20.00 to the tenant on Yasukichi GOTO's property, D.P. Hubbard, at the same time some goods were appraised by Trapp Motors Ltd. and sold to the tenant on Shoyemon TAKAHASHI's property, W. Houchen (File 8620).

The net proceeds of \$18.00 was transferred to Yasukichi GOTO's account, File 13566, on the 30th January, 1946, but as all chattels are being handled on Mrs. GOTO's file, No. 7706, please transfer this amount to her.

HA

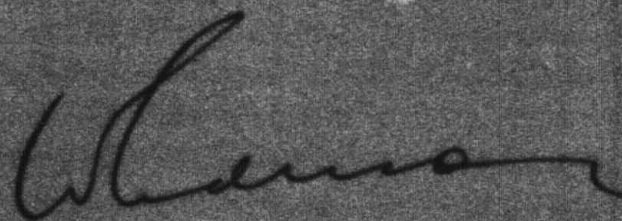

Accounting Department:

Charge to File 13566 and credit to File 7706 - 1 electric brooder	\$20.00
Less appraisal:	<u>2.00</u>
	\$18.00

Transferred to 13566 on January 30, 1946.

Transferred, July 14, 1947.

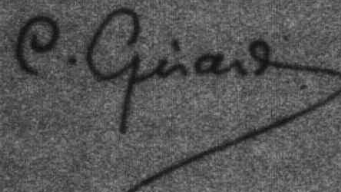

13566

July 21, 1947.

Mrs. Miyoshi GOTO,
Reg. No. 12602,
c/o Mr. Frank Purvis,
R. N. #6,
Chatham, Ontario.

Dear Madam:

This is to inform you that the No. 3A Autographic
Kodak Model C camera, which you surrendered to the police, was
sent to you on July 18th by insured parcel post.

If this parcel does not reach you within the next
few days, please let us know in order that we may have the shipment
traced through the Post Office.

Yours truly,

F. Matheson,
Office of the Custodian.

FM/fa

August 2, 1949.

Gordon S. Wismer, Esq., K.C.,
Attorney-General of British Columbia,
Legislative Buildings,
Victoria, B. C.

Dear Sir:

Re: Yasukichi Goto, Essondale, B. C.

We wish to inform you that the above-named Japanese national (born March 27, 1898) is reported to have been confined in the Essondale Mental Hospital on April 28, 1942, while under the control of the B. C. Security Commission.

Proceeds from sale of property belonging to Yasukichi Goto which vested in the Custodian at the time of the Evacuation amount to \$570.84. We understand that the circumstances require that this money be turned over to the Attorney General for administration and we are therefore enclosing Custodian cheque No. 7519 for \$570.84, together with a statement showing how this sum is made up.

This office has no knowledge of debts owing by this man nor is aware of other assets, with the possible exception of Sun Life Assurance Policy No. 2205567 which did not come under the control of the Custodian and concerning which no action has been taken.

Royal Canadian Mounted Police Records obtained at the time of the Evacuation give this man's family as follows:

Wife - Miyoshi Goto
Sons - Tekuji (born Jan. 26, 1927)
Daughters - Yaeki, Mrs. Shigeru Nakamura,
Tosako (born Dec. 9, 1928)
Sakae (born May 4, 1931)
Masayo (born July 28, 1934)

The last address (1948) known for Mrs. Goto is 167 Duchess Street, Toronto, Ontario. If required, a more up-to-date address might be obtained from R. A. Best, Esq., Barrister and Solicitor, 15 Toronto Street, Toronto, Ontario. Mr. Best filed a claim for Mrs. Goto against the Canadian Government, relative to the sale price of her husband's Real Property. The property referred to was one of a large group of Fraser Valley farms valued by the Soldier Settlement Board appraisers

Gordon S. Wisner, Esq., K.C.

August 2, 1949.

and sold to the Director, Veterans' Land Act, in 1943. This claim is still before the Commissioner, Mr. Justice Bird, and if an award is made the funds should accrue to Yasuichi Goto's Estate in your hands.

Would you kindly acknowledge receipt of the enclosed cheque.

Yours very truly,

A. G. McArthur,
Office of the Custodian.

AGM/AG

Enc. cheque \$570.84

File No. 13966
Reg. No. 12603

Debit and Credit

	Debit	Credit	Balance
1942			
Mar. 24		\$ 1.72	
Dec. 24		10.00	
Dec. 16		10.00	
1943			
Jan. 1		965.12	
	\$ 1.00		
	15.00		
1944			
Apr. 23			
	\$ 16.00	\$ 966.84	
			CR \$ 970.84

September 1, 1948.



DEPARTMENT OF THE PROVINCIAL SECRETARY
COLLECTOR OF INSTITUTIONAL REVENUE

COURT-HOUSE,
800 GEORGIA STREET WEST,
VANCOUVER, B.C.
TELEPHONE: MARINE 5141

January 23, 1951

Attention: E.J. McMaster.

Messrs. Campbell, Brazier, Fisher,
McMaster & Johnson,
Barristers & Solicitors,
675 West Hastings Street,
Vancouver, B. C.

microfilm

Dear Sir:

Re: Yasukichi Goto - Provincial
Mental Hospital
Your file, Japanese Property
Claims Commission #1160

Further to your letter of December 11th
and our reply of December 18th in connection with the above
named, please be advised that this case was presented to the
Assessment Committee for consideration at the meeting held
January 18th last.

I am instructed to advise you that members of
the Committee recommended that the payment of \$853.10 awarded
by the Japanese Property Claims Commission be paid to the wife
of the above named patient.

Yours very truly,

A. Dean
A. Dean,
Collector.

rlw
c.c. PMH
c.c. I. of M.

February 8, 1951.

Mr. McMaster phoned today re this case. He advises that the Attorney-General may be objecting to payment to Mr. Goto. Mr. McMaster is taking this matter up and for the time being the award is not to be paid.

F. G. Shears.

INSPECTOR OF MUNICIPALITIES
Province of British Columbia

Dominion Bank Building,
Victoria,

February 20, 1951.

C
O
P
Y

Messrs. Campbell, Brazier,
Fisher, McMaster & Johnson,
Barristers and Solicitors,
The Royal Bank Building,
675 West Hastings Street,
Vancouver, B. C.

Dear Sir:

Re: Estate of Yasukichi Goto,
Property Claim Commission Case 1160.

I have for acknowledgment your letter of February 8th,
the contents of which have been carefully noted.

It is noted that in order to obtain the release of the
award it will be necessary for the Attorney-General to provide
the Custodian with a release of any claim against the Dominion
Government, and/or the Custodian with respect to the property
of the said patient. Such a release should be drawn in the
name of the Attorney-General as Committee of the Estate of
Yasukichi Goto and forwarded to this office for further attention.

Yours truly,

"B.C. BRACEWELL"

B. C. Bracewell,
Inspector of Municipalities.

RJM/EC

Transcript 9070

File No. 13566
Reg. No. 13603

		Debit	Credit	Balance
1942				
Nov. 24	B. G. Security wages for March & April 1942		\$ 1.72	
Dec. 14	H. D. Hubbard - rent for November		10.00	
Dec. 16	H. D. Hubbard - rent for December		10.00	
1943			565.12	
Jan. 1	Credit re Sale of Property	\$ 1.00		
	Land Registry Office 6/8			
1945				
Apr. 23	Legal Fees - V. L. A.	15.00		
		\$ 16.00	\$ 506.84	
				CR \$ 570.84

/s/ September 1, 1945.

Canada

**DEPARTMENT OF THE SECRETARY OF STATE
OFFICE OF THE CUSTODIAN**

JAPANESE EVACUATION SECTION

File No. 13566

Reg. No. 12603

506 Royal Bank Building,
Vancouver, B. C.Mr. Yasukichi GOTO,
Mental Hospital,
Esquimalt, B. C.

MAY - 9 1944

Dear Sir:

Re: Gilham Road, New Westminster, B. C.
Municipality of Delta, Lot 113 of Lot 440, Gr. 2, Map
1133, District of New Westminster, C. of B. 50880.

You have previously been advised that a sale of lands in rural districts was entered into between this Department and The Director, The Veterans' Land Act.

Due to the size of this transaction, the arrangements for same and the completion of the transfer have taken a considerable time. Negotiations were started in the early part of 1943 and were based upon valuations made by qualified appraisers and on the basis of a sale effective as at January 1st of that year. This means that the 1943 revenues from the property were for the benefit of the purchasers, but that taxes, fire insurance and other operating charges were assumed by them.

The following is a statement showing the sale price and adjustments:

Sale price of above described property	\$ 587.00
Add:	
Unexpired insurance premium as at January 1st, 1943	587.00
Less:	
Tax arrears to December 31st, 1942	18.88
Registration fee	3.00
Encumbrance—Principal	
—Interest	21.88
Net proceeds of sale	\$ 565.12

This amount has been placed to your credit and a statement of your account is endorsed hereon showing the present balance on our books. A small amount for legal fees in connection with the conveyance to the Veterans' land will be charged later.

Yours truly,

F. G. SHEARS,
Director.

W

MEMORANDUM.13566
File #7706Lessor: Miyoshi OTO. *(wife)*Lessee: Donald Palmer HUBBARD.Date: 8th June, 1942. *(12 months)*Term: 8th June, 1942.Consideration: \$120.00, \$50.00 paid in advance 8th June, 1942,
and balance of \$70.00 payable at rate of \$10.
monthly from 8th November. No Taxes.Property:Land: Lot 113, Subdivision of Sec. 25 & 36, Tp. 4, Map 1133,
Municipality of Delta, N.W.D.House: Included.Chattels: All tools, equipment and household articles
left on property. *no schedule of chattels
in lease*

*Replaced by Lease # 522 to DP Hubbard
10⁰⁰ months plus 2.50 months on 7c
for 1942 2/3/4.*

*Lease given to
8th Aug 1943
See file 7706 for chattels*

Extract from Lease.

Lease No. 522.

File No. 13566.

Lessor: Yasukichi GOTO.

Lessee: Donald P. HUBBARD.

Date: 13th May, 1943.

Term: 1 year and 207 days from 8th June, 1943 to 31st December, 1944.

Consideration: \$188.00, payable \$10.00 monthly for 18 months commencing 8th July, 1943, and final payment of \$8.00 on December 8th, 1944. In addition \$2.50 per month for taxes for years 1942, 1943 & 1944.

Property:

Land: Lot 113 of Lot 440, Gp. 2, Map 1133 (Gibson Road), C. of T. 82556 E.
Municipality of Delta.

Buildings: Included. Space reserved for storing chattels.

Chattels: Not included.

Lease handed to S.S.B. 29/7/43.

ANALYSIS OF REAL PROPERTY CLAIM

CLAIMANT: Yasukichi GOTO

Reg. No. 12603

File No. 13566

(Note: Miyoshi GOTO, wife of Yasukichi GOTO, has filed claim through R. A. Best, Solicitor, of Toronto, as her husband has been confined to the Provincial Mental Hospital, British Columbia, since April 28, 1942. See letter of May 18, 1943 on Claim File).

SUBJECT
of CLAIM:

Lot 113 of Lot 440 Group 2 Map 1133 Municipality of Delta in the District of New Westminster.

ASSESSED
VALUE,
1943:

Land	- \$ 261.00	
Improvements	- 1500.00	- Total Assessment \$1761.00.

V. L. A. - First Offer.

APPRAISAL - \$598.05 by V. L. A., July 29, 1942.

TENDERS - None other than V. L. A. First Offer.

SOLD - \$587.00, to V. L. A. as at January 1st, 1943.

<u>CLAIM</u> - Claimants estimated value of Land	- \$1125.00	
Claimants estimated value of Buildings	- 3975.00	- \$5100.00
Less amount at which above property was sold		- 587.00
		<u>\$4513.00</u>

/s/
September 1st, 1948.

W. J. Hunter

Name of Claimant
Custodian File

GOTO, Yasukichi

Case

1140

18566

REAL PROPERTY										Total
Greater Vancouver		Rural (except V.L.A.)			V.L.A. (except Mission Village)		V.L.A. Mission Village		Total	
Sale Price	5% thereof & 12.50	Sale Price	10% thereof	Charges 12.50 & Comm.	Sale Price	Total Award 80% of all Sale Prices % of Amount Total	Sale Price	Total Award 125% of all Sale Prices % of Amount Total		
					227.	730.30				115.00 730.30
PERSONAL PROPERTY										
Motor Vehicles		Boats and Boat Gear								
Sale Price	25% thereof	Sale Price	Nelson Bros. 23.5% of Sale Price	Other Sales 28.5% of Sale Price	Equipment charges paid to purchasers in error. Repay to owners	Amount of Claims for Boat Gear Declared & Not Found & Recorded Now Missing	45% of amount in next preceding column			
NETS										
Total award for Nets plus Sale Price	Total Claim for Nets Sold, Declared Not Found and Recorded Now Missing	Percentage Total Award to Total Claim	Claim for Nets Sold Declared Not Found, & Recorded Now Missing	Apply % ratio to Claim	Deduct Custodian Sale Price					
MISCELLANEOUS CHATTELS										
Claim for goods Sold By Auction	Sale Price of Goods Sold By Auction	Rebates of charges 30% of Sale Price	Ratio in % of Sale Price to Claim	Claim for goods Declared Not Found, Recorded Now Missing, & Sold Not Paid	Application of % ratio to amount in next preceding column	Sale Price of goods Sold by Tender	12% of Sale Price			
TOTAL RECOMMENDATION										683.10

13566

February 20th, 1951

Mrs. Miyoshi GOTO,
103 Woodcrest Ave.,
Toronto, Ontario.

Dear Sir:

Re: Japanese Property Claims Commission

Case No. 1160

We have received from the Co-Operative Committee
on Japanese Canadians, our form of Release which has been
executed by yourself covering the award recommended under
the above Claims Commission for the sum of ... \$ 853.10.

Cheque in your favour is enclosed for \$ 752.75
and we have paid the Co-Operative Committee .. \$ 100.35
for legal fees as authorized by you.

Yours truly,

F.G. Shears
Director

FGS:BK
Encl.

13566

March 15, 1951.

Mr. B. G. Bracewell,
Inspector of Municipalities,
Dominion Bank Building,
Victoria, B.C.

Dear Sir:

Re: Estate of Yasukichi Goto - Case 1160
Japanese Property Claims Commission

Your letter of February 20th to Messrs. Campbell, Brasier & Co. was handed to us for attention by Mr. McMaster of that firm.

In view of a letter dated January 23rd from the Collector of Institutional Revenue, advising that members of the Committee recommended that payment of the Commission Award could be made to Mrs. Goto, our Form of Release was prepared for her signature. This had been mailed to her before your letter referred to above was received.

It was our intention to withhold payment until this matter had been cleared by the Attorney General, but we very much regret that through inadvertence, upon the return of our Release form properly executed by Mrs. Goto, our cheque for \$853.10 was sent to her. We have enquired at our bank but find this cheque has already been cashed, so that we are unable to stop payment.

If the recommendation of the Committee would have been adopted by the Attorney General as we assume might have been the case in the present circumstances, we are suggesting that perhaps it would be in order for your file and ours in regard to this matter to be considered closed.

Your co-operation will be appreciated.

Yours very truly,

F. G. Shears,
Director.

FOS/GH

Form A 23

DEFENSE BRIEF

Yasukichi GOTO.

File No. 13566

Case No. 1160

Toronto, Ontario.
October 22, 1948.

REAL PROPERTY CLAIM

(All Claims shown are Gross)

Legal Description: Lot 113 of Lot 440 Group 2 Map 1133 Mun. of Delta in the District of New Westminster.

Real Property
Claim
\$5100.00

Appraisal
\$598.05

Sale Price
\$587.00

Witness: D. Dodding (Soldier Settlement Board appraiser)

Ref. (1): Exhibit 1 states that claimant had $\frac{1}{4}$ acre of strawberries and a $\frac{1}{4}$ acre of currants and gooseberries.

Farm appraisal report states that .89 acres was cropped with "Mixed Garden".

(In Trans. 6, Lines 6-8, the son states there were also raspberries included in above crops).

(2) Exhibit 1 states the property was purchased in 1929 as "all bush land", and states that the buildings were erected in 1929, 1933, 1935, 1937 and 1940.

Farm appraisal report (Ex. 2) gives the ages of the various buildings as 20, 15, 10 and 5 years old at the time the appraisal report was prepared, namely, August 1942.

SUBMISSION: Trans. 11, Lines 12 & 13
"It is submitted, your honour, that the real property was sold at its fair market value".

Summary of Defense
Witnesses

Where Required

Documents to be
filed

Witness
Proving Same

D. Dodding - appraiser

/s/
Feb. 16/49.

IN THE MATTER OF THE "INDIAN ACT"
AND THE INDIAN ACT OF CANADA 1877, CHAPTER 22.

ALABAMA PROPERTY CLAIM COMMISSION

REPORT

WAS DONE, JOHN J. WILSON, SUB-COMMISSIONER.

Turkey, Ontario,

October 22, 1888.

IN THE MATTER OF THE CLAIM OF
WILSON, AND

WILSON, AND

ALABAMA

J. A. WILSON, JR., Esq.,

appearing for the
Dominion Government,

J. A. WILSON, Esq.,

appearing for the
Claimant,

J. A. WILSON, Esq.,

Secretary,

J. A. WILSON, Esq.,

Official Interpreter,

J. A. WILSON, Esq.,

Official Reporter.

Mr. E. G. Goff,
Att. Gen.

Q. Apparently your husband bought this property when it was vacant land from the municipality of Dallas as a tax sale, for \$207.50?

A. Yes.

Q. Do you remember that? A. Yes.

THE SUB-COMMISSIONER: \$207.50?

MR. HUNT: Yes. It was bought at a tax sale from the Municipality of Dallas. Immediately after the purchase of the land apparently your husband built the house on the property. Is that correct?

A. After he had cleared away the brush he built the house.

Q. I see. Of the five acres apparently three and one-half acres are cleared now. Is that correct?

A. Yes.

Q. Did your husband do all of that clearing, himself, or did he hire someone else to do it?

A. He was working at the sawmill and he got other people to help him.

Q. I see. And, did other persons do this ditching and digging of the well, too?

A. Yes.

Q. Apparently your husband built the house entirely himself?

A. He built it himself with the aid of outside people.

Q. And he operated this property as a poultry farm, I understand? A. Yes.

MR. CHRISTIAN: I am tendering as Exhibit A the

Mr. E. J. 1000,
112, 112.

Now Appraisal Report.

Now Appraisal Report, MARKED EXHIBIT 10-11

Q. In respect of these various buildings in which your husband kept his poultry, I notice there is one large one built in 1940. Would that be one measuring 30 by 40, a feed house and a large chicken house, both built in 1940 and apparently in the year your husband did not do any work at it - I am wrong? He paid \$150, I am right in each of those instances? And you tell us who helped him build those buildings?

A. They were built by outside help.

Q. Your house was a chicken house?

A. Six rooms and the kitchen, which would make seven rooms.

Q. How many people lived in the house?

A. Seven people in the house.

Q. Well, now, Mrs. Gato, apparently you had some strawberries and raspberries and gooseberries on this property as well as your chicken-run. Is that correct?

A. Yes; and some raspberries.

Q. Would they be included in the mixed garden which according to the appraisal occupied a little less than an acre? Apparently they must have been. There is no mention of them on the appraisal. How many strawberries and raspberries and gooseberries did you have?

A. I am not certain about things of that sort. There were not too many.

Q. Now, I think the only way to able to give us more assistance in these matters, your

Mr. J. G. Gable,
M.P. No. 1 - 11.00.

Witness:

THE WITNESS: We had a lot of witnesses.

Q. I think perhaps that is all I want to ask
you, Mr. Gable.

I will call the son on the next witness.

EXAMINATION BY MR. CHRISTIE:

Q. I show you a J.P. form dated December 13,
1942. Does signature is that? A. I do not
know.

Q. We will ask the son. You do not know your
husband's signature? A. Is that what you want
us to discuss?

Q. Would you know your husband's signature?
THE SON-CHRISTIE: Q. Is that your husband's
signature? A. If that is the case it was signed
by my daughter.

MR. CHRISTIE: I think perhaps there is no use
in pursuing my questions with the witness if the son
is going to be put into the witness box.

All right, witness, that is all.

THE SON-CHRISTIE: Being first duly sworn,
deposited as follows:

EXAMINATION BY MR. GABLE:

Q. Now, you are the son of the claimant?
A. That is right, sir.
Q. And I take it you lived on this property

T. Sato,
Mr. Q.

Q. Now, the time you were arrested?

A. That is right.

Q. Well now, what have you to say about these
circumstances and circumstances and so on? Can you
give us some estimate of just how many there were?

A. Well, there must have been about half an
acre of strawberries, the rest gooseberries, currants
and raspberries. There could not be more than that.
There must have been about half an acre of them, too,
that is, probably.

Q. Building?

A. Yes, that is, building.

Q. Now, speaking up, please, witness,
do we say that you?

MR. SHER: Q. Well now, according to the claim
your house was built in 1940 which, at the time of the
appraisal, August 1, 1944, would make it 15 years old.
The appraisal apparently estimates the house at 20
years. I take it you knew the house was built in 1920?

A. That is right.

Q. And in respect of this shed shed, for
instance, according to the claim it was built in 1943,
together with one large house 20 by 30. Do you
know as a fact that they were built in 1940?

A. Yes.

Q. So that I take it you are saying that
the estimate of their age at 5 and 15 years in the
appraisal is wrong, are you? A. Yes.

Q. Can you tell us the names of any persons
who helped your father build some of these houses?

T. J. J. J.
Mr. J.

1. There was no money and animals and carrying equipment.

2. Your father operated this as a poultry farm as a business?

A. That is right.

Mr.

3. That was his job? A. Yes, Mr.

4. And, apparently there were seven of you in the family, your mother and father and five children?

A. No. There were eight. My mother was born into a family. She began to include herself, and finally.

5. And, were any of you old enough to assist in running this poultry business, or did you have other jobs? A. We were assisting, my two older sisters and myself and mother working at it, Mr.

6. Can you tell us how many hens you had prior to conversion?

A. I think we had about 1,000 hens.

7. How many chickens? How many?

A. About 1,000 hens. We used to get 1,000 yearly, that is, pullets and we would sell all the hens and keep the pullets.

8. How?

A. That was an annual procedure.

9. Yes.

10. To start about 1,000 pullets per year, sell the older birds off?

A. Yes.

11. Could you estimate for us what you think



T. Goto,
Mr. G.

8

1 your father's income from this business was T. Goto,

2 A. No, I do not think I could. Because you

3 were... Q. On the appraisal there is a mention under

4 water supply of two wells said to be of doubtful supply.

5 What have you to say about the water supply on this

6 property? A. Well, on our property it was except-

7 ionally good compared to the neighbours'. I never

8 went dry.

9 Q. But some of the neighbouring wells did go

10 dry? A. Yes.

11 Q. I see. Was there any particular reason

12 for that, that your wells were better than your neigh-

13 bours' or do you know? A. Well, I would say

14 the neighbours had greater consumption. You see, we

15 did not carry as many hens as our neighbours did.

16 Q. Your immediate neighbours were poultry

17 raisers, too? A. Yes.

18 Q. Did the wells ever go dry in the middle

19 of the summer on your property?

20 A. No.

21 Q. You mention something about an electric

22 water pump. Was that left on the premises and sold

23 with the house, do you know?

24 A. According to the letter from the Custodian,

25 yes. Q. He was in 1942? A. Yes.

26 Q. I see. When did you and your parents leave

27 this property? A. In June, 1942.

28 Q. In June? A. Yes.

29 Q. I see. And, according to the appraisal,

30 which was made at the end of July, apparently you did

Q. I want to show you a diagram of this place.

It is on page four of the Farm Appraisal Report; then would you indicate now where the strawberries were?

A. We had our strawberries up around here and down here (indicating).

Q. You had strawberries in the part known as "mixed garden"? A. Yes.

Q. And, where were the gooseberries? A. The gooseberries were up around here (indicating).

Q. In the same part? A. Running from around here right around here (indicating).

Q. The gooseberries were partly in the area known as the mixed garden and also near the sheds? A. That is right, sir.

Q. And this house a basement? A. No, sir.

Q. And, was it on posts? A. That is right, sir.

Q. And, of what kind of lumber was it made? A. Yes. The outside was siding.

Q. The outside was siding? A. Yes.

Q. And, how was it heated? A. I guess with what you call quaked heaters.

Q. Stoves? A. Yes.

Q. Did you have any fences on this property? A. Yes, we did.

Q. That is where the poultry house was, I suppose. Were the poultry runs enclosed by fences? A. Yes.

